



Flat 5, Fernlea Gardens Straight Bit, Flackwell Heath

£435,000



Flat 5

Fernlea Gardens Straight Bit, High Wycombe

A superbly appointed first floor apartment in this highly sought after development which is located within a few minutes walk of the village centre. Entrance hall, Sitting room with balcony, Kitchen, Bedroom 1 with en suite shower room, Second bedroom, Bathroom, Underfloor heating, Double glazing, Communal gardens, Two allocated parking space plus visitors parking area, Communal lift. NO CHAIN.

Council Tax band: D

Tenure: Leasehold

Entrance hall

Security entryphone, built in shelved storage cupboard with fuses and electric meter, airing cupboard housing Megaflo hot water cylinder and shelved storage

Sitting room/Dining room

With double doors to BALCONY, Juliette balcony, window to rear

Kitchen

Fitted with a range of eye and base level units incorporating stainless steel sink unit with mixer tap and drainer, built in Siemens oven, fitted four ring hob with extractor over, built in fridge/freezer, built in Siemens slim line dishwasher, built in Siemens washer/dryer, part tiled walls, downlighters, tiled flooring, windows to side and rear





Bedroom 1

With two built in double wardrobes, window to side

En suite shower room

Corner shower cubicle housing fitted shower unit, low level W.C., wash hand basin with mixer tap, heated towel rail, part tiled walls, fitted mirror, shaver point, downlighters, tiled flooring

Bedroom 2

With built in double wardrobe, window to side

Bathroom

White suite comprising panelled bath with mixer tap and shower attachment, low level W.C., wash hand basin with mixer tap, part tiled walls, heated towel rail, tiled flooring, window to side

Communal gardens

Allocated parking

There are two allocated parking spaces and visitors parking



Approximate Gross Internal Area = 78.2 sq m / 842 sq ft

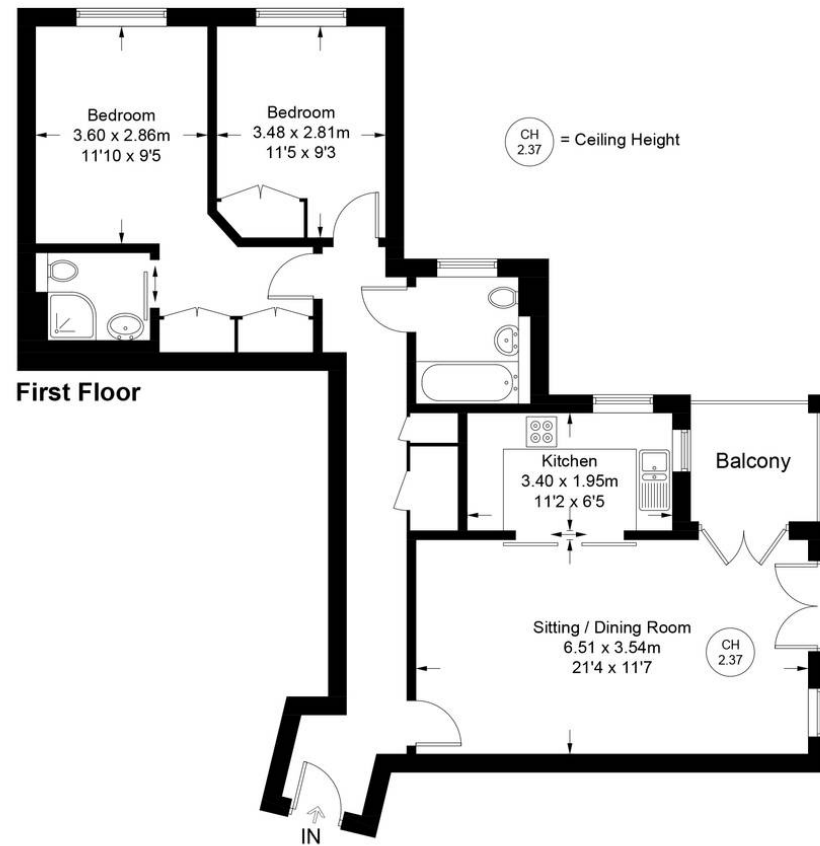

First Floor

Floor Plan produced for Robertsons by Media Arcade ©.

Illustration for identification purposes only. Window and door openings are approximate. Whilst every attempt is made to assure accuracy in the preparation of this plan, please check all dimensions, shapes and compass bearings before making any decisions reliant upon them.



Robertsons