



Esme Cottage The Common, Flackwell Heath

£400,000



Robertsons

Esme Cottage The Common

Flackwell Heath, High Wycombe

A mid terraced cottage in the conservation area in the centre of the village. The property offers many original character features and is well presented throughout. Sitting room, Fitted kitchen/Breakfast room, Shower room, Two bedrooms, Gas central heating, Double glazing, Off street parking, 88' rear garden. Viewing recommended.

Council Tax band: D

Tenure: Freehold

Sitting room

With attractive brick built fireplace with cast iron wood burner, radiator, wooden flooring, stairs to first floor with under stairs storage cupboard, window to front

Shower room

Shower cubicle housing fitted shower unit, low level W.C., wash hand basin with mixer tap and storage under, tiled walls, down lighters, tiled flooring, heated towel rail, fitted mirror, window to rear

Kitchen/Breakfast room

Fitted with a range of eye and base level units incorporating sink unit with mixer tap and drainer, built in oven, fitted four ring hob with extractor over, built in fridge/freezer, space and plumbing for washing machine, space and plumbing for dishwasher, part tiled walls, space for table, radiator, tiled flooring, concealed walls, mounted Potterton gas fired central heating boiler, window to rear, door to side

First floor





First floor

Landing

Bedroom 1

Radiator, window to front

Bedroom 2

Radiator, window to rear

Front garden/Parking

A gravelled driveway provides parking

Rear garden

Principally laid to lawn with pretty, well stocked flower and shrub borders. There is an area of decking, a timber shed and all is enclosed by panelled fencing. The garden extends to 88'.



Approximate Gross Internal Area 529 sq ft – 49 sq m
Ground Floor Area 320 sq ft – 30 sq m
First Floor Area 209 sq ft – 19 sq m

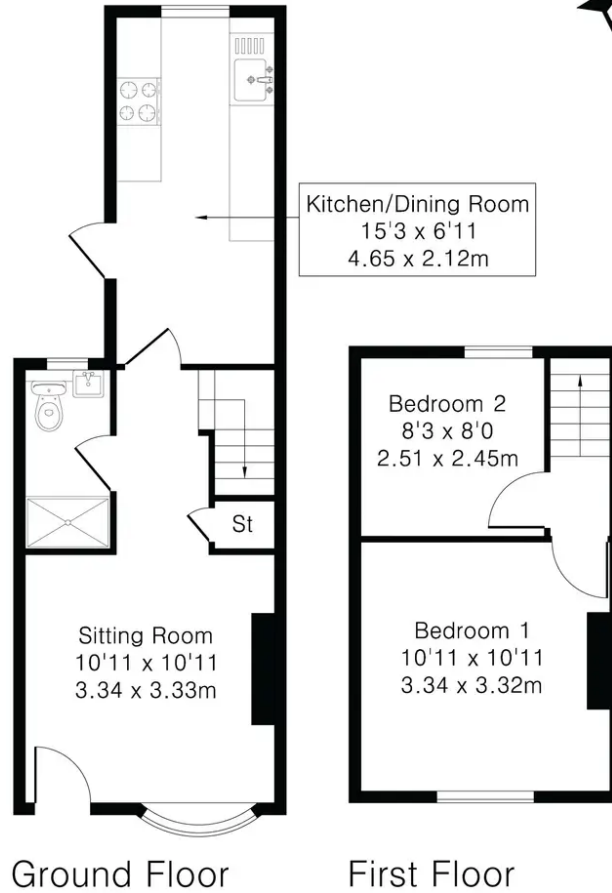

Robertsons