

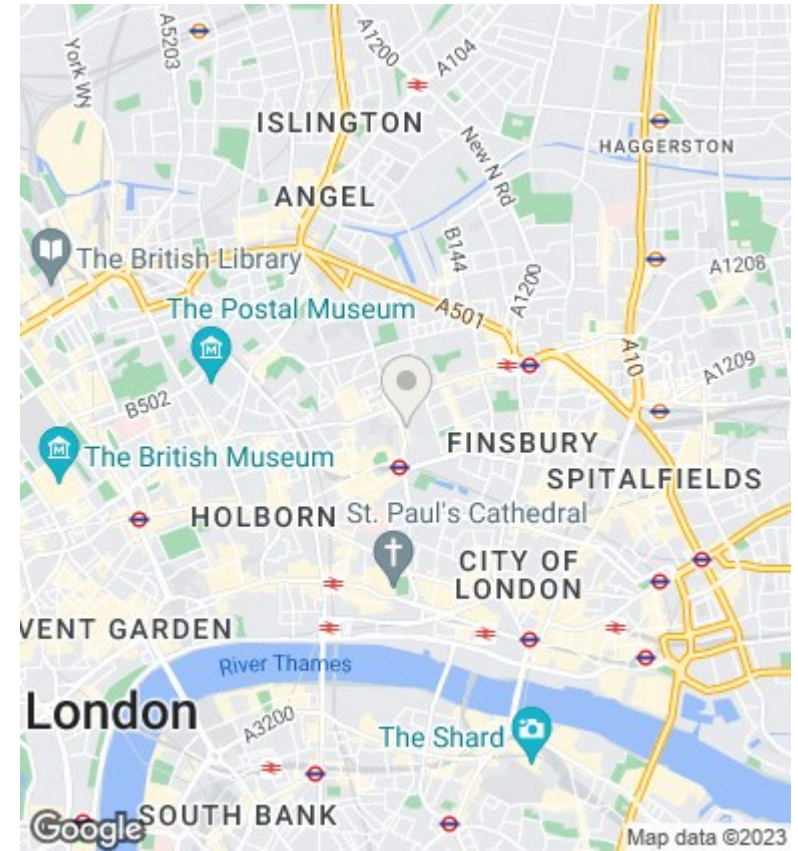

148, Crescent House, Golden Lane Estate EC1, London, **Asking Price** £425,000

- One Bedroom
- Wood Flooring
- Bathroom
- First floor
- Grade II Listed
- Lift
- East facing
- Kitchen



Crescent House, Golden Lane Estate, London, EC1Y

Approximate Area = 424 sq ft / 39.3 sq m
For identification only - Not to scale

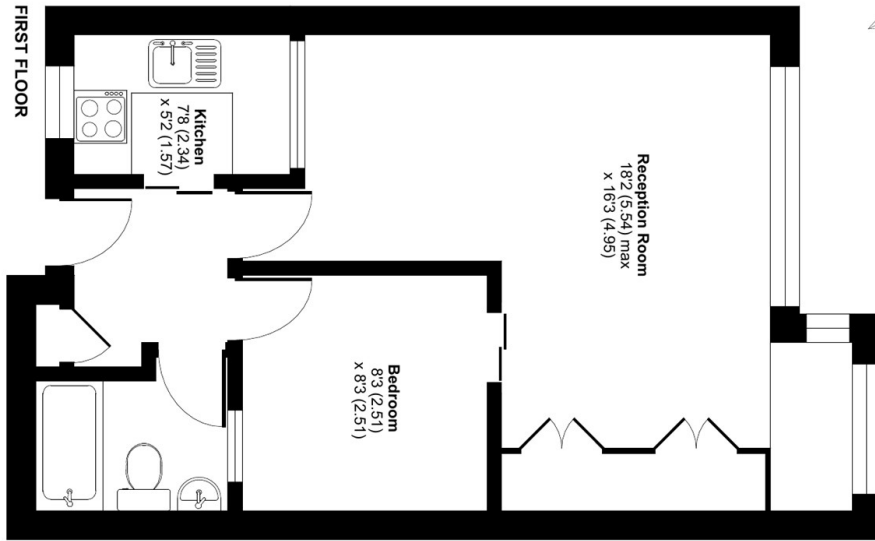

Floor plan produced in accordance with RICS Property Measurement Standards incorporating PAS 203 (PAS Reseller), © Hamilton 2023. Produced for Hamilton Brooks. REF: 865619

Directions

Viewings

Viewings by arrangement only. Call 020 7606 8000 to make an appointment.

Council Tax Band

EPC Rating:

Energy Efficiency Rating		Current	Potential
<i>Very energy efficient - lower running costs</i>			
(92 plus) A			
(81-91) B			
(69-80) C			
(55-68) D			
(39-54) E			
(21-38) F			
(1-20) G			
<i>Not energy efficient - higher running costs</i>			
England & Wales	EU Directive 2002/91/EC		