



# Fairway North, Bromborough

£800 PCM



**LESLEY HOOKS**  
ESTATE AGENTS







Welcome to your new cosy abode! Nestled in a sought-after residential area, this charming mid-terraced cottage is bursting with character and comfort. Step inside and discover a haven of modern convenience, where uPVC double glazing and combi fired gas central heating ensure year-round warmth and energy efficiency. The layout of this delightful cottage is thoughtfully designed, starting with a welcoming hall that sets the tone for what lies ahead. As you move through, you'll be greeted by a bright and inviting lounge adorned with a feature fireplace, perfect for cosy evenings spent with loved ones. Adjacent is the heart of the home: a beautifully fitted kitchen dining room complete with an oven and four-ring gas hob, ideal for whipping up delicious meals and entertaining guests. Venture upstairs and you'll find two generously sized double bedrooms, offering ample space for rest and relaxation. A tastefully appointed three-piece bathroom awaits, complete with a shower and a convenient shower screen over the bath, ensuring your daily routines are as effortless as possible. Outside, the charm continues with a driveway providing off-road parking to the front of the property, offering convenience and peace of mind. But the real gem lies to the rear—a lovely garden with a patio area that basks in the sun's glow thanks to its south-westerly aspect. Picture yourself enjoying al fresco dining or simply unwinding in this tranquil outdoor space. With its winning combination of modern comforts, convenient features, and irresistible charm, this mid-terraced cottage is more than just a place to live—it's a place to call home. Don't miss your chance to make it yours! Council tax band A. EPC tbc



#### **Hall**

2'8" (0.81m) x 2'8" (0.81m)

#### **Lounge**

14'0" (4.27m) x 13'0" (3.96m)

#### **Kitchen Dining Room**

17'1" (5.21m) x 8'11" (2.72m)

#### **Bedroom One**

14'0" (4.27m) x 11'1" (3.38m)

#### **Bedroom Two**

10'11" (3.33m) x 9'8" (2.95m)

#### **Bathroom**

7'10" (2.39m) x 7'0" (2.13m)







GROUND FLOOR

1ST FLOOR

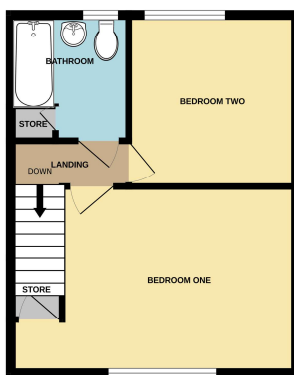
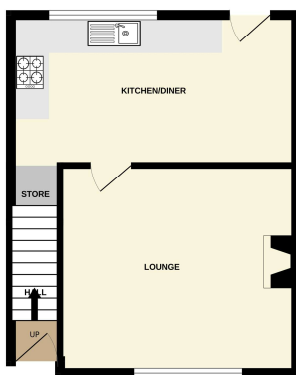

Whilst every attempt has been made to ensure the accuracy of the floorplan contained here, measurements of doors, windows, rooms and any other items are approximate and no responsibility is taken for any error, omission or mis-statement. This plan is for illustrative purposes only and should be used as such by any prospective purchaser. The services, systems and appliances shown have not been tested and no guarantee as to their operability or efficiency can be given.  
Made with floorplan CS004

Energy Efficiency Rating		
	Current	Potential
Very energy efficient - lower running costs		
(92 Plus) <b>A</b>		<b>87</b>
(81-91) <b>B</b>		
(69-80) <b>C</b>		
(55-68) <b>D</b>		<b>45</b>
(39-54) <b>E</b>		
(21-38) <b>F</b>		
(1-20) <b>G</b>		
Not energy efficient - higher running costs		
England & Wales		EU Directive 2002/91/EC

## Contact Us:

**0151 644 6000**

[lesley@lesleyhooks.co.uk](mailto:lesley@lesleyhooks.co.uk)

6 Church Road, Bebington,  
Wirral, Merseyside, CH63 7PH

Disclaimer: Whilst these details are thought to be correct, their accuracy cannot be guaranteed and do not form part of any contract. It should be noted that we have not tested any fixtures, fittings, equipment, apparatus or services, therefore we cannot verify that they are in working order of fit for purpose. Solicitors should be used to confirm that any moveable items described within these details are in fact part of the sale agreement. While we try to ensure measurements are correct they are not guaranteed and purchasers are advised to take their own measurements before ordering any fixtures and fittings. Please note: if you are buying a leasehold property, please ensure that all details and conditions of the lease are checked with your solicitor prior to you incurring any costs as additional fees could be incurred for items such as leasehold packs.