



Gardens Road, Bebington

£210,000



LESLEY HOOKS
ESTATE AGENTS





Welcome to this delightful end of terrace home, where light and airy spaces meet convenience in a perfect blend. Nestled within walking distance of local shops, schools, and rail links, this charming abode offers a lifestyle of ease and accessibility. As you step inside, you're greeted by a welcoming hallway adorned with wood block flooring, setting the tone for warmth and character throughout. The lounge, also adorned with wood block flooring, beckons with its inviting bow bay window, offering plenty of natural light to flood the space. Imagine cosy evenings by the feature fireplace, creating memories with loved ones. Two additional windows on the side add to the brightness and airiness of the room. Adjacent, the sitting room continues the theme of spaciousness, boasting windows to the side and rear that invite the outdoors in. With an open flow into the dining room, entertaining becomes a joyous affair, enhanced by the smart fitted kitchen just beyond. Meal preparation becomes a pleasure in this well-designed space, where functionality meets style seamlessly. Venture upstairs to discover three good-sized bedrooms, providing ample space for rest and relaxation. The three-piece bathroom offers both convenience and luxury, complete with a shower and shower screen over the bath, ensuring rejuvenating experiences every day. A handy shaver socket adds to the thoughtful details. Outside, the rear garden awaits with a patio area perfect for al fresco dining or simply basking in the sunshine. With uPVC double glazing and combi fired gas central heating, this home ensures comfort and efficiency year-round. Come experience the charm and convenience of this end of terrace gem – a place where every corner whispers welcome home! Council tax band A. Freehold.



Hallway

13'8" (4.17m) x 5'1" (1.55m)

Lounge

15'2" (4.62m) Into Bay x 11'2" (3.4m)

Sitting Room

12'0" (3.66m) x 10'1" (3.07m)

Dining Room

7'1" (2.16m) x 6'9" (2.06m)

Kitchen

18'3" (5.56m) x 8'6" (2.59m)

Bedroom One

17'6" (5.33m) Into Bay x 10'4" (3.15m)

Bedroom Two

10'5" (3.18m) x 10'8" (3.25m)

Bedroom Three

8'11" (2.72m) x 6'2" (1.88m)

Bathroom

6'3" (1.91m) x 6'1" (1.85m)







GROUND FLOOR
558 sq.ft. (51.9 sq.m.) approx.

1ST FLOOR
439 sq.ft. (40.8 sq.m.) approx.

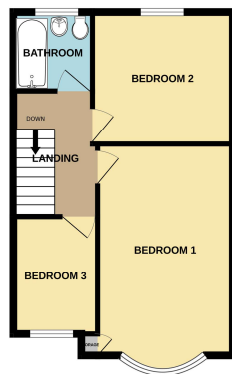
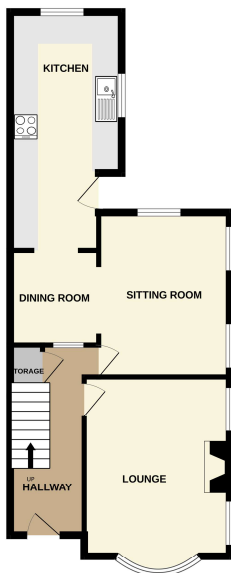

TOTAL FLOOR AREA: 997 sq.ft. (92.7 sq.m.) approx.

Whilst every effort has been made to ensure the accuracy of the information contained herein, measurements of plots, volumes, levels and any other facts are approximate and no responsibility is taken for any error, omission or misstatement. This plan is for guidance purposes only and should not be used as such for any prospective purchaser. The services, systems and appliances shown have not been tested and no guarantee is made regarding their condition or operation.

Contact Us:

0151 644 6000

lesley@lesleyhooks.co.uk

6 Church Road, Bebington,

Wirral, Merseyside, CH63 7PH

Disclaimer: Whilst these details are thought to be correct, their accuracy cannot be guaranteed and do not form part of any contract. It should be noted that we have not tested any fixtures, fittings, equipment, apparatus or services, therefore we cannot verify that they are in working order of fit for purpose. Solicitors should be used to confirm that any moveable items described within these details are in fact part of the sale agreement. While we try to ensure measurements are correct they are not guaranteed and purchasers are advised to take their own measurements before ordering any fixtures and fittings. Please note: if you are buying a leasehold property, please ensure that all details and conditions of the lease are checked with your solicitor prior to you incurring any costs as additional fees could be incurred for items such as leasehold packs.