



01452 690553



sales@applebys.estate



www.applebysestateagents.co.uk



## 44 Katherine Close

, Churchdown, GL3 1PB

**£195,000**



This two bedroom starter home is ideal if you are looking to put your own stamp on a property, in need of updating offering lots of potential \*\*\*CHAIN FREE\*\*\*





Lounge/Diner 15'8 x 11'10 (4.78m x 3.61m)

Kitchen/Breakfast Room 11'10 x 9'0 (3.61m x 2.74m)

Bedroom 1 11'10 x 9'0 (3.61m x 2.74m)

Bedroom 2 11'10 x 7'5 (3.61m x 2.26m)

Bathroom

OUTSIDE

Situated in a cul-de-sac, OFF ROAD parking can be found to the front of the property with gated side access to the rear garden.

The garden is mainly laid to lawn all enclosed backing onto Imjin Barracks.

Services

mains drainge, gas central heating

Tewkesbury Borough Council B

Tenure

Freehold

Area Map



Floor Plans

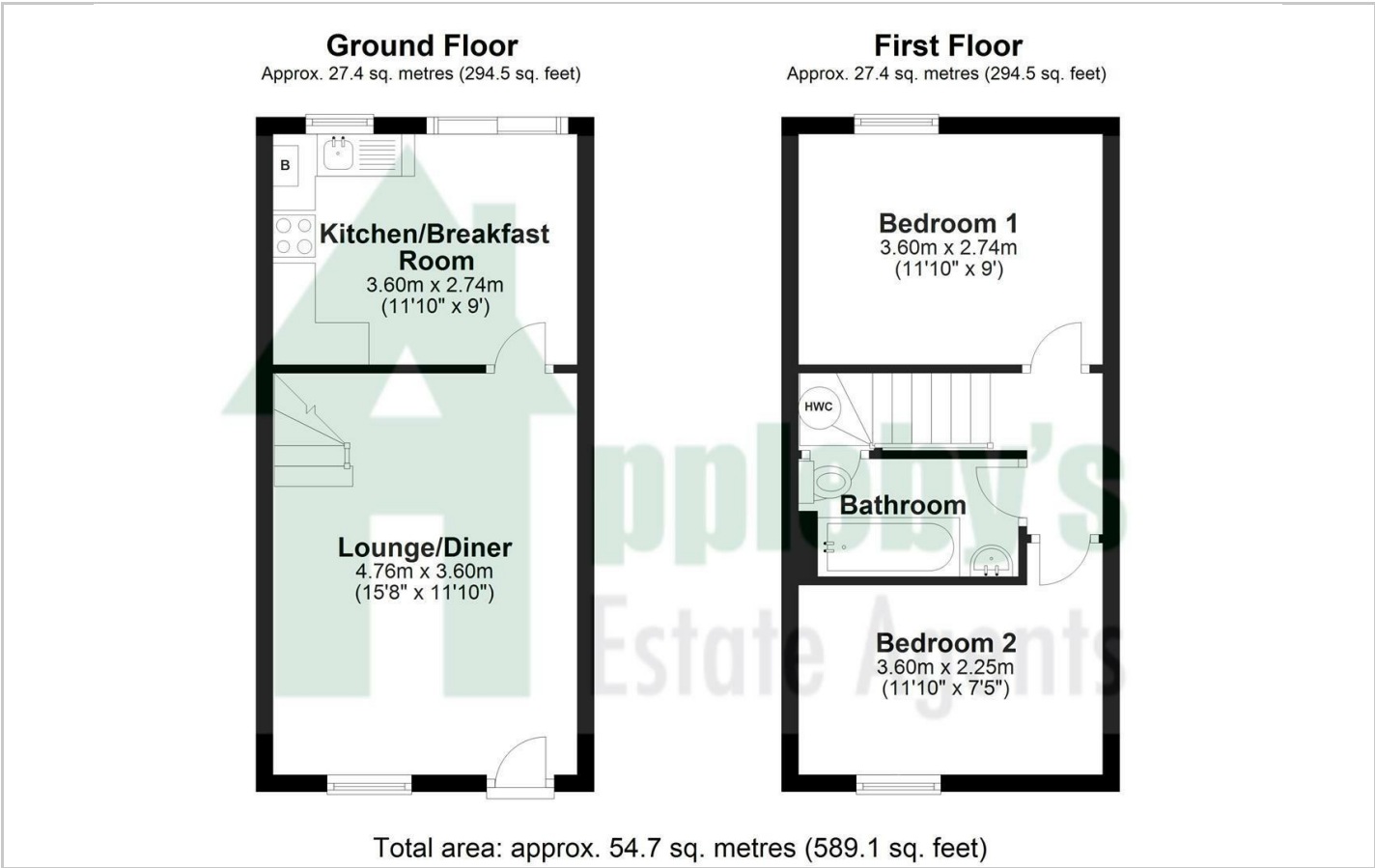

Energy Efficiency Graph

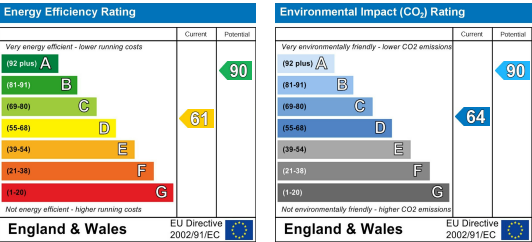

These particulars, whilst believed to be accurate are set out as a general outline only for guidance and do not constitute any part of an offer or contract. Intending purchasers should not rely on them as statements of representation of fact, but must satisfy themselves by inspection or otherwise as to their accuracy. No person in this firms employment has the authority to make or give any representation or warranty in respect