



01452 690553



sales@applebys.estate



www.applebysestateagents.co.uk



# 15 Bazeley Road

, Matson, GL4 6JB

**£170,000**

3 1 1 C

This three bedroom home is an ideal first time by offering lots of potential\*\*\*CHAIN FREE\*\*\*



Entrance Hall

Lounge/Dining Room 18'4 x 17'6 (5.59m x 5.33m)

Kitchen/Breakfast Room 11'3 x 8'11 (3.43m x 2.72m)

Utility 9'4 x 5'1 (2.84m x 1.55m)

Bedroom 1 12'6 x 11'11 ( max) (3.81m x 3.63m ( max) )

Bedroom 2 12'1 x 10'11 (3.68m x 3.33m)

Bedroom 3 9'0 x 7'9 (2.74m x 2.36m)

Bathroom

WC

## OUTSIDE

Walkfrontage with steps leading down to the front door, with a secondary door giving access to Utility.  
The rear garden is all enclosed mainly laid to lawn with garden shed.

## Services

Mains drainage and gas central heating  
Gloucester City Council tax band A

## Tenure

## Area Map



## Floor Plans

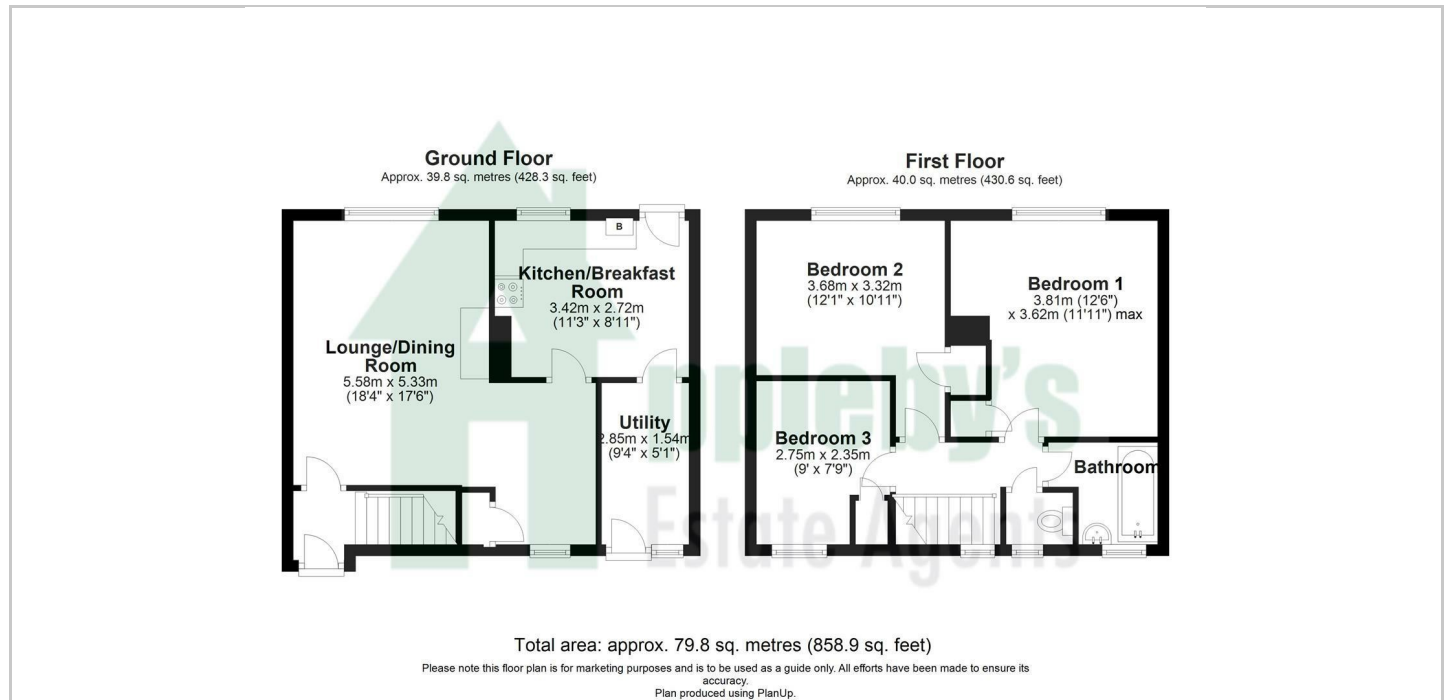

## Energy Efficiency Graph

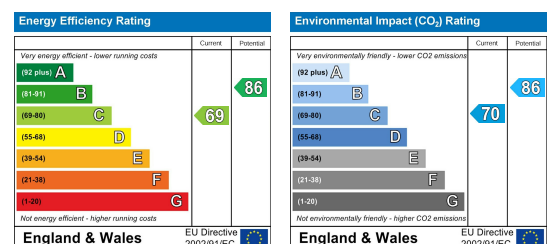

These particulars, whilst believed to be accurate are set out as a general outline only for guidance and do not constitute any part of an offer or contract. Intending purchasers should not rely on them as statements of representation of fact, but must satisfy themselves by inspection or otherwise as to their accuracy. No person in this firm's employment has the authority to make or give any representation or warranty in respect of these particulars.