



01452 690553



sales@applebys.estate



www.applebysestateagents.co.uk



## 4 Glebe Court

, Newent, GL18 1DU

**£200,000**



This two bedroom property is an ideal starter home having been lived in by the same owner since new (1991).

An ideal opportunity put out your own stamp on the property offering lots of potential, situated Close to the centre of Newent Town Centre **\*\*CHAIN FREE\*\***



Entrance Hall

WC

Kitchen 9'2 x 7'4 (2.79m x 2.24m)

Lounge/Dining Room 15'2 x 13'11 (4.62m x 4.24m)

Bedroom 1 13'11 x 13'11 (4.24m x 4.24m)

Bedroom 2 10'4 x 7'4 (3.15m x 2.24m)

Bathroom

### OUTSIDE

Driveway to the front and small lawned front garden. The rear garden is mainly laid to lawn with various shrubs and bushes, personnel door to the Utility Area 10'9 x 8'3 ft and Store Room 8'3 ft x 6'3 ft (approx.) this can also be accessed via the electric roller door .

### Services

Mains Drainage, and gas central heating  
Forest Of Dean District council tax band : B

### Tenure

Freehold

### Area Map



### Floor Plans

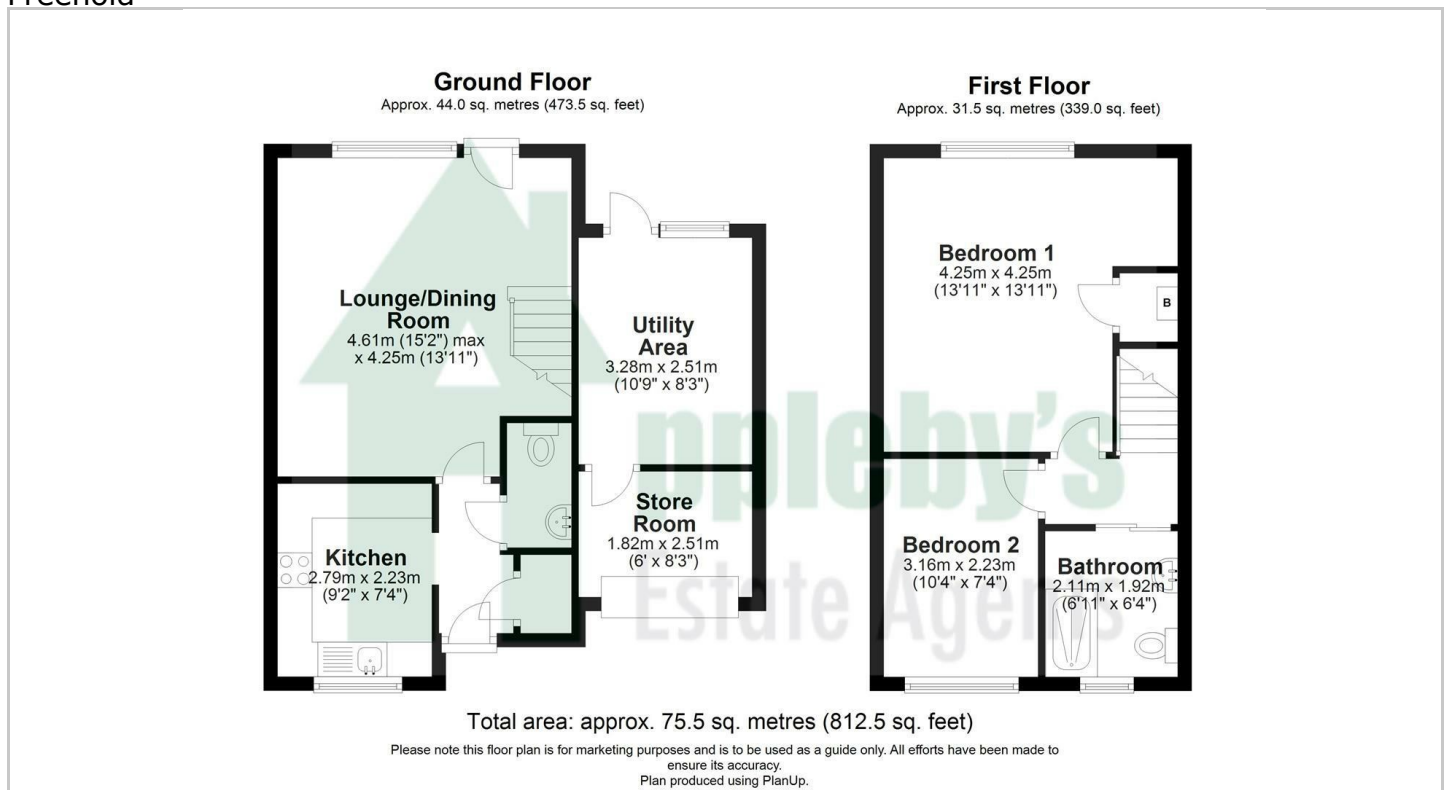

### Energy Efficiency Graph

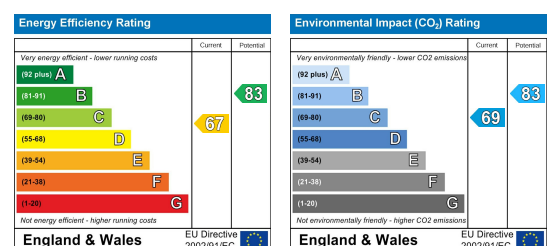

These particulars, whilst believed to be accurate are set out as a general outline only for guidance and do not constitute any part of an offer or contract. Intending purchasers should not rely on them as statements of representation of fact, but must satisfy themselves by inspection or otherwise as to their accuracy. No person in this firm's employment has the authority to make or give any representation or warranty in respect of these particulars.