



Mayfield Tibberton Lane  
, Tibberton, GL2 8EB

**£550,000**

 4  1  2  D

## Escape the the Countryside!

This FOUR bedroom family home is ready to move into! When you walk into the property you will feel that this is a loved home and has been for many years, Beautifully presented throughout, a perfect layout for a growing family. The garden is approx. 180ft with views of the surrounding countryside.

### The Situation

Tibberton is located 5 miles from Gloucester and 5 miles from Newent, The local primary school is Tibberton Community Primary, the village also has a Church and Village Hall.

### Entrance Hall

### Lounge

20'4 x 12'1 (6.20m x 3.68m)

### Dining Room

12'4 x 9'5 (3.76m x 2.87m)

### Kitchen/Breakfast Room

17'10 x 15'10 (5.44m x 4.83m)

### WC

### Bedroom 1

14'6 x 12'8 (4.42m x 3.86m)

### Bedroom 2

12'4 x 11'3 (3.76m x 3.43m)

### Bedroom 3

12'4 x 9'5 (3.76m x 2.87m)





**Bedroom 4**  
9'1 x 7'0 (2.77m x 2.13m)

**Bathroom**

**OUTSIDE**

Leaving the lane the driveway provides ample OFF ROAD parking leading to the garage. The very mature rear garden is approx. 180ft and if you are a keen gardener this is for you, mainly laid to lawn with vegetable plot, greenhouse and potting shed, 3 fruit trees (apple & pear), surrounding fields to the rear with a pleasant view to be enjoyed.



**Services**

Mains drainage, Oil  
Forest of Dean District Council:  
tax band E

**Tenure**  
Freehold



*Every love story is beautiful,  
but ours is my favourite.*

## Floor Plan

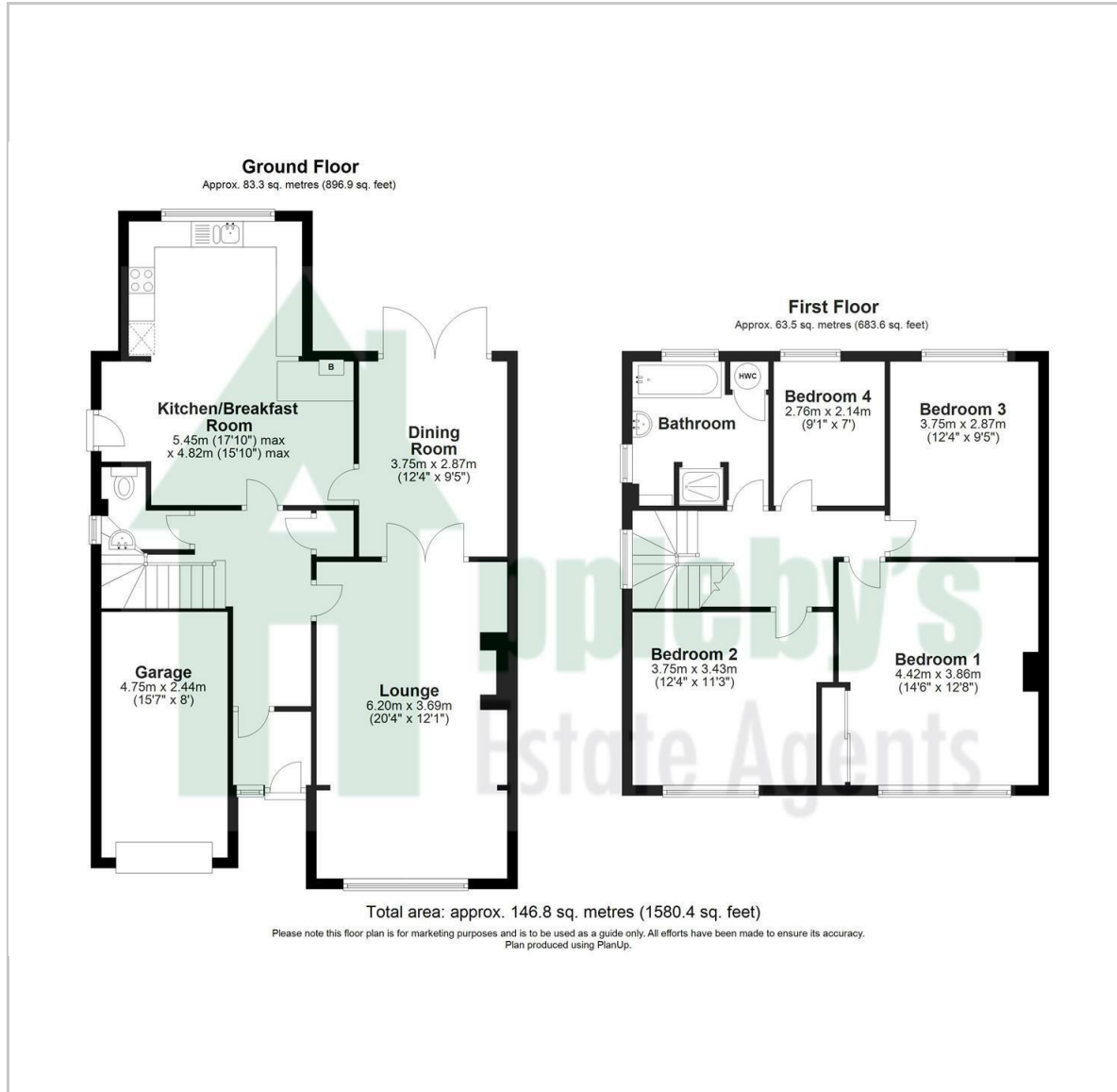

## Viewing

Please contact our Appleyby's Office on 01452 690553 if you wish to arrange a viewing appointment for this property or require further information.

These particulars, whilst believed to be accurate are set out as a general outline only for guidance and do not constitute any part of an offer or contract. Intending purchasers should not rely on them as statements of representation of fact, but must satisfy themselves by inspection or otherwise as to their accuracy. No person in this firm's employment has the authority to make or give any representation or warranty in respect of the property.

## Area Map

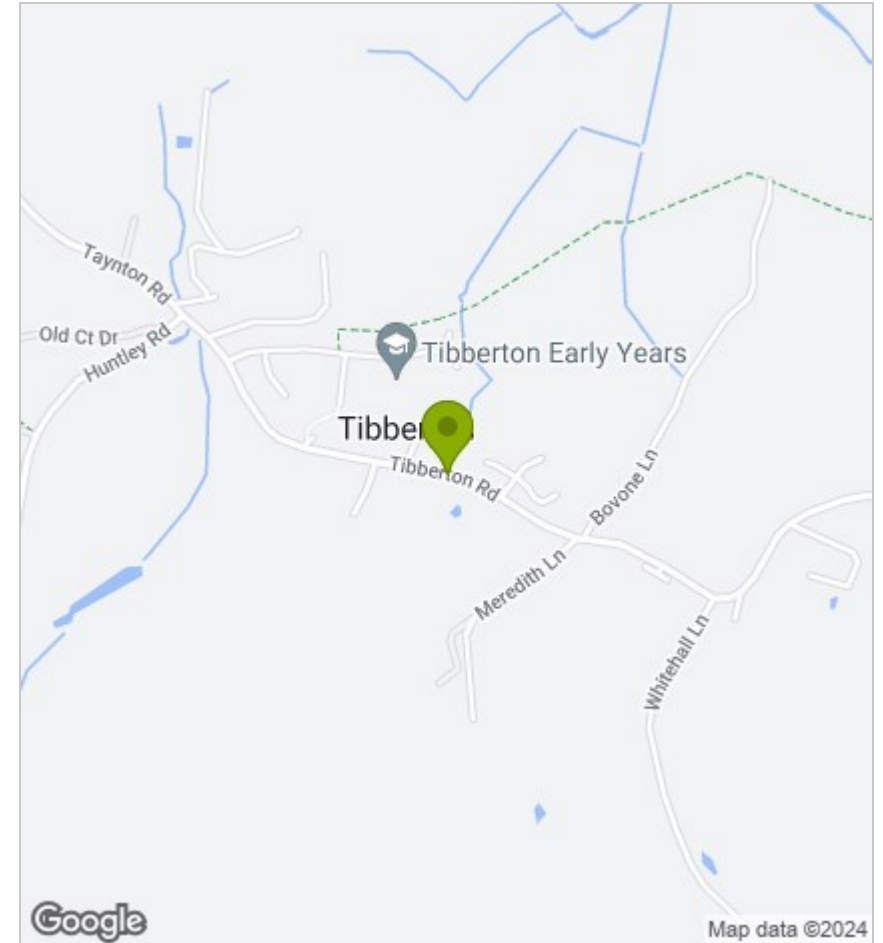

## Energy Efficiency Graph

