

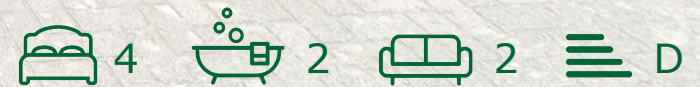

5 Harebell Place  
, Abbeymead, GL4 4AH

**£475,000**





A modern and beautifully presented FOUR bedroom detached home is situated in a NO THROUGH ROAD.

This property boasts KITCHEN/DINING, TWO reception rooms, STUDY and ENSUITE to master bedroom furthermore a very mature garden and DOUBLE GARAGE.

Situated in the popular area of Abbeymead, this property offers not just a beautiful home, but also a thriving area close to all the local amenities.

### Entrance Hall

### Living Room

16'6 x 12'4 (5.03m x 3.76m)

### Dining Room

12'4 x 9'1 (3.76m x 2.77m)

### Kitchen/Breakfast Room

13'9 x 12'4 (4.19m x 3.76m)

### WC

### Study

7'1 x 6'8 (2.16m x 2.03m)

### Bedroom 1

12'6 x 9'8 (3.81m x 2.95m)

### Ensuite

### Bedroom 2

12'7 x 9'2 (3.84m x 2.79m)

### Bedroom 3

8'10 x 8'10 (2.69m x 2.69m)







**Bedroom 4**  
8'11 x 8'3 (2.72m x 2.51m)

**Bathroom**

**OUTSIDE**

Situated in a NO THROUGH ROAD driveway provides ample off road parking with side access to the rear garden leading to the DOUBLE GARAGE 18'8 x 17'5.

One of the standout features of this property is the very mature garden, the circular lawn surrounded by very mature shrubs, trees and large patio, additionally a subdivided barked area with garden shed, summer house and vegetable produce area.



**Services**

Mains drainage, gas  
Gloucester City Council tax band E

**Tenure**

Freehold



## Floor Plan

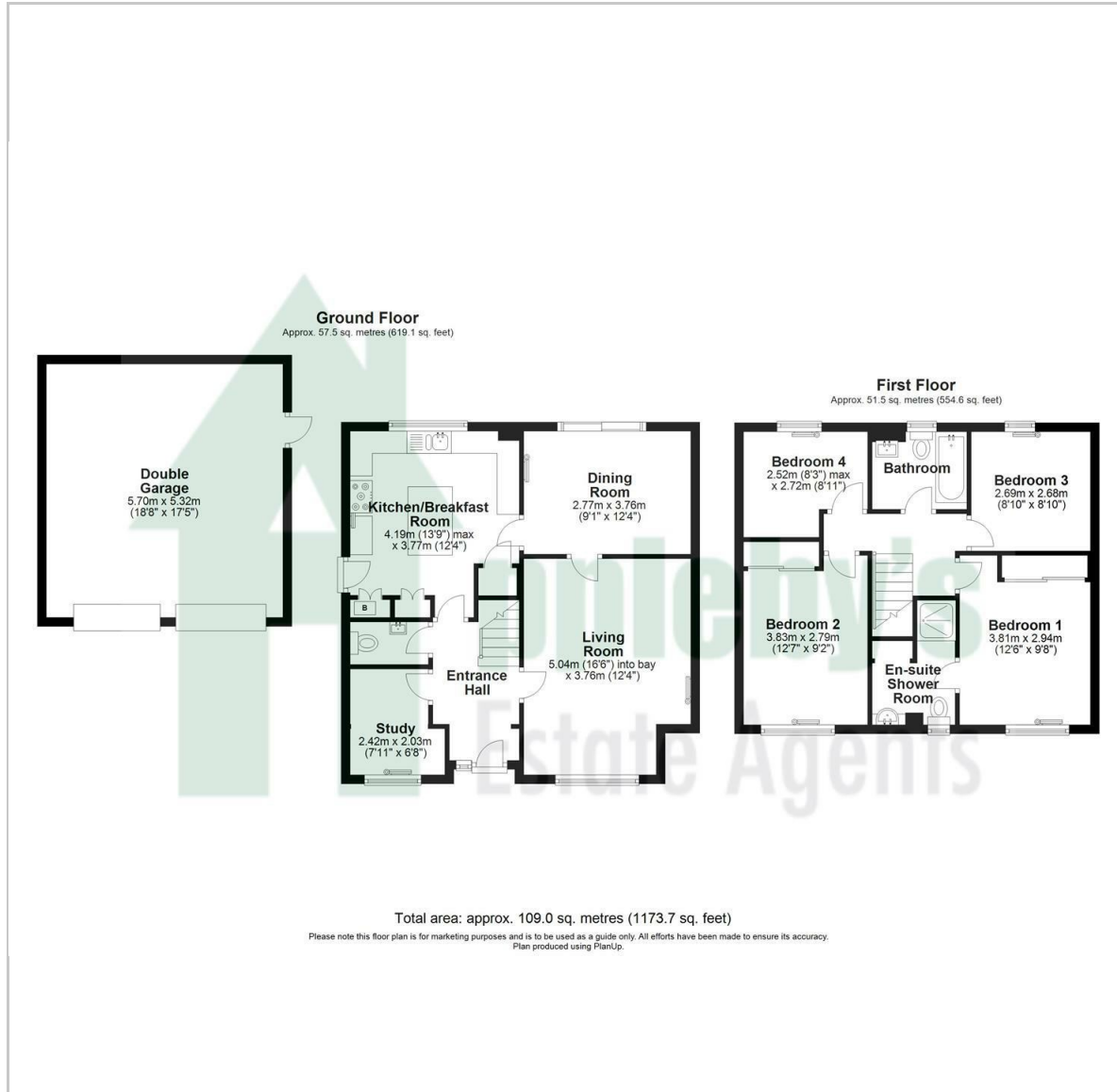

## Viewing

Please contact our Appleby's Office on 01452 690553 if you wish to arrange a viewing appointment for this property or require further information.

These particulars, whilst believed to be accurate are set out as a general outline only for guidance and do not constitute any part of an offer or contract. Intending purchasers should not rely on them as statements of representation of fact, but must satisfy themselves by inspection or otherwise as to their accuracy. No person in this firm's employment has the authority to make or give any representation or warranty in respect of the property.

## Area Map

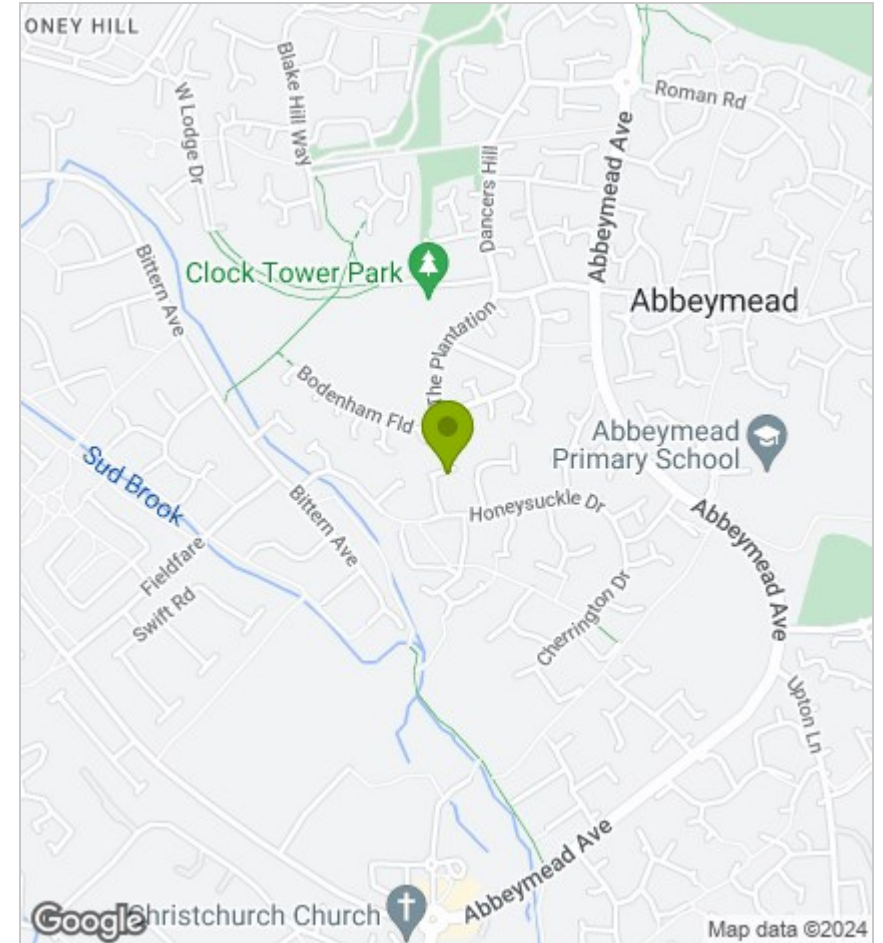

## Energy Efficiency Graph

