



01452 690553



sales@applebys.estate



www.applebysestateagents.co.uk



11 Forest Road

, Cinderford, GL14 2NT

£210,000

4 1 2 C

Welcome to this charming mid-terrace home located on Forest Road in the town of Cinderford. This delightful property boasts two reception rooms, with three bedrooms and attic room.

This property is conveniently located close to amenities. Don't miss out on this fantastic opportunity in the heart of Cinderford. *CHAIN FREE*



- Porch 7'3 x 5'2 (2.21m x 1.57m)
- Lounge/Dining Room 16'2 x 9'8 (4.93m x 2.95m)
- Garden Room 14'3 x 7'9 (4.34m x 2.36m)
- Kitchen 13'1 x 5'5 (3.99m x 1.65m)
- Family Room 16'3 x 7'9 (4.95m x 2.36m)
- Bedroom 1 12'2 x 8'2 (3.71m x 2.49m)
- Bedroom 2 12'1 x 9'7 (3.68m x 2.92m)
- Bedroom 3 8'3 x 6'8 (2.51m x 2.03m)
- Attic Room 15'3 x 11'5 (4.65m x 3.48m)

Bathroom

OUTSIDE

To the front of the property off road parking.
 The rear garden is all enclosed courtyard (The lawned area is not owned by the property but has had exclusive use since the property was built)

Services

Mains drainage, Gas.
 Forest of Dean Council tax band- B

Tenure

Freehold

Area Map



Floor Plans

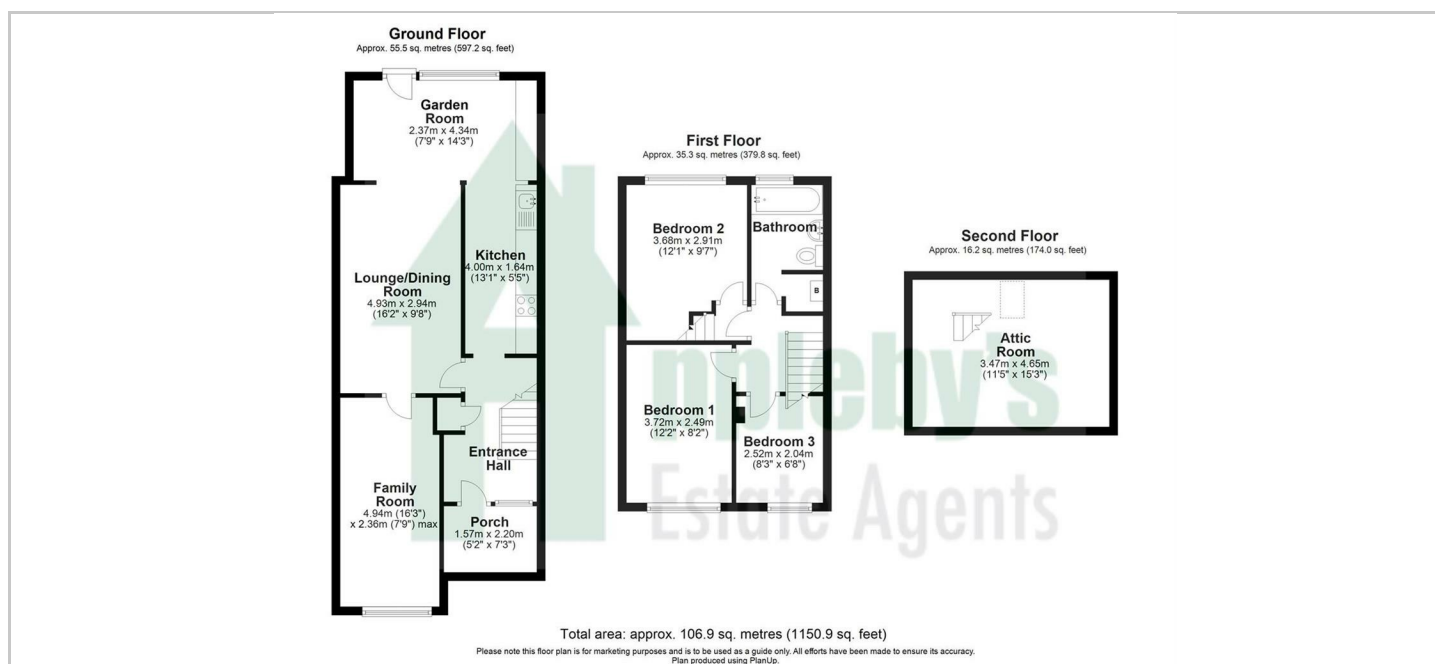

Energy Efficiency Graph

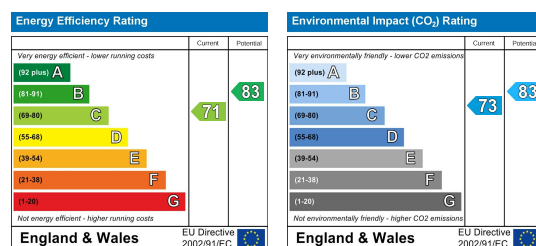

These particulars, whilst believed to be accurate are set out as a general outline only for guidance and do not constitute any part of an offer or contract. Intending purchasers should not rely on them as statements of representation of fact, but must satisfy themselves by inspection or otherwise as to their accuracy. No person in this firms employment has the authority to make or give any representation or warranty in respect