



01452 690553



sales@applebys.estate



www.applebysestateagents.co.uk



Wisteria Cottage , Tibberton, GL2 8EB

£355,000

This charming detached THREE bedroom countryside cottage is situated in the centre of the village Tibberton. On your doorstep you have access to the rural countryside, enjoy the outdoors ? this property is for you. Front and rear gardens can be enjoyed with views to the rear of the surrounding privately owned land and countryside as far as you can see.

Porch

Utility Area 7'6 x 6'5 (2.29m x 1.96m)

Kitchen/Breakfast Room 14'3 x 11'4 (4.34m x 3.45m)

Cloakroom

Dining Room 20'0 x 13'1 (6.10m x 3.99m)

Bedroom 1 11'5 x 9'11 (3.48m x 3.02m)

Bedroom 2 11'10 x 9'4 (3.61m x 2.84m)

Bedroom 3 8'3 x 6'9 (2.51m x 2.06m)

Bathroom

OUTSIDE

Gate from the lane gives access to the front garden all enclosed mainly laid to lawn with various shrubs and bushes and a feature pond. Side access leads to the rear garden being low maintenance with a large patio where you will be able to enjoy the views!

Services

Mains drainage , Oil

Forest of Dean District Council tax band : D

Tenure

Freehold

Floor Plan

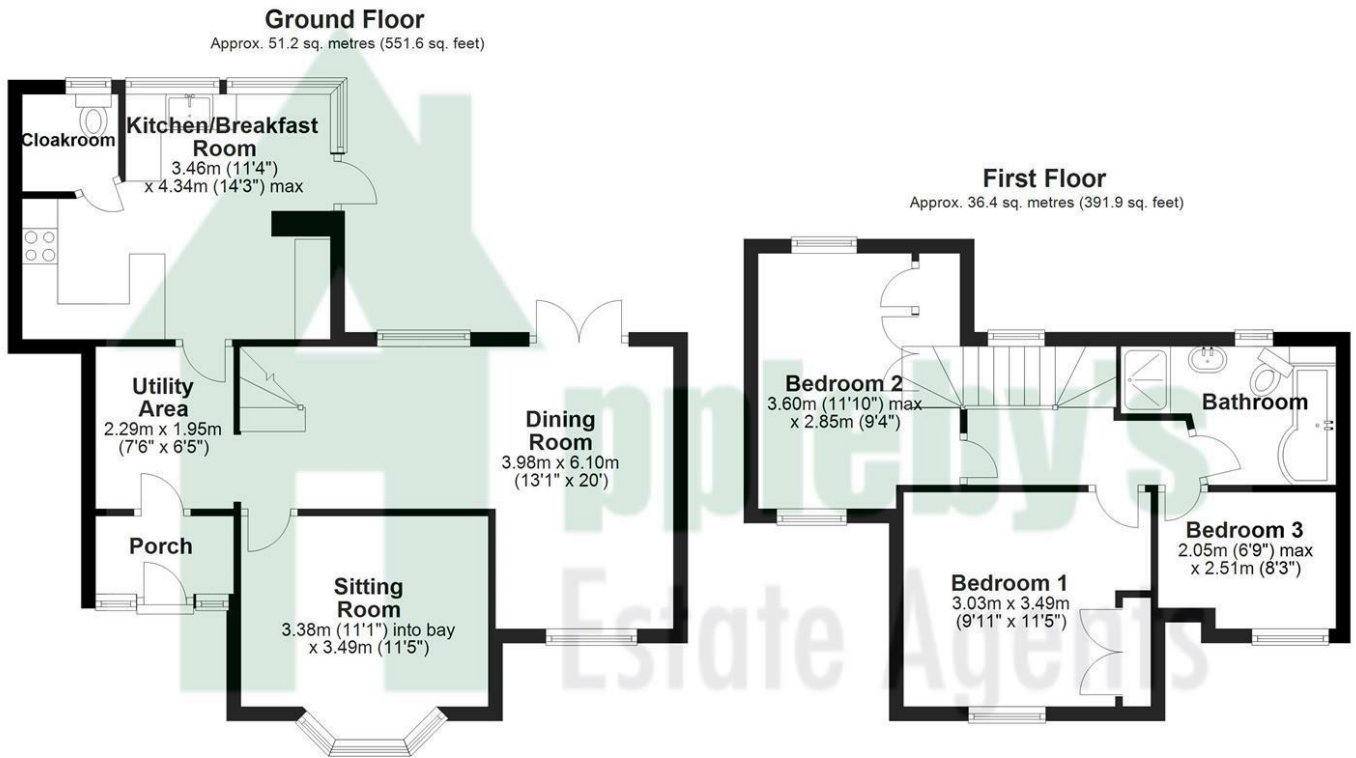

Total area: approx. 87.7 sq. metres (943.5 sq. feet)

Please note this floor plan is for marketing purposes and is to be used as a guide only. All efforts have been made to ensure its accuracy. Plan produced using PlanUp.

Area Map



Energy Efficiency Graph

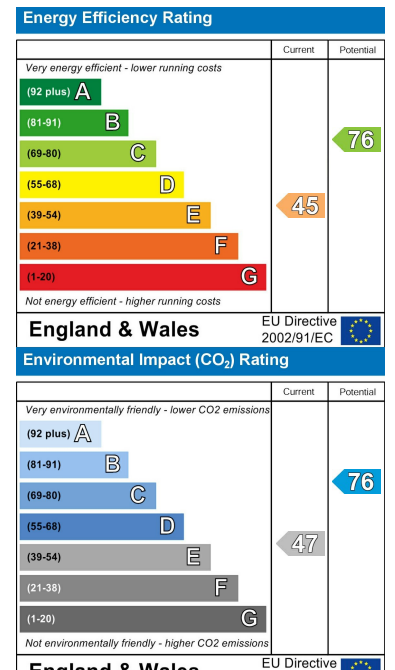

These particulars, whilst believed to be accurate are set out as a general outline only for guidance and do not constitute any part of an offer or contract. Intending purchasers should not rely on them as statements of representation of fact, but must satisfy themselves by inspection or otherwise as to their accuracy. No person in this firm's employment has the authority to make or give any representation or warranty in respect of the property.