



01452 690553



sales@applebys.estate



www.applebysestateagents.co.uk



**22 The Maples, Abbeymead, GL4 5WQ**

**£364,950**

This very well presented modern THREE bedroom DETACHED family home is ready to move into!  
Benefitting ENSUITE to master and GARAGE. Situated in a Cul-De-Sac \*\*\*CHAIN FREE\*\*\*

## Entrance Hall

Kitchen/Breakfast Room 13'9 x 6'7 (4.19m x 2.01m)

Lounge/Dining Room 17'10" x 12'9" (5.44m x 3.89m)

## WC

Bedroom 1 11'0 x 10'10 (3.35m x 3.30m)

## Ensuite

Bedroom 2 12'11 x 9'0 (3.94m x 2.74m)

Bedroom 3 9'8 x 8'9 (2.95m x 2.67m)

## Bathroom

## OUTSIDE

Situated in a Cul-De-Sac, the stylish resin bound driveway has ample off road parking leading to the GARAGE, outside tap and gated side access to the rear.

The garden is very low maintenance with undercover area (resin bound), an ideal entertaining space come rain or shine. It also has the benefit of the wood burner, ideal for those colder evenings, the rest of the garden is laid to astro-turf with a composite decking area to the rear.

## Services

Mains drainage and gas central heating  
Gloucester City Council tax band D

## Tenure

Freehold

# Floor Plan

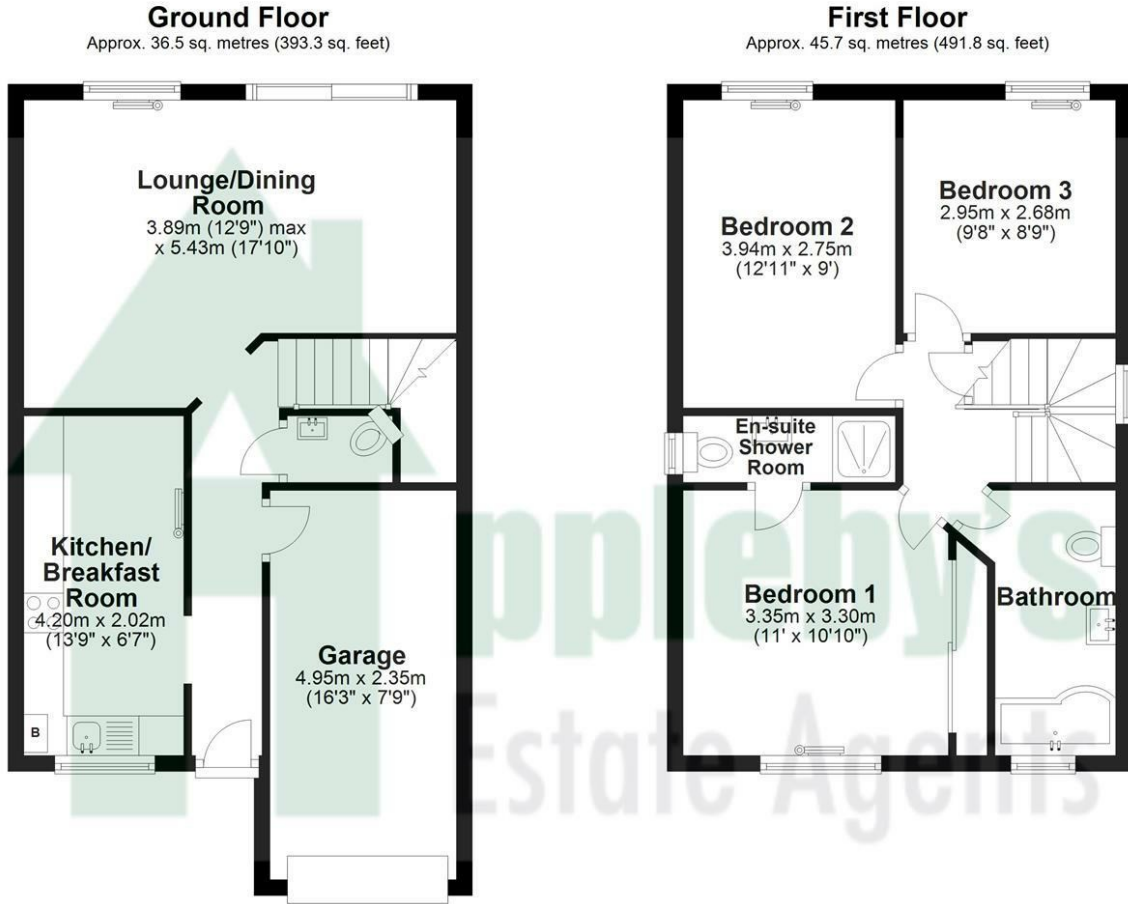

Total area: approx. 82.2 sq. metres (885.1 sq. feet)

Please note this floor plan is for marketing purposes and is to be used as a guide only. All efforts have been made to ensure its accuracy. Plan produced using PlanUp.

# Area Map

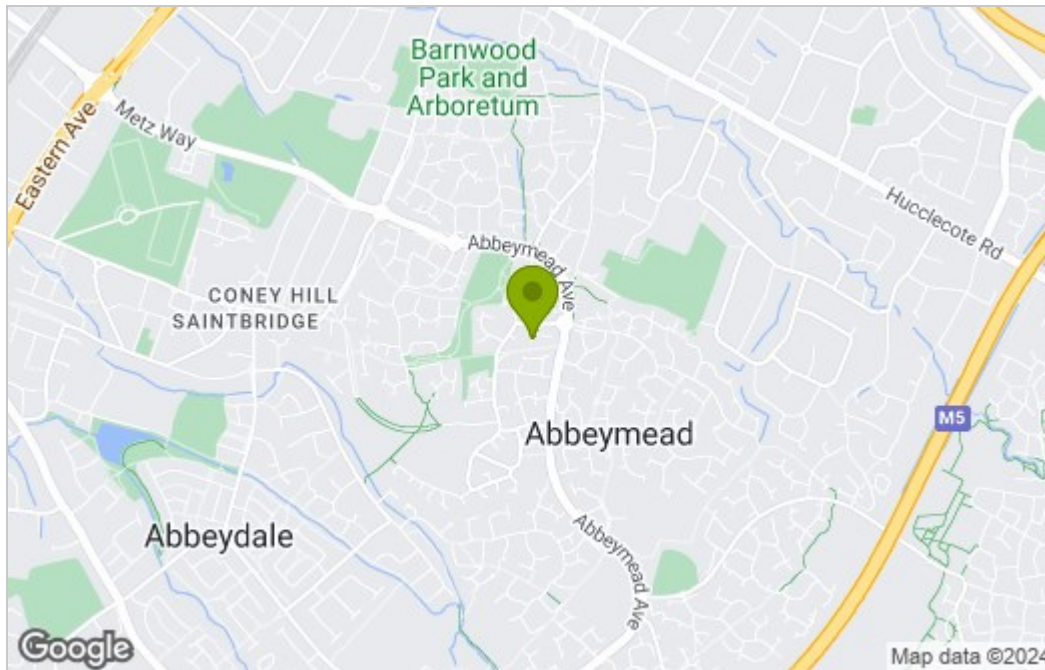

# Energy Efficiency Graph

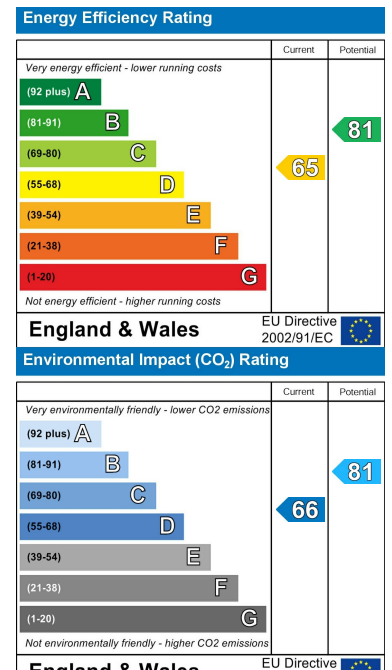

These particulars, whilst believed to be accurate are set out as a general outline only for guidance and do not constitute any part of an offer or contract. Intending purchasers should not rely on them as statements of representation of fact, but must satisfy themselves by inspection or otherwise as to their accuracy. No person in this firm's employment has the authority to make or give any representation or warranty in respect of the property.