



## South Dockside, Baltimore Wharf, Oakland Quay, Canary Wharf, E14

Price **£650 per week** | Furnished





# South Dockside, Baltimore Wharf, Oakland Quay, Canary Wharf, E14



2 Bedrooms



2 Bathrooms



1 Reception



Balcony



River Views



Local Amenities



24-Hour Concierge



0.1 MI Crossharbour

A stunning two bedroom, two bathroom apartment set in Baltimore Wharf, which is a dockside development in Canary Wharf E14. The property features high specification throughout, a fully fitted kitchen, with an open-plan living room, a spacious master bedroom with sliding wardrobes and a bathroom suite, a family size bathroom with contemporary fittings. The living area and two bedrooms all have access to a private balcony with dockside views.

The development benefits from a 24-hour concierge service and is ideally located close to

transport routes and within walking distance of Canary Wharf. South Dockside is located 0.1 miles from Crossharbour DLR station, and 0.8 miles from Canary Wharf tube station. Also within a short walking distance of the thriving Canary Wharf district which has an array of bars, restaurants, and shops.



**Local Authority:**

Tower Hamlets

**Council Tax Band:**

F

**EPC:**

B

**Security deposit:**

equivalent to 5 weeks' rent

# Floorplan

851 sq ft | 79 sq m

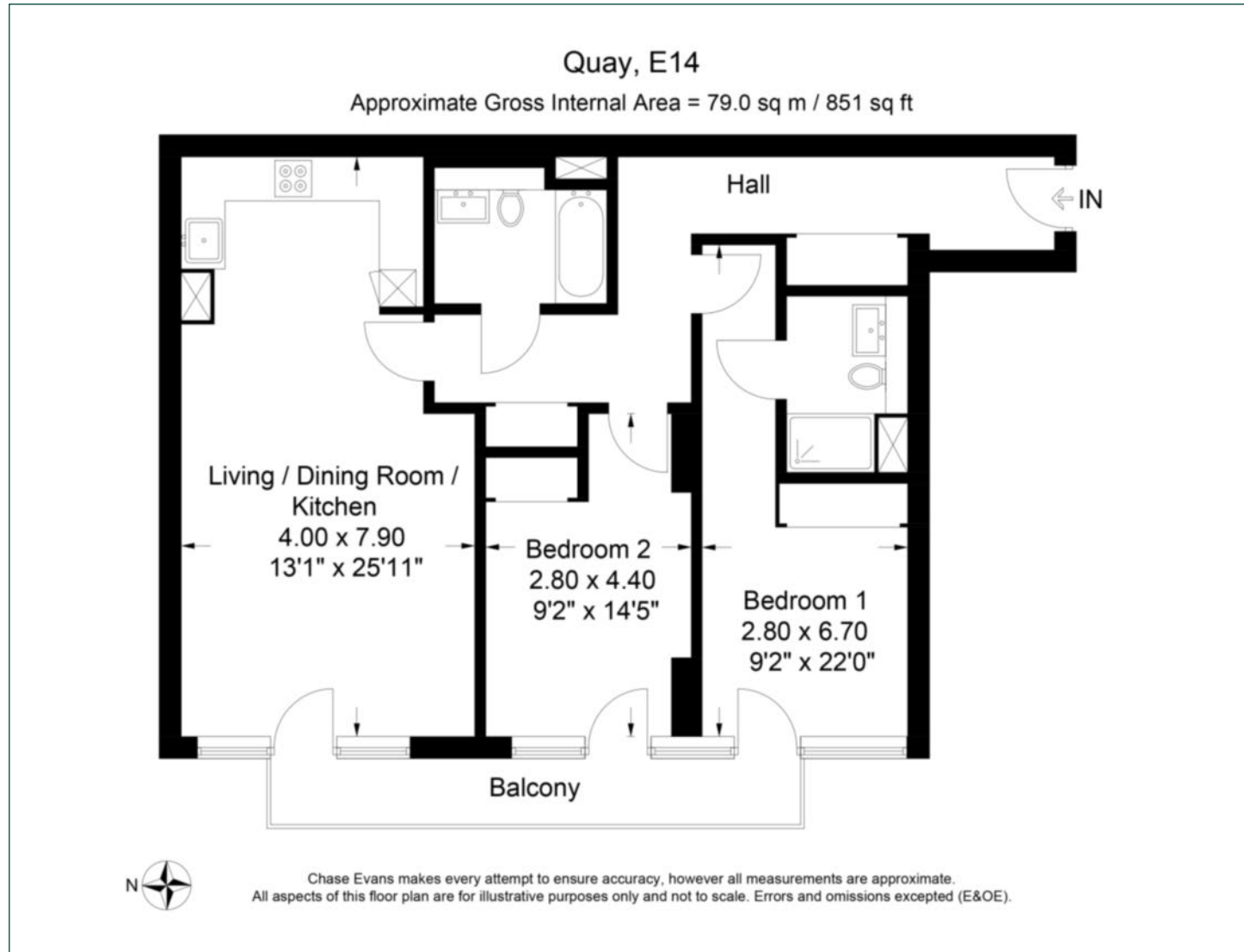

## Lettings

## We're here to help.

IMPORTANT NOTICE - These particulars have been prepared in good faith and they are not intended to constitute part of an offer or contract. We have not performed a structural survey on this property and the services, appliances and specific fittings have not been tested. All photographs, measurements, floor plans and distances referred to are given as a guide and should not be relied upon.

[chaseevans.com](http://chaseevans.com)