

Constable House, Cassilis Road, Canary Wharf, E14

Asking price **£385,000** | Leasehold



Constable House, Cassilis Road, Canary Wharf, E14



1 Bedroom



1 Bathroom



1 Reception



Balcony



Gymnasium



Local Amenities



24-Hour Concierge



0.2 MI South Quay

A bright one bedroom apartment set within Canary Central, a modern development located within easy reach of Canary Wharf. Accommodation comprises of a living room with wood flooring, a private balcony, a semi open plan kitchen with integrated appliances, a double bedroom and a bathroom with contemporary fittings.

Residents have the benefit of 24-hour concierge, gym and pool facilities. The apartment is located close to local supermarkets, eateries and a dry cleaners and is only 0.5 miles from the centre of Canary Wharf with its excellent selection of shops

and restaurants. There are plenty of transport options close by: South Quay DLR (0.2 miles) and Canary Wharf Jubilee and Elizabeth line stations (0.5 miles).

Tenure: Leasehold (979 years remaining) **Local Authority:** Tower Hamlets

Ground Rent: £250 p.a. **Council Tax Band:** D

Service Charge: £2,700 p.a. **EPC:** D



Floorplan

477 sq ft | 44.30 sq m

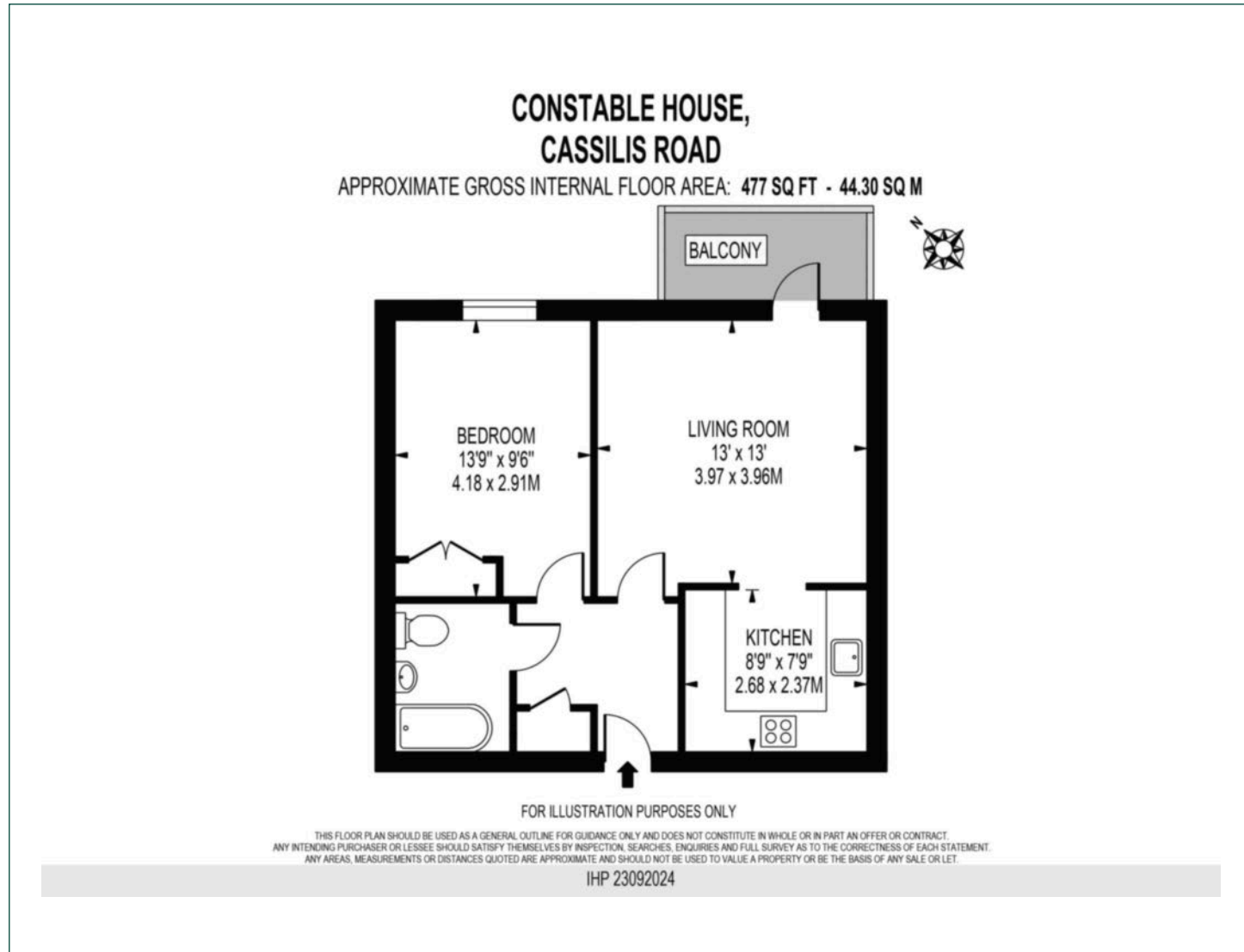

Pan Peninsula

Pan Peninsula, 1 Millharbour, London, E14 9XP

Sales

020 7536 7901 | panp.sales@chaseevans.com

We're here to help.

IMPORTANT NOTICE - These particulars have been prepared in good faith and they are not intended to constitute part of an offer or contract. We have not performed a structural survey on this property and the services, appliances and specific fittings have not been tested. All photographs, measurements, floor plans and distances referred to are given as a guide and should not be relied upon.

[chaseevans.com](https://www.chaseevans.com)