







Indescon Square, Canary Wharf, E14

Price **£490 per week** | Furnished



Indescon Square, Canary Wharf, E14

-  1 Bedroom
-  1 Bathroom
-  1 Reception
-  Balcony
-  Local Amenities
-  24-Hour Concierge
-  0.4 MI South Quay

Sizable one bedroom apartment located within this Galliard Homes development. Features include a bright open plan living / dining area, fully fitted and integrated kitchen, double bedroom, stylish modern bathroom suite and private balcony. and Elizabeth lines 0.5 miles away.

Indescon Square has 24-hour concierge and is located close to local shops and services and less than 1/2 mile from the heart of Canary Wharf. The apartment is sold with the benefit of underground parking, but should you prefer to use public transport there are excellent links with South Quay DLR 0.2 miles away and the Canary Wharf Jubilee

Local Authority:	Tower Hamlets
Council Tax Band:	D
EPC:	C
Security deposit:	equivalent to 5 weeks' rent



Floorplan

418 sq ft | 38.85 sq m

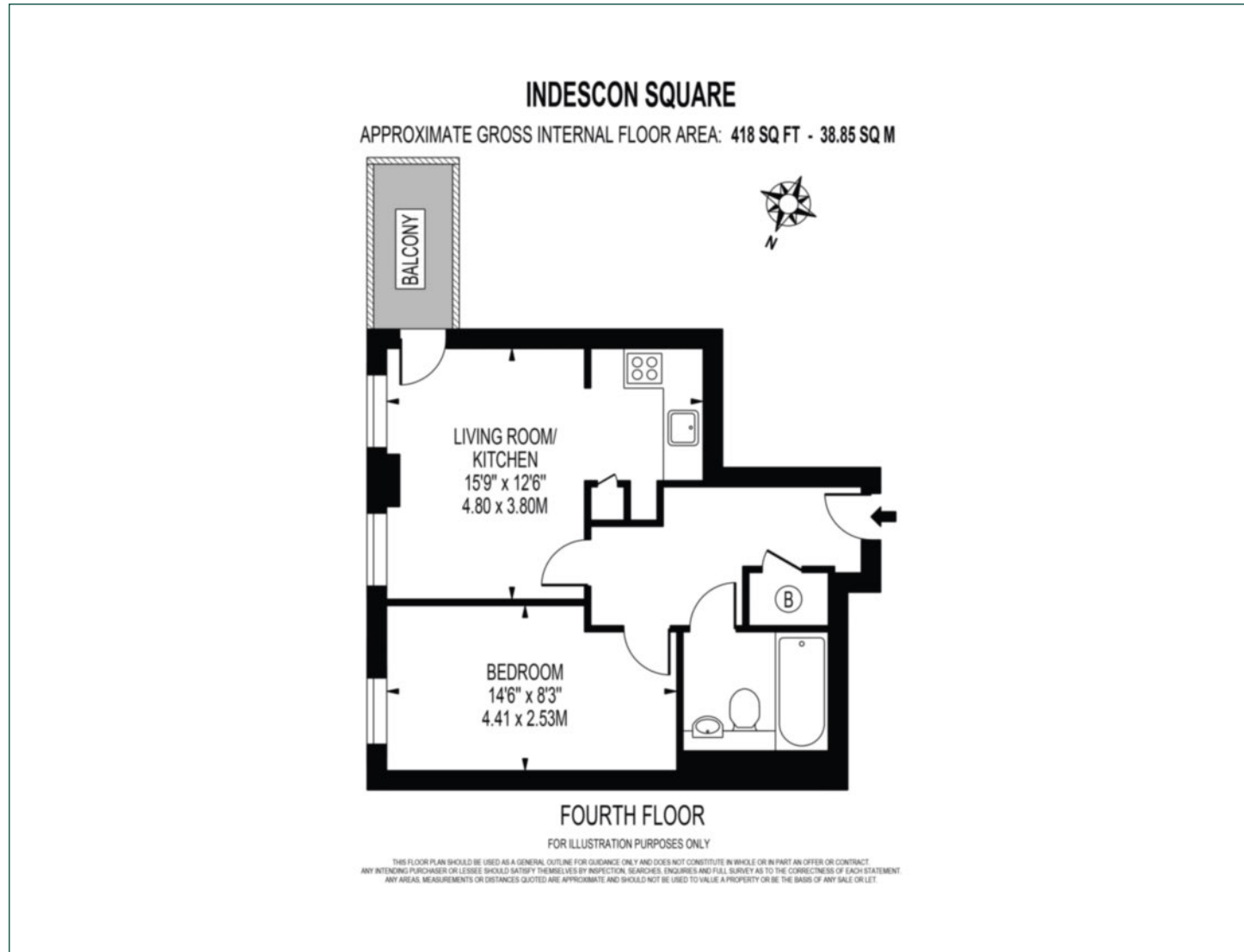

Pan Peninsula

Pan Peninsula, 1 Millharbour, London, E14 9XP

Lettings

020 7536 7900 | panp.lettings@chaseevans.com

We're here to help.

IMPORTANT NOTICE - These particulars have been prepared in good faith and they are not intended to constitute part of an offer or contract. We have not performed a structural survey on this property and the services, appliances and specific fittings have not been tested. All photographs, measurements, floor plans and distances referred to are given as a guide and should not be relied upon.

[chaseevans.com](https://www.chaseevans.com)