



Indescon Square, Canary Wharf, E14

Price **£410 per week** | Furnished



Indecon Square, Canary Wharf, E14



Studio



1 Bathroom



1 Reception



Local Restaurants



24-Hour Concierge



0.3 MI Canary Wharf Station

Modern studio suite set within the impressive Indecon Square development E14 located close to South Quay DLR and within easy reach of Canary Wharf. Features a large living room with an open plan modern kitchen with integrated appliances, wood flooring, large glazing spacious sleeping area and tiled bathroom with smart shower fixtures.

Residents also have access to a 24-hour concierge service. The development is located near South Quay DLR and is a short walk away from all the amenities of Canary Wharf, providing several transport links for easy commutes to key locations

all over London. Amenities are plentiful which include bars, restaurants and the Canary Wharf Shopping Centre.

Local Authority: Tower Hamlets Council

Council Tax Band: B

EPC: C

Security deposit: equivalent to 5 weeks' rent

Floorplan

359 sq ft | 32.9 sq m

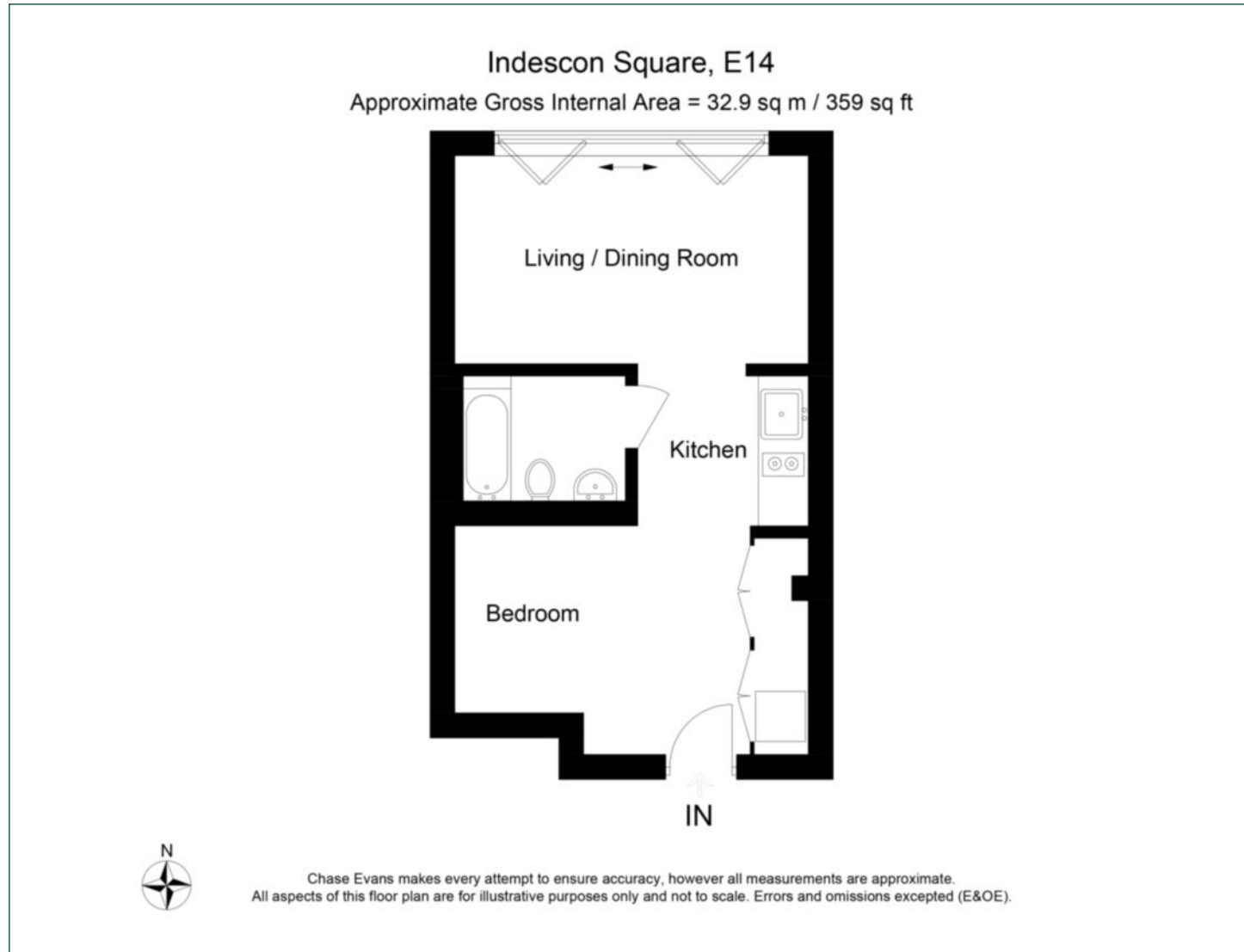

Pan Peninsula

Pan Peninsula, 1 Millharbour, London, E14 9XP

Lettings

020 7536 7900 | panp.lettings@chaseevans.co.uk

We're here to help.

IMPORTANT NOTICE - These particulars have been prepared in good faith and they are not intended to constitute part of an offer or contract. We have not performed a structural survey on this property and the services, appliances and specific fittings have not been tested. All photographs, measurements, floor plans and distances referred to are given as a guide and should not be relied upon.

[chaseevans.com](https://www.chaseevans.com)