



West Tower, Pan Peninsula, Canary Wharf, E14

Price **£725 per week** | Furnished



West Tower, Pan Peninsula, Canary Wharf, E14



2 Bedrooms



2 Bathrooms



1 Reception



Balcony



Gymnasium



Local Amenities



24-Hour Concierge



0.1 MI South Quay

An attractive and elegant, dual aspect north-west facing two bedroom, two bathroom apartment with a balcony set within the popular Pan Peninsula development. The spectacular open plan living space incorporates a modern, semi enclosed kitchen, featuring dual aspect views, floor-to-ceiling windows and access to a private balcony offering far-reaching views of Canary Wharf. There are two sizeable bedrooms, master with en suite and built-in wardrobes and a further marble bathroom.

Residents have access to a 24-hour concierge, an onsite private cinema, residents' gymnasium,

swimming pool and sauna. The development is within walking distance of Canary Wharf, providing access to transport links and a great selection of amenities including the Canary Wharf Shopping Centre.

Situated just a 2-min walk from South Quay DLR station which makes commutes to areas such as Bank achievable in just 14 mins. The development is also within walking distance of Canary Wharf Underground and the Elizabeth Line service for high-speed connection pan throughout the capital.

Local Authority:

Tower Hamlets

Council Tax Band:

G

EPC:

B

Security deposit:

equivalent to 5 weeks' rent

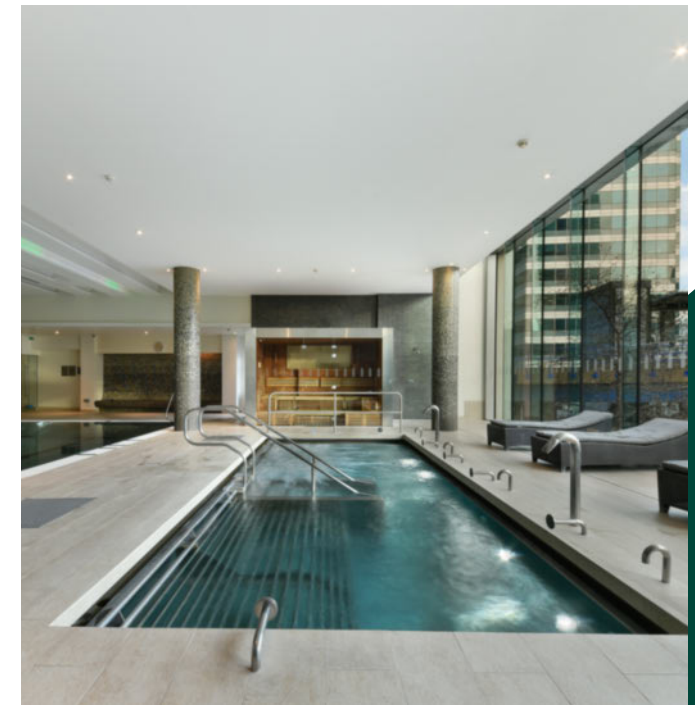
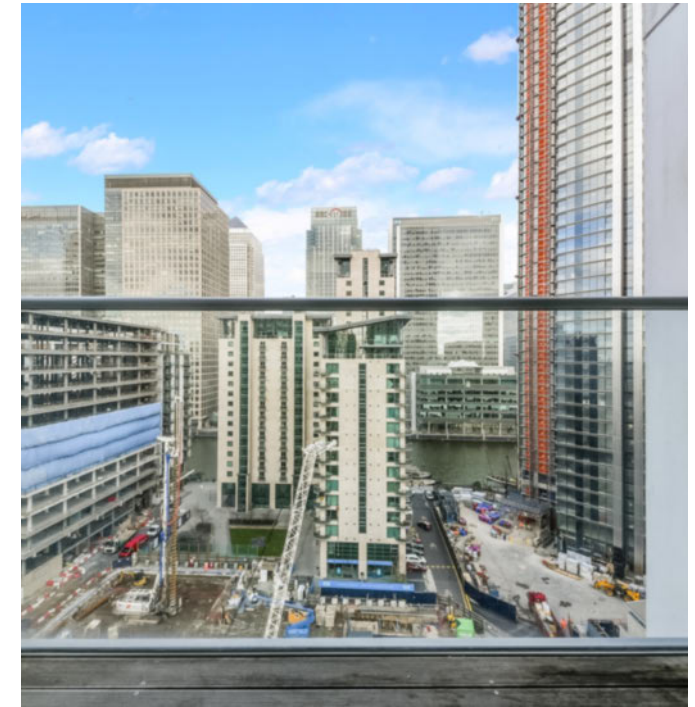

Floorplan

794 sq ft | 73.8 sq m

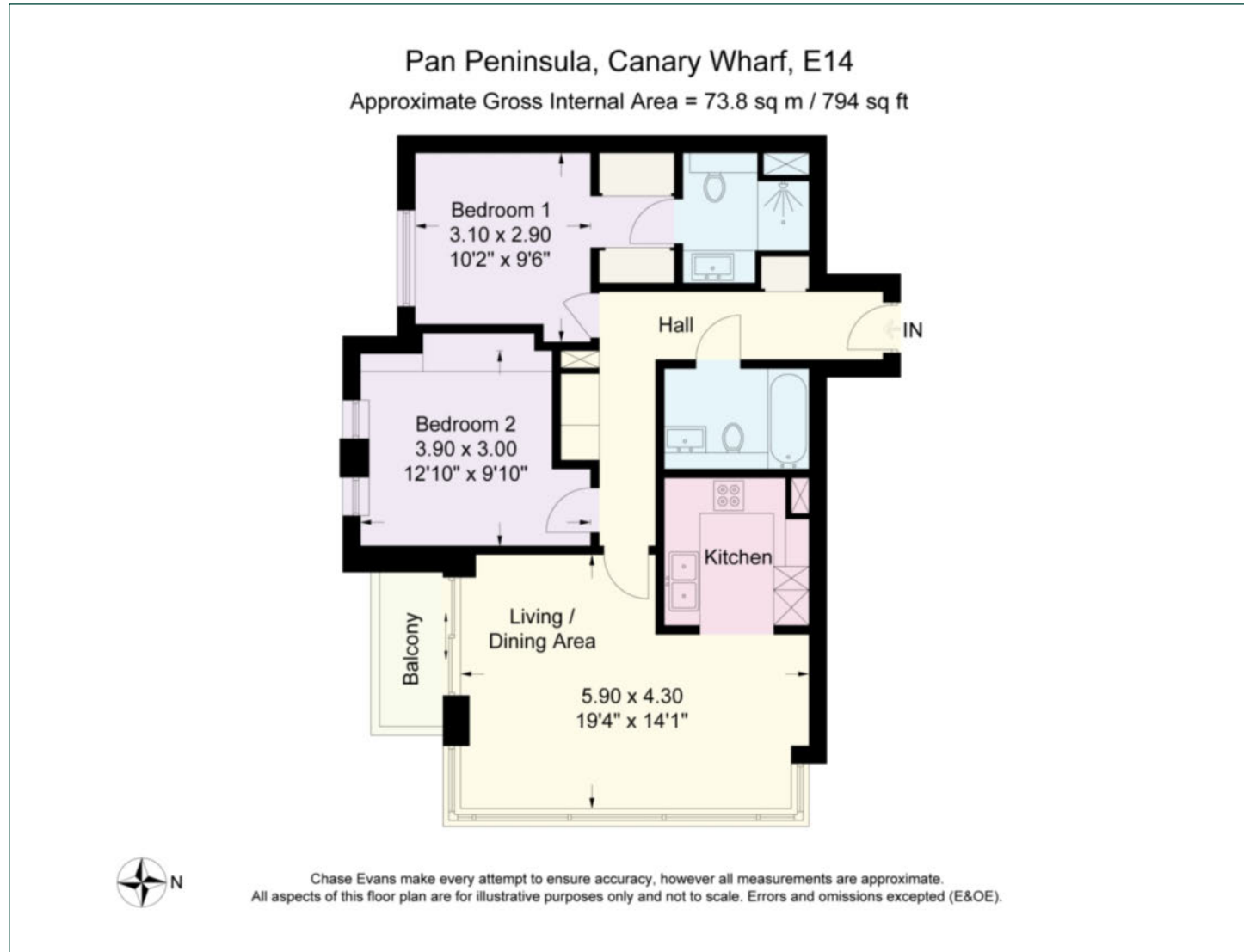

Pan Peninsula

Pan Peninsula, 1 Millharbour, London, E14 9XP

Lettings

020 7536 7900 | panp.lettings@chaseevans.co.uk

We're here to help.

IMPORTANT NOTICE - These particulars have been prepared in good faith and they are not intended to constitute part of an offer or contract. We have not performed a structural survey on this property and the services, appliances and specific fittings have not been tested. All photographs, measurements, floor plans and distances referred to are given as a guide and should not be relied upon.

chaseevans.com