











North Boulevard, Baltimore Wharf, Canary Wharf, E14

Price **£515 per week** | Furnished



North Boulevard, Baltimore Wharf, Canary Wharf, E14

-  1 Bedroom
-  1 Bathroom
-  1 Reception
-  Balcony
-  Gymnasium
-  Swimming Pool
-  Local Amenities
-  24-Hour Concierge
-  0.1 MI Crossharbour

Modern one bedroom apartment with a balcony is set within Baltimore Wharf, a contemporary waterside development close to Canary Wharf.

Features extensive glazing opening onto the balcony, fitted kitchen with integrated appliances, floor to ceiling glazing, wood flooring, large bedroom with built-in wardrobe, marble effect bathroom with underfloor heating, recessed lighting.

Residents will also have access to a 24-hour concierge service and an on-site gymnasium & swimming pool. There are several amenities located nearby including restaurants, bars and the Canary Wharf Shopping Centre.

Baltimore Wharf is located 2mins walk from Crossharbour DLR stop and within walking distance of Canary Wharf's Underground station for DLR and Jubilee line services.

Local Authority:	Tower Hamlets
Council Tax Band:	D
EPC:	C
Security deposit:	equivalent to 5 weeks' rent

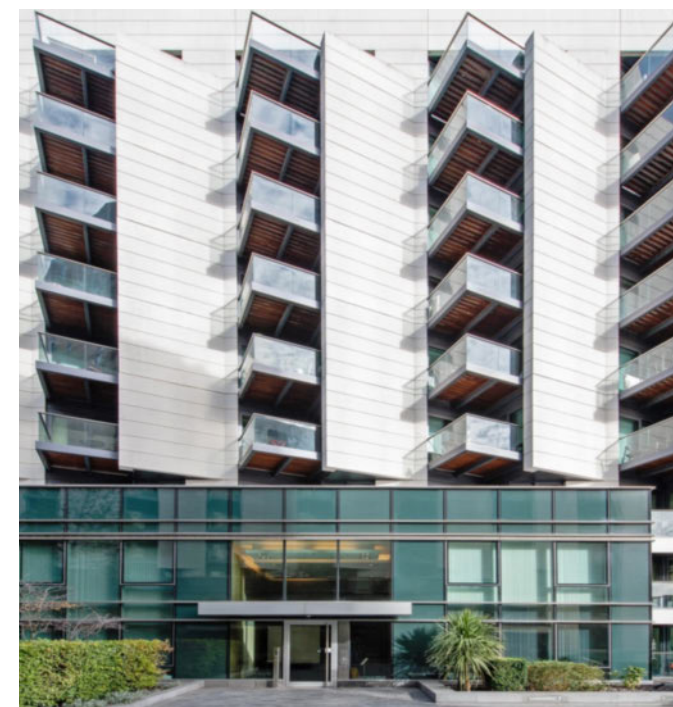

Floorplan

473 sq ft | 43.94 sq m

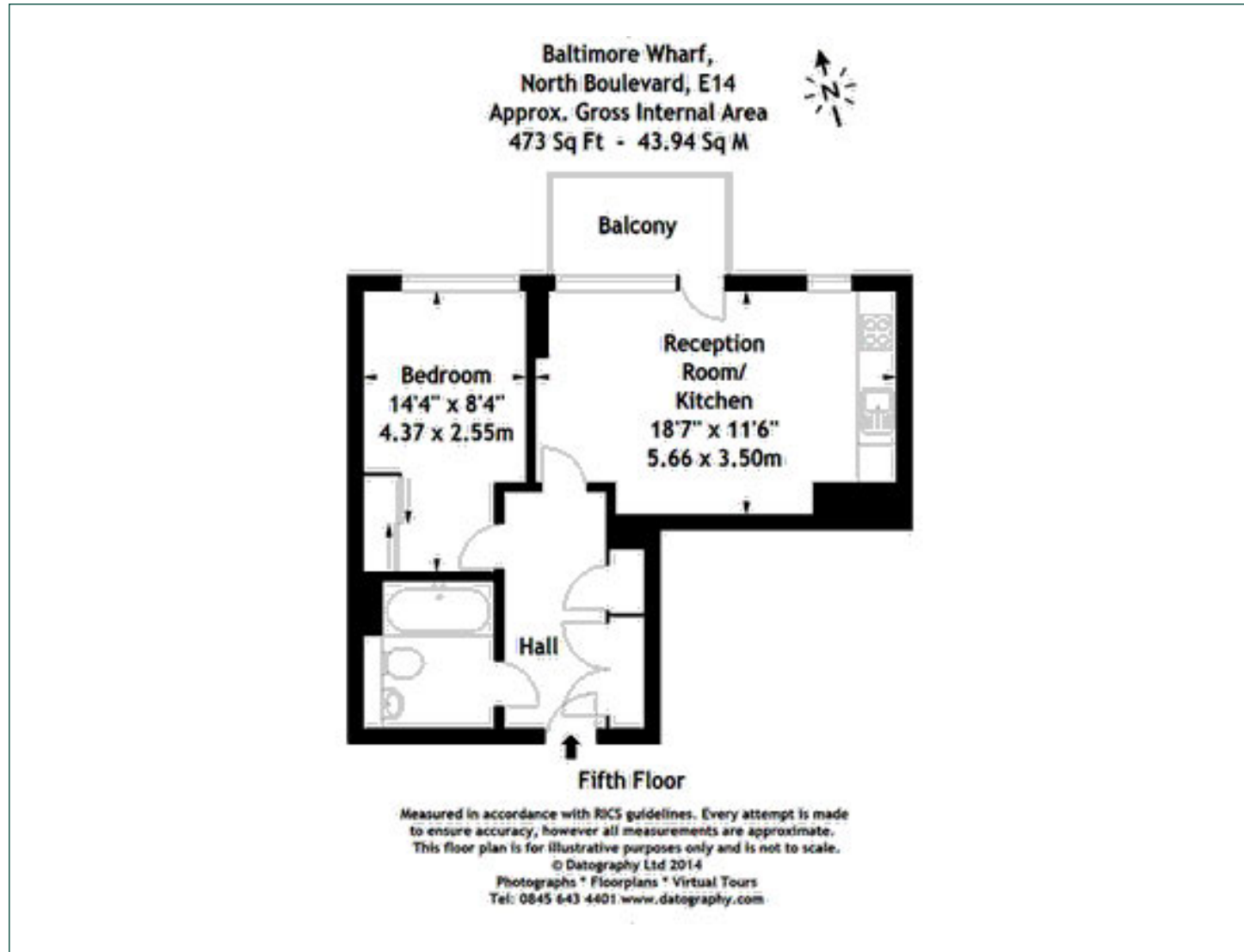

Pan Peninsula

Pan Peninsula, 1 Millharbour, London, E14 9XP

Lettings

020 7536 7900 | panp.lettings@chaseevans.co.uk

We're here to help.

IMPORTANT NOTICE - These particulars have been prepared in good faith and they are not intended to constitute part of an offer or contract. We have not performed a structural survey on this property and the services, appliances and specific fittings have not been tested. All photographs, measurements, floor plans and distances referred to are given as a guide and should not be relied upon.

chaseevans.com