



## Landmark Pinnacle, Marsh Wall, Canary Wharf, E14

Price **£700 per week** | Furnished





# Landmark Pinnacle, Marsh Wall, Canary Wharf, E14



1 Bedroom



1 Bathroom



1 Reception



Winter Garden



Gymnasium



Local Amenities



24-Hour Concierge



0.3 MI Canary Wharf

Large one bedroom apartment in this stunning landmark riverside development set in the heart of Canary Wharf, E14. This stunning property comprises a bright living area, a private winter garden with great river and city views, a semi-separate fully integrated kitchen, wood flooring, a sizable bedroom with fitted wardrobes and a modern bathroom suite with smart fittings and fixtures.

Facilities include a 24-hour concierge, access to children's play area and garden, private dining and meeting rooms, residents' lounge and library, gym

and studio, a private cinema- media room as well as the use of electric car charging point and secure bicycle storage. The nearest station is Heron Quays DLR. The Underground station at Canary Wharf (Jubilee line) is a short walk away as is the Elizabeth line station at North Dock.

**Local Authority:**

Tower Hamlets

**Council Tax Band:**

E

**EPC:**

B

**Security deposit:**

equivalent to 5 weeks' rent



# Floorplan

645 sq ft | 59.9 sq m

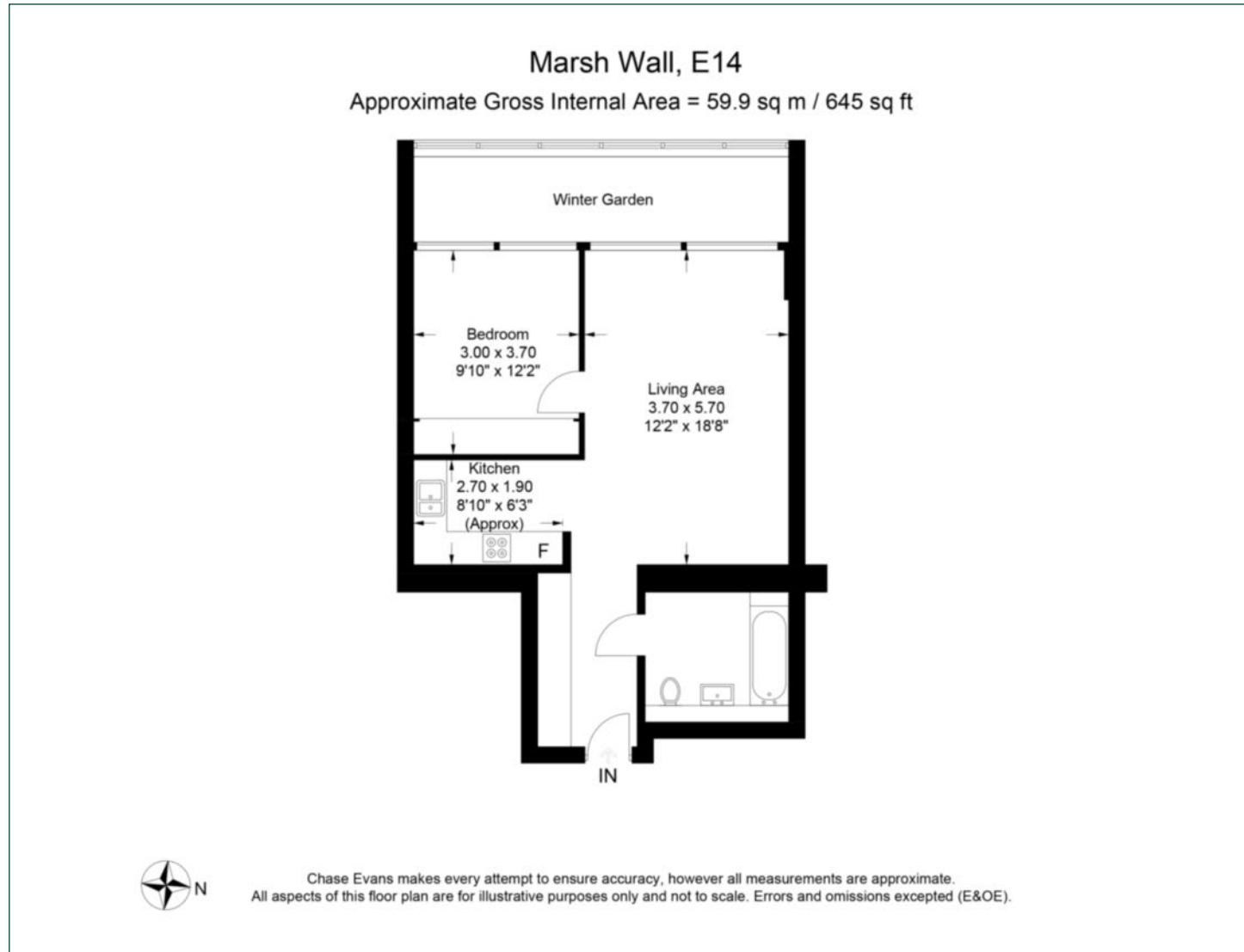

## Lettings

### We're here to help.

IMPORTANT NOTICE - These particulars have been prepared in good faith and they are not intended to constitute part of an offer or contract. We have not performed a structural survey on this property and the services, appliances and specific fittings have not been tested. All photographs, measurements, floor plans and distances referred to are given as a guide and should not be relied upon.

[chaseevans.com](http://chaseevans.com)