









Baltimore Wharf, Oakland Quay, Canary Wharf, E14

Price **£440 per week** | Furnished



Baltimore Wharf, Oakland Quay, Canary Wharf, E14

-  Studio
-  1 Bathroom
-  1 Reception
-  Privates Balcony
-  Gym & Pool
-  24-Hour Concierge
-  Local Amenities
-  0.1 MI Crossharbour

A good sized studio with semi-separate sleeping area set within this popular Baltimore Wharf development, Canary Wharf E14. The property comprises an open-plan living/dining area with full height windows that open to a private balcony overlooking the Dock, a fully fitted and integrated kitchen, an inviting sleeping area with fitted wardrobe and a luxurious marble shower room suite.

Crossharbour and South Quay DLR stations, providing short and swift commute to Canary Wharf.

Residents benefit from a 24-hour concierge service, onsite gym and swimming pool. The development is situated within close proximity to both

Local Authority:	Tower Hamlets
Council Tax Band:	E
EPC:	C
Security deposit:	equivalent to 5 weeks' rent

Floorplan

345 sq ft | 32.0 sq m

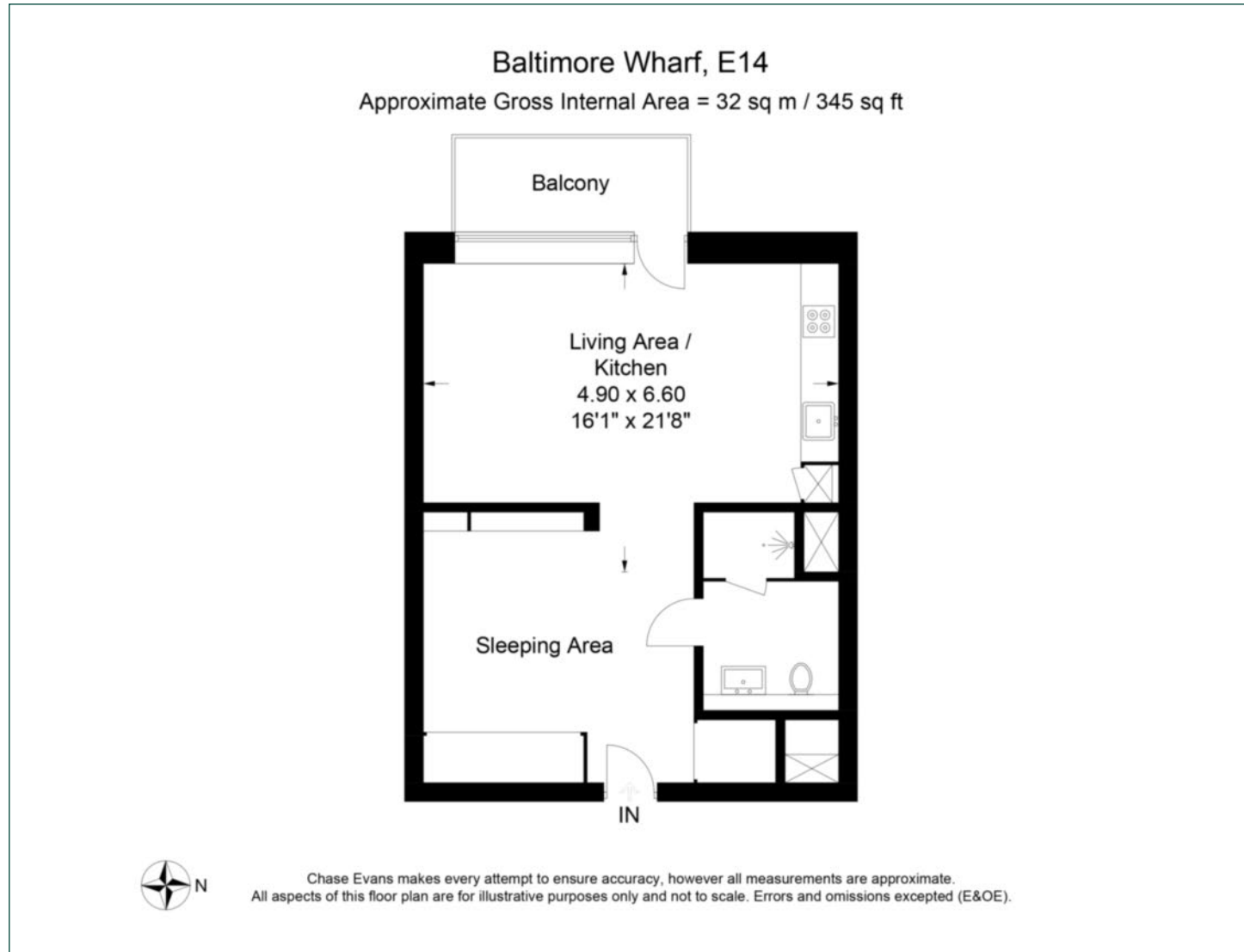

Pan Peninsula

Pan Peninsula, 1 Millharbour, London, E14 9XP

Lettings

020 7536 7900 | panp.lettings@chaseevans.com

We're here to help.

IMPORTANT NOTICE - These particulars have been prepared in good faith and they are not intended to constitute part of an offer or contract. We have not performed a structural survey on this property and the services, appliances and specific fittings have not been tested. All photographs, measurements, floor plans and distances referred to are given as a guide and should not be relied upon.

chaseevans.com

 Chase Evans