



West Tower, Pan Peninsula, Canary Wharf, E14

Price **£425 per week** | Furnished



West Tower, Pan Peninsula, Canary Wharf, E14



Studio



1 Bathroom



1 Reception



Private Balcony



24-Hour Concierge



Gymnasium



Swimming Pool



Local Amenities



0.2 MI South Quay

Modern studio apartment with a balcony located in Pan Peninsula's West Tower. Featuring flexible living space with a semi-separate sleeping and living areas, fitted kitchen with modern appliances and a marble tiled bathroom. There is good storage, tiled flooring, floor-to-ceiling windows, comfort cooling, and a balcony with views towards Canary Wharf's skyline.

Located a stone's throw from South Quay DLR station, Pan Peninsula provides residents with 24-hour concierge services, access to a private cinema and fitness facilities including a gym and a

swimming pool. The development is within walking distance of Canary Wharf, providing access to Tube and forthcoming Crossrail transport links and a great selection of amenities including the Canary Wharf Shopping Centre.

Local Authority: Tower Hamlets

Council Tax Band: E

EPC: C

Security deposit: equivalent to 5 weeks' rent



Floorplan

323 sq ft | 30 sq m

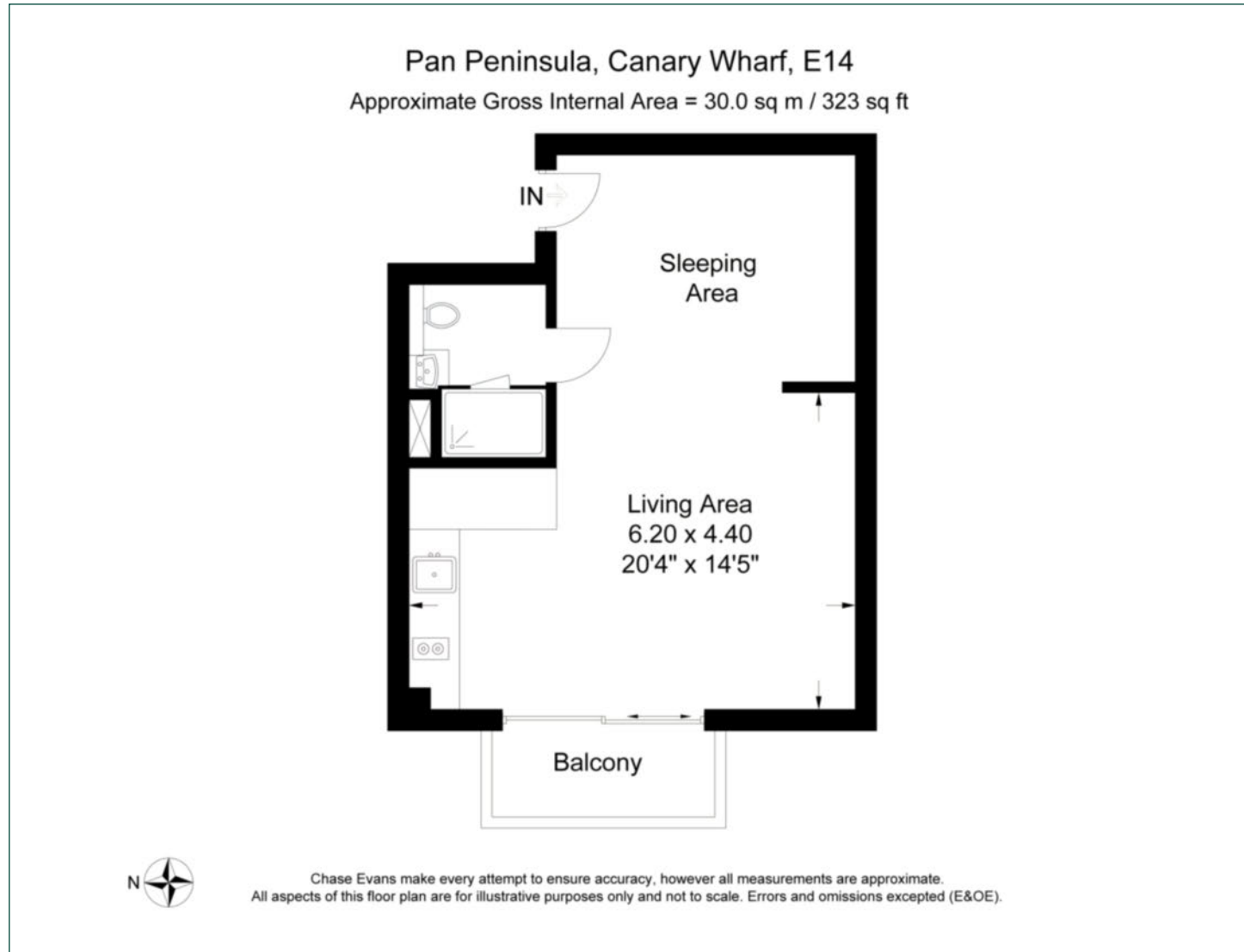

Pan Peninsula

Pan Peninsula, 1 Millharbour, London, E14 9XP

Lettings

020 7536 7900 | panp.lettings@chaseevans.co.uk

We're here to help.

IMPORTANT NOTICE - These particulars have been prepared in good faith and they are not intended to constitute part of an offer or contract. We have not performed a structural survey on this property and the services, appliances and specific fittings have not been tested. All photographs, measurements, floor plans and distances referred to are given as a guide and should not be relied upon.

[chaseevans.com](https://www.chaseevans.com)

 Chase Evans