



Hampton Tower, South Quay Plaza, Marsh Wall, Canary Wharf, E14

Price **£675 per week** | Furnished



Hampton Tower, South Quay Plaza, Marsh Wall, Canary Wharf, E14



1 Bedroom



1 Bathroom



1 Reception



Gymnasium



Local Amenities



Concierge Service



0.1 MI South Quay

Modern one bedroom apartment in SQP, a breath-taking 68 storey dockside development in Canary Wharf. Features include extensive glazing, underfloor heating, comfort cooling, lightwood engineered flooring, high-quality integrated kitchen appliances, porcelain tiled bathroom, fibre optic infrastructure and home automation for controlling heating and lighting.

The Quay Club is part of the development which secures access to the screening room, private dining room, 56 floor bar and terrace, and entry into the first and second floor leisure & health club with

gym facilities and a 20m swimming pool. The development occupies an enviable waterside location, a stone's throw from the very heart of Canary Wharf and its financial district.

The nearest station is South Quay DLR, just a stroll from the development. South Quay Plaza is a new homes development by Berkeley designed by Foster & Partners, the award-winning British and global architectural design and engineering firm.

Local Authority:	Tower Hamlets
Council Tax Band:	F
EPC:	B
Security deposit:	equivalent to 5 weeks' rent

Floorplan

658 sq ft | 61.1 sq m

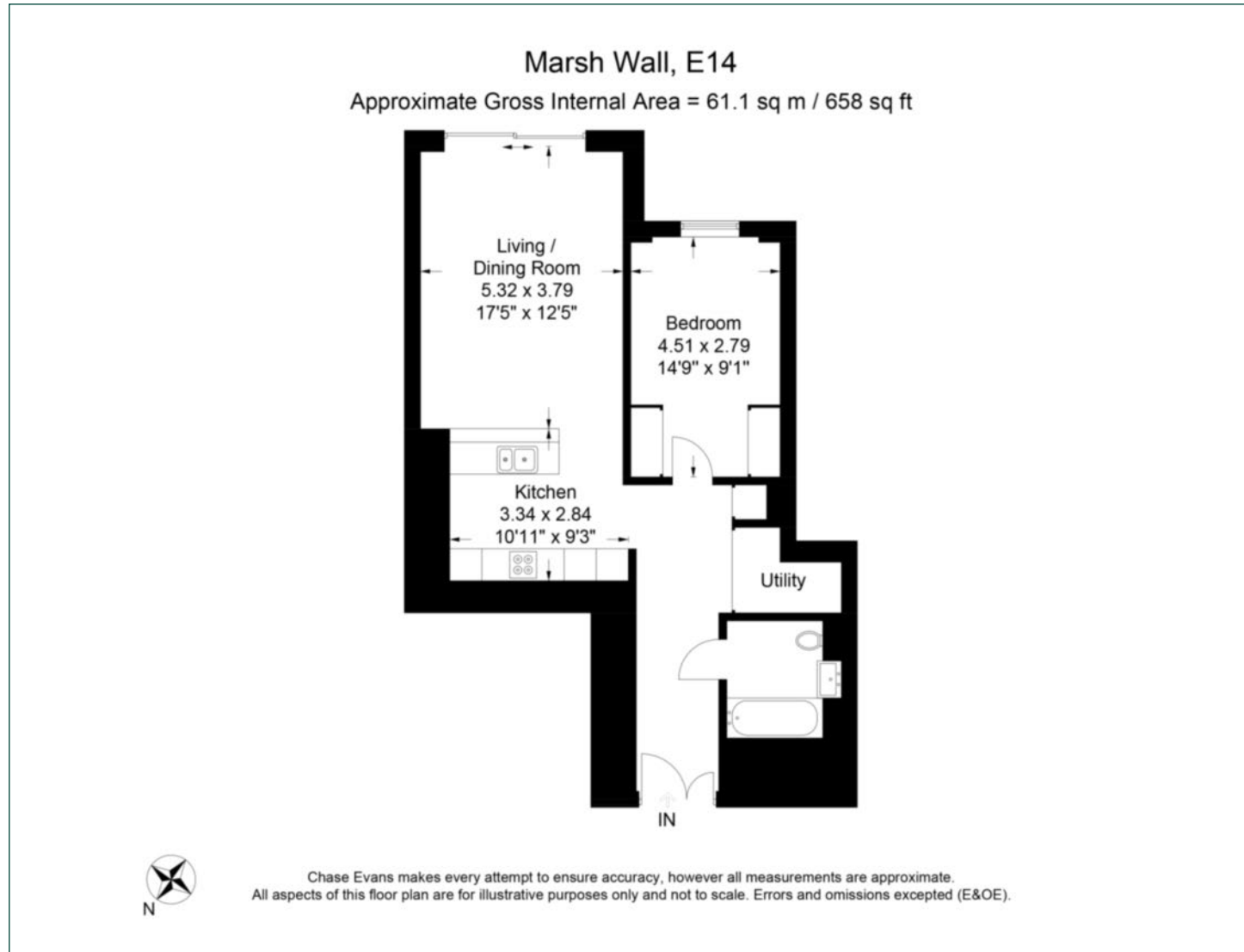

Pan Peninsula

Pan Peninsula, 1 Millharbour, London, E14 9XP

Lettings

020 7536 7900 | panp.lettings@chaseevans.com

We're here to help.

IMPORTANT NOTICE - These particulars have been prepared in good faith and they are not intended to constitute part of an offer or contract. We have not performed a structural survey on this property and the services, appliances and specific fittings have not been tested. All photographs, measurements, floor plans and distances referred to are given as a guide and should not be relied upon.

chaseevans.com