



## East Tower, Pan Peninsula Square, Canary Wharf, E14

Price **£575 per week** | Furnished



# East Tower, Pan Peninsula Square, Canary Wharf, E14



1 Bedroom



1 Bathroom



1 Reception



Balcony



Gymnasium



Local Amenities



24-Hour Concierge



0.1 MI South Quay

*\*PHOTOS FOR ILLUSTRATIVE PURPOSES ONLY\**

A well appointed apartment set in the East Tower of Pan Peninsula. The property offers a spacious living area with superb views from the balcony, wood flooring and furnishings. This also features comfort cooling, fitted wardrobe in the bedroom, fitted kitchen/appliances and a modern bathroom suite.

Residents will also have access to a 24-hour concierge, an onsite private cinema, residents' gymnasium and swimming pool. The development is within walking distance of Canary Wharf,

providing access to transport links and a great selection of amenities including the Canary Wharf Shopping Centre.

Situated just a 2-mins walk from South Quay DLR station which makes commutes to areas such as Bank achievable in just 14-mins. The development is also within walking distance of Canary Wharf Underground and the Elizabeth Line service for high-speed connection pan throughout the Capital.

<b>Local Authority:</b>	Tower Hamlets
<b>Council Tax Band:</b>	F
<b>EPC:</b>	B
<b>Security deposit:</b>	equivalent to 5 weeks' rent



# Floorplan

496 sq ft | 46.1 sq m

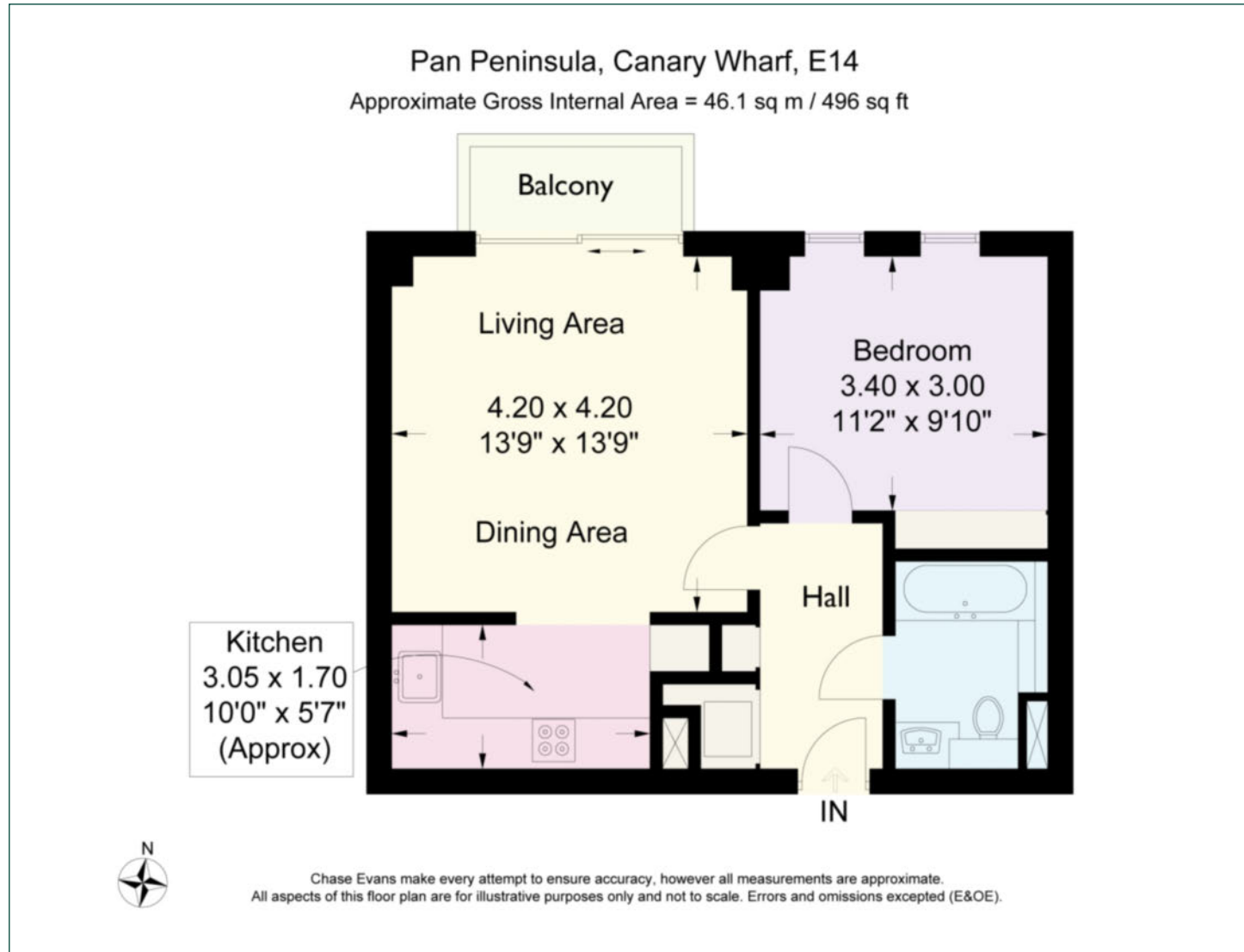

## Pan Peninsula

Pan Peninsula, 1 Millharbour, London, E14 9XP

## Lettings

020 7536 7900 | [panp.lettings@chaseevans.com](mailto:panp.lettings@chaseevans.com)

## We're here to help.

IMPORTANT NOTICE - These particulars have been prepared in good faith and they are not intended to constitute part of an offer or contract. We have not performed a structural survey on this property and the services, appliances and specific fittings have not been tested. All photographs, measurements, floor plans and distances referred to are given as a guide and should not be relied upon.

[chaseevans.com](https://www.chaseevans.com)

 Chase Evans