



## Discovery Dock East, South Quay Square, Canary Wharf, E14

Asking price **£775,000** | Leasehold



# Discovery Dock East, South Quay Square, Canary Wharf, E14



2 Bedrooms



2 Bathrooms



1 Reception



Balcony



Gymnasium



Local Amenities



24-Hour Concierge



0.2 MI South Quay

A large two bed, two bath duplex apartment with parking arranged over 1,168 sq ft on the top floors of a modern dockside development located within easy reach of Canary Wharf.

Features include two reception rooms and a private balcony affording stunning views over the Canary Wharf Estate and South Dock. There is a well equipped semi open plan kitchen, two double bedrooms with the main bedroom benefiting from an en-suite and a family bathroom with contemporary fittings.

Residents have access to 24-hour concierge and an onsite gymnasium and swimming pool. The property is located close to the shops, amenities and eateries of Canary Wharf and has excellent transport links with South Quay DLR being moments away and the Jubilee and Elizabeth line stations being close by.

**Tenure:** Leasehold (978 years remaining)

**Local Authority:** Tower Hamlets

**Ground Rent:** N/A

**Council Tax Band:** F

**Service Charge:** £11,200 p.a.

**EPC:** C



# Floorplan

1,168 sq ft

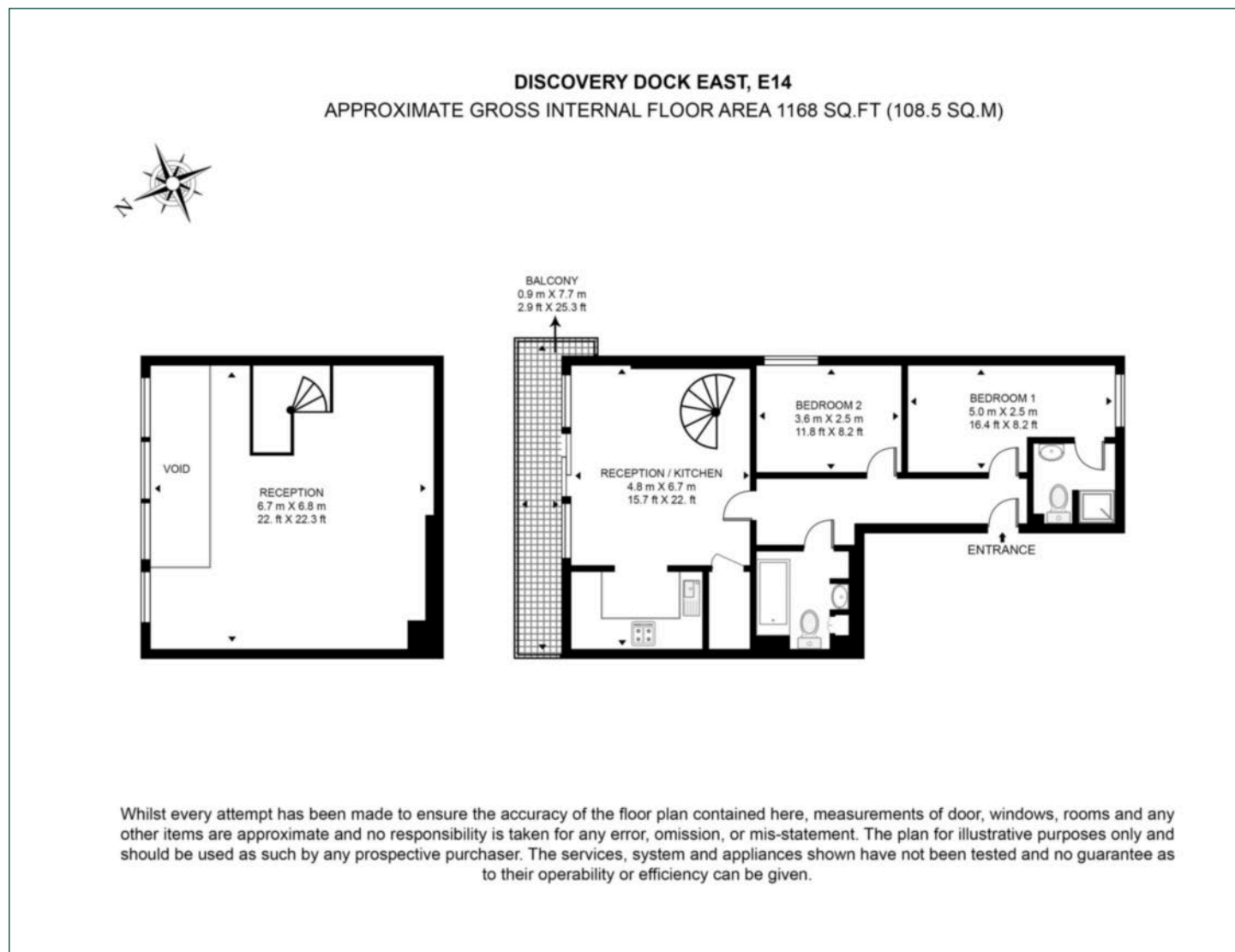

## Pan Peninsula

Pan Peninsula, 1 Millharbour, London, E14 9XP

## Sales

020 7536 7901 | [panp.sales@chaseevans.com](mailto:panp.sales@chaseevans.com)

## We're here to help.

IMPORTANT NOTICE - These particulars have been prepared in good faith and they are not intended to constitute part of an offer or contract. We have not performed a structural survey on this property and the services, appliances and specific fittings have not been tested. All photographs, measurements, floor plans and distances referred to are given as a guide and should not be relied upon.

[chaseevans.com](http://chaseevans.com)

 Chase Evans