



Fitzroy Close, £315,000

- Popular location
- Driveway and Garage
- Versatile Living accommodation
- Extensive Paved Terrace and garden
- Well presented throughout
- EPC Rating: D



 2
  2
  1



About the property

Popular cul-de-sac position, enclosed lawned garden to front with superb Mediterranean style paved rear terrace, driveway and garage. Comfortable layout with easy flowing ground floor living space.

Enjoying a pleasant cul-de-sac setting, conveniently located for those seeking level walking distance to local shop and nearby Town centre. Dual aspect approach, via gate from footway into the attractive enclosed lawned garden to front, with side pathway leading around to the extensive paved terrace to rear. A particular feature of the property is the superb low maintenance paved rear garden, with raised planted beds creating interest. Offering a degree of privacy, set towards the far end is a covered area, ideal for entertaining. There is a service door to the detached Garage and pedestrian side gate leading through to driveway. Internally, the updated accommodation provides a comfortable layout with easy flowing ground floor living space. Approached via the side Entrance Porch, with door leading into the Hallway, which in turn opens into the Sitting Room, with substantial sized window and French doors to front aspect and wood effect flooring.. Ground floor Shower Room. Kitchen with range of modern fitted base and wall units comprising cupboards and drawers, with stunning work tops having ergonomically designed curved edges. Appliances including oven, hob and Dishwasher. Extending through to the delightful Sun Room with French doors opening out to the Garden. On the First Floor, two double Bedrooms and useful Study/child's Bedroom, approached off the Bathroom, impressive suite with free standing roll top bath with claw feet, vanity unit with basin, wc. - Must view.





Accommodation

Entrance Porch

Shower Room

Sitting Room

15' 10" x 11' 2" (4.83m x 3.40m)

Kitchen

15' 1" x 9' 10" (4.60m x 3.00m)

Garden Room

14' 2" x 10' (4.32m x 3.05m)

Bedroom One

12' 9" plus recess x 10' 5" (3.89m plus recess x 3.17m)

Bedroom Two

8' 6" x 7' 8" (2.59m x 2.34m)

Bathroom

Bedroom Three/Study

7' x 5' 7" (2.13m x 1.70m)

Floorplan

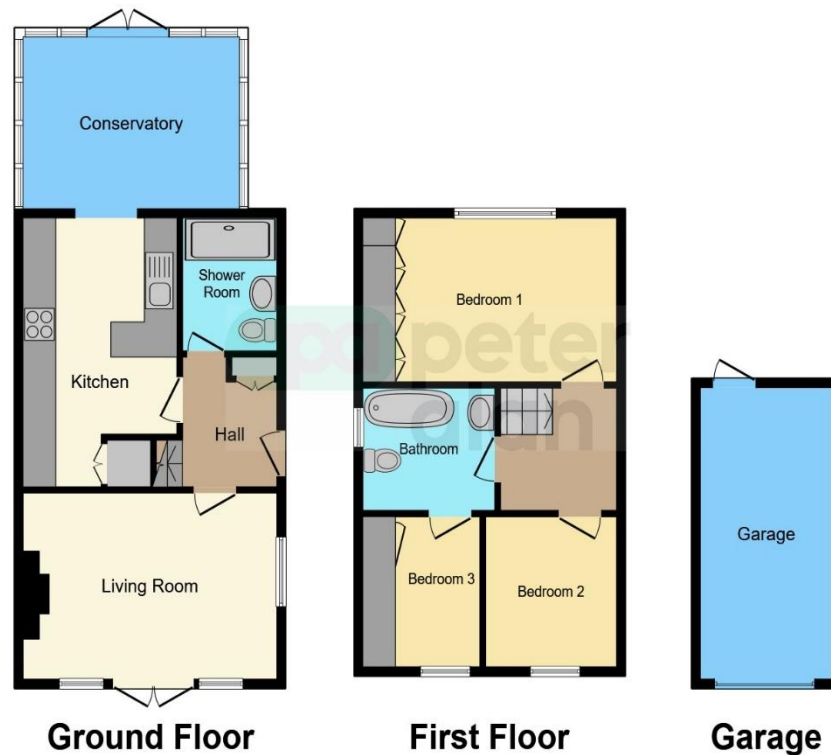

This floor plan is for illustrative purposes only. It is not drawn to scale. Any measurements, floor areas (including any total floor area), openings and orientation are approximate. No details are guaranteed, they cannot be relied upon for any purpose and they do not form part of any agreement. No liability is taken for any error, omission or misstatement. A party must rely upon its own inspection(s). Powered by www.focalagent.com

Important Information

Note while we endeavour to make our sales details accurate and reliable, if there is any point which is of particular interest to you, please contact the office and we will be pleased to confirm the position for you. We have not personally tested any apparatus, equipment, fixtures, fittings or services and cannot verify they are in working order or fit for their purposes. Nothing in these particulars is intended to indicate that carpets or curtains, furnishings or fittings, electrical goods (whether wired or not). Gas fires or light fittings or any other fixtures not expressly included form part of the property offered for sale. This computer generated Floorplan, if applicable, is intended as a general guide to the layout and design of the property. It is not to scale and should not be relied upon for dimensions. Tenure: We cannot confirm the tenure of the property as we have not had access to the legal documents. The buyer is advised to obtain verification from their solicitor or surveyor.

Peter Alan Limited is registered in England and Wales under company number 2073153, Registered Office is Cumbria House, 16-20 Hockliffe Street, Leighton Buzzard, Bedfordshire, LU7 1GN. VAT Registration Number is 500 2481 05. For activities relating to regulated mortgages and non-investment insurance contracts, Peter Alan Limited is an appointed representative of Connells Limited which is authorised and regulated by the Financial Conduct Authority. Connells Limited's Financial Services Register number is 302221. Most buy-to-let