



Holman Road

Epsom

£525,000

Holman Road

Epsom

- Four Bedroom
- Wrap Around Garden
- Off Street Parking
- Close to Ofsted Outstanding School
- Close To Local Supermarket and Shops

Kaybridge are delighted to introduce this four-bedroom end-of-terrace house nestled within a peaceful residential neighbourhood. This stunning property features a charming wrap-around garden.

As you step inside, you are greeted by a spacious Hallway leading onto the living/dining room, adorned with natural light through the large windows, creating a warm and inviting space. The layout effortlessly combines the dining area, ideal for entertaining guests. Just off the hallway you will be greeted with a inviting bathroom with storage, bath and overhead shower.

The kitchen boasts ample amounts of storage and counter space throughout. Also having a large pantry space for dry goods.

Moving upstairs, the property offers four well-proportioned bedrooms three that are double bedrooms and one single, each providing ample amounts of space

Moreover, this residence benefits from a central location, offering easy access to a range of local amenities, schools, and excellent transport links. With its impeccable blend of space, style, and functionality, this four-bedroom end-of-terrace





Holman Road

Epsom

Stunning 4-bed end-of-terrace with charming wrap-around garden. Spacious hallway, light-filled living/dining area, inviting bathroom, ample kitchen storage. Four well-proportioned bedrooms. Central location with easy access to amenities and schools. Perfect family home.

Council Tax band: D

Tenure: Freehold



Holman Road, Epsom, KT19

Approximate Area = 956 sq ft / 88.8 sq m

For identification only - Not to scale

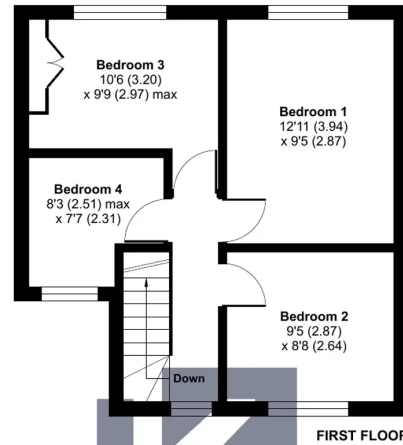

FIRST FLOOR

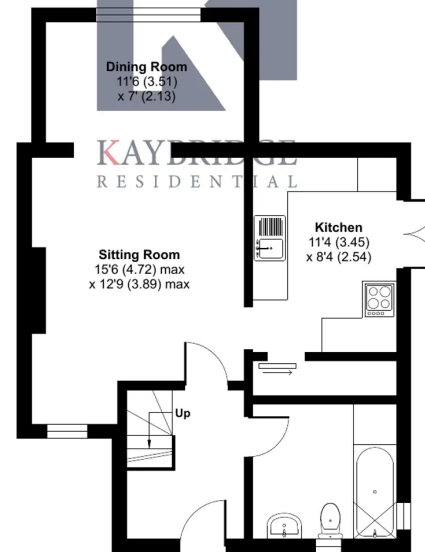

GROUND FLOOR



Floor plan produced in accordance with RICS Property Measurement Standards incorporating International Property Measurement Standards (IPMS2 Residential). ©nichecom 2023. Produced for Kaybridge Residential Ltd. REF: 1069504



Kaybridge Residential Epsom

Kaybridge Residential Estate Agents, 23 Stoneleigh Broadway - KT17 2JE

02080040474 • info@kbridge.co.uk • www.kaybridgeresidential.co.uk/