



34 Longthorpe Close, Swindon, SN5 8AD

Guide price £265,000

Offered for sale with no onward chain is this deceptively spacious three bedroom corner plot family home with the added benefit of a cloakroom on the ground floor. The accommodation comprises, entrance hall, lounge/diner, kitchen. To the first floor houses three bedrooms and a good size family bathroom. To the rear is a good size garden with an outbuilding and driveway parking.

The property is located within easy reach of all of West Swindon's amenities including West Swindon Shopping centre with Asda supermarket, Mannington Retail Park. It also provides great access to the Link Centre Ice rink and Swimming Pool plus Shaw Ridge Leisure Park with Multiplex cinema and Bowling Alley.

DISCLAIMER

Floor plans-These are intended as a guide only.
Dimensions are approximate. Not to scale. We have
taken every care with the preparation of these details.

Floor Plan

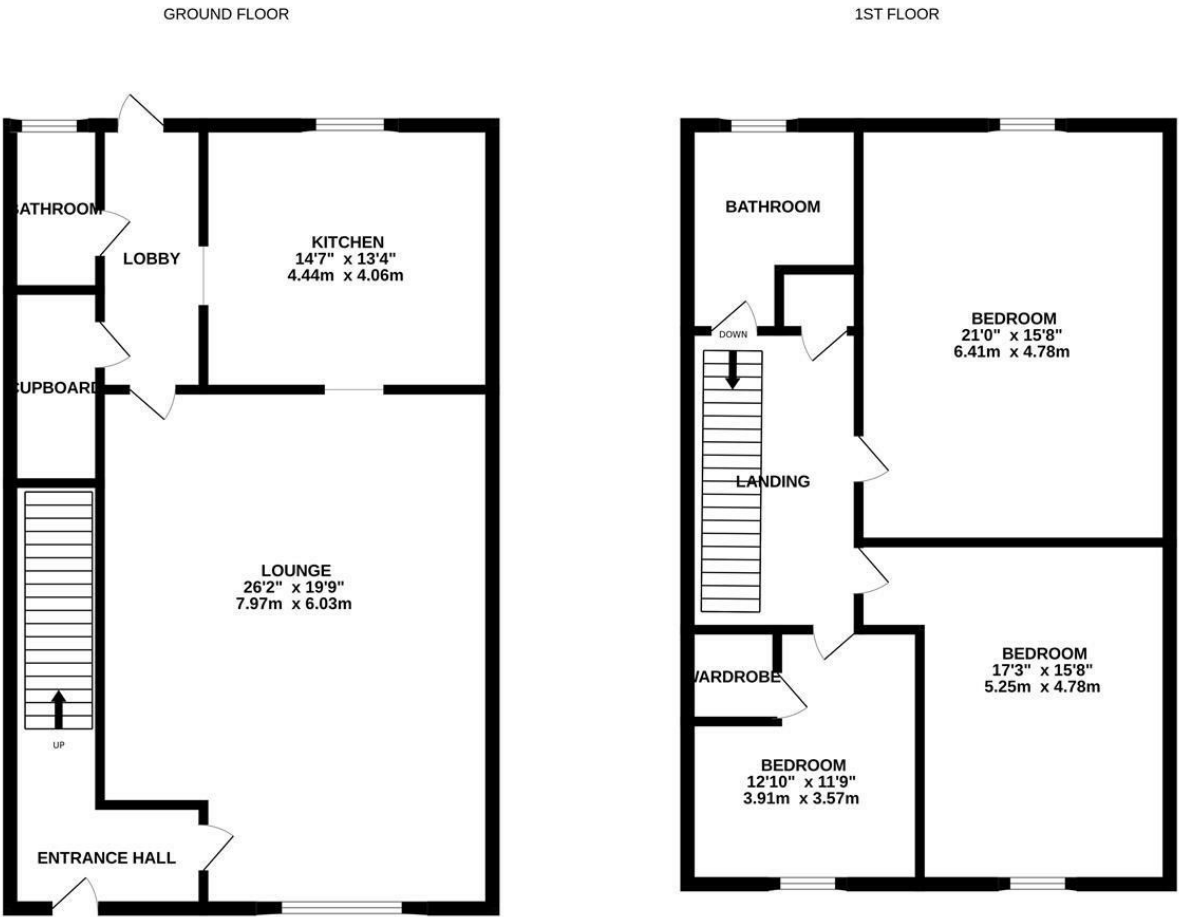

Whilst every attempt has been made to ensure the accuracy of the floorplan contained here, measurements of doors, windows, rooms and any other items are approximate and no responsibility is taken for any error, omission or mis-statement. This plan is for illustrative purposes only and should be used as such by any prospective purchaser. The services, systems and appliances shown have not been tested and no guarantee as to their operability or efficiency can be given.
Made with Metropix ©2024

Area Map



These particulars, whilst believed to be accurate are set out as a general outline only for guidance and do not constitute any part of an offer or contract. Intending purchasers should not rely on them as statements of representation of fact, but must satisfy themselves by inspection or otherwise as to their accuracy. No person in this firms employment has the authority to make or give any representation or warranty in respect of the property.

Energy Efficiency Graph

