



Apartment (EPC Rating: C)

**LUNDY HOUSE, HIMALAYAN WAY,  
WATFORD, WD18 6GS**

PCM

**£1,300 PCM**

# 1 Bedroom Apartment located in Watford

ONE BEDROOM APARTMENT IN A QUIET DEVELOPMENT JUST 0.7 MILES TO WATFORD GENERAL HOSPITAL AND CLOSE TO TOWN CENTRE - AVAILABLE FEB 2026!

This well-presented second-floor one-bedroom apartment is set within a popular and peaceful residential development, conveniently located close to local amenities, highly regarded schools, and Watford's vibrant town centre.

The property comprises a spacious double bedroom, a modern fully tiled bathroom, a good-sized living room, and a separate contemporary kitchen. Additional benefits include electric heating throughout, permit parking within the development, and access to a communal children's playground.

Offered unfurnished and available February 2026, this apartment is ideal for professionals seeking a quiet location with excellent transport links and town centre access.





WATFORD LETTINGS | 12 MARKET STREET, WATFORD, HERTFORDSHIRE, WD18 0PD

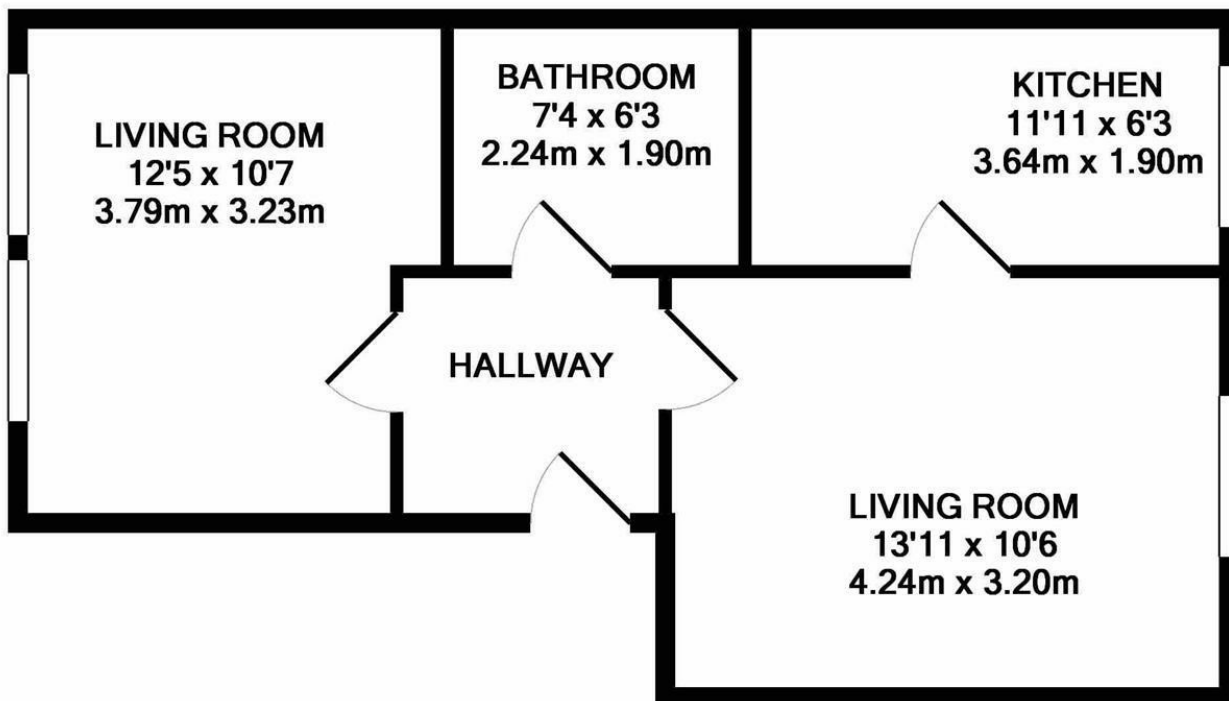

TOTAL APPROX. FLOOR AREA 431 SQ.FT. (40.1 SQ.M.)

Whilst every attempt has been made to ensure the accuracy of the floor plan contained here, measurements of doors, windows, rooms and any other items are approximate and no responsibility is taken for any error, omission, or mis-statement. This plan is for illustrative purposes only and should be used as such by any prospective purchaser. The services, systems and appliances shown have not been tested and no guarantee as to their operability or efficiency can be given

Made with Metropix ©2018

Council Tax Band

**C**

Energy Performance Graph

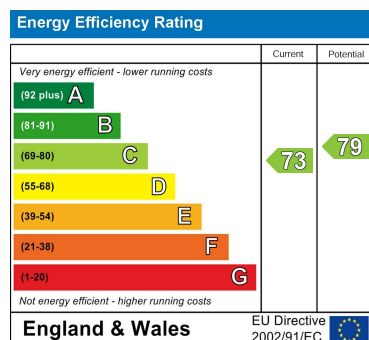

Call us on

**01923 220 012**

**enquiries@warrenanthony.co.uk**

**www.warrenanthony.co.uk**

Agents Note: Whilst every care has been taken to prepare these particulars, they are for guidance purposes only. All measurements are approximate and are for general guidance purposes only and whilst every care has been taken to ensure their accuracy, they should not be relied upon and potential buyers are advised to recheck the