

LEASEHOLD



Maisonette (EPC Rating: D)

COATES DELL, GARSTON,
HERTFORDSHIRE, WD25 9RJ

£190,000

1 Bedroom Maisonette located in Hertfordshire

• One Bedroom Ground Floor Flat • Family Bathroom • Reception Room With Open Plan Kitchen • Cul-De-Sac • Allocated Parking • Communal Garden • Garston Park Location *** Chain Free Sale ***

DESCRIPTION

COATES DELL: Ground Floor Apartment In A Quiet Location.

Set in a purpose built block, the property is entered through the main entrance into communal hallway and stairs to all floors.

Through the front door enter the hallway with storage cupboard and doors to the Reception Room, Bathroom and Bedroom.

The property has carpets fitted throughout with double glazing, gas central heating and the property is offered for sale with no upper chain.

The property has access to non-allocated off street parking, spacious communal gardens and is only a stones throw from Garston Park.

Due to its brilliant location; this ground floor flat is in close proximity to excellent schools, has easy access to the major road links of the M1 & M25 and is only a short distance to all local amenities.

LEASE: 88 years remaining
SERVICE CHARGE: £548
GROUND RENT: £10 peppercorn

Floorplan to follow.



WATFORD LETTINGS | 12 MARKET STREET, WATFORD, HERTFORDSHIRE, WD18 0PD

GROUND FLOOR

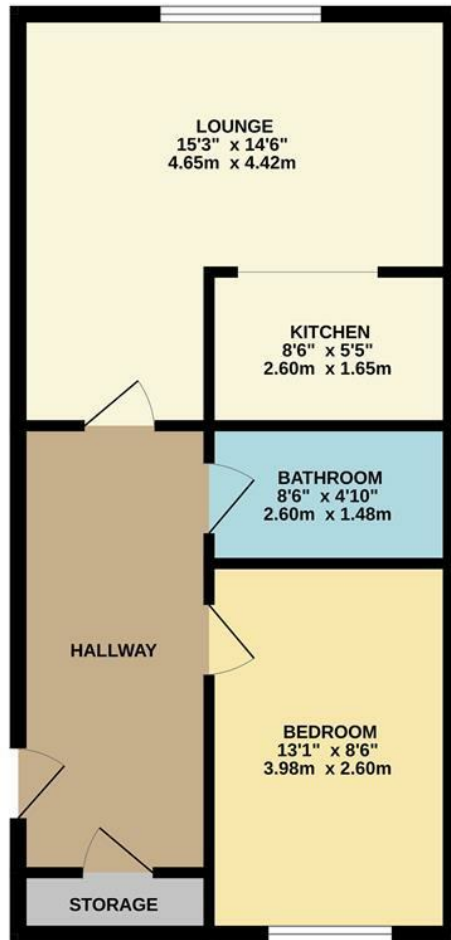

Whilst every attempt has been made to ensure the accuracy of the floorplan contained here, measurements of doors, windows, rooms and any other items are approximate and no responsibility is taken for any error, omission or mis-statement. This plan is for illustrative purposes only and should be used as such by any prospective purchaser. The services, systems and appliances shown have not been tested and no guarantee as to their operability or efficiency can be given.
Made with Metropix ©2024

Council Tax Band

D

Energy Performance Graph

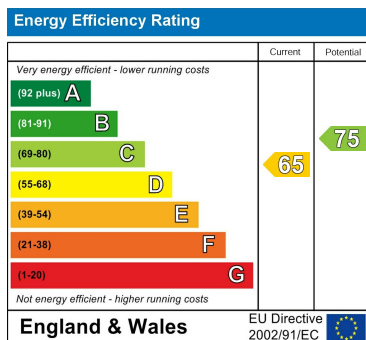

Call us on

01923 220 012

enquiries@warrenanthony.co.uk

www.warrenanthony.co.uk

Agents Note: Whilst every care has been taken to prepare these particulars, they are for guidance purposes only. All measurements are approximate and are for general guidance purposes only and whilst every care has been taken to ensure their accuracy, they should not be relied upon and potential buyers are advised to recheck the