



House - Terraced (EPC Rating: )

**FEARNLEY STREET, WATFORD, WD18  
ORD**  
Per Calendar Month  
**£2,000 Per**

# 3 Bedroom House - Terraced located in Watford

A STUNNING FULLY FURNISHED THREE BEDROOM MID TERRACE HOUSE IN CENTRAL WATFORD - MINUTES WALK TO WATFORD TOWN CENTRE & JUST 0.9 MILES TO WATFORD JUNCTION STATION - AVAILABLE 1ST NOVEMBER 2024.

This property has recently been refurbished and is offered to a high standard. Boasting 1,076 sq ft of living space, this house is not to be missed! The property is comprised of an entrance hallway, open plan living room/dining room leading to the kitchen and the family bathroom. On the first floor, there are three bedrooms (two doubles and one single).

One of the standout features of this property is the triple glazing, ensuring an energy-efficient environment all year round. There is also a very large outbuilding in the garden with access to electricity meaning you could make it your very own home office!

The property offers permit parking which is available through Watford Borough Council.

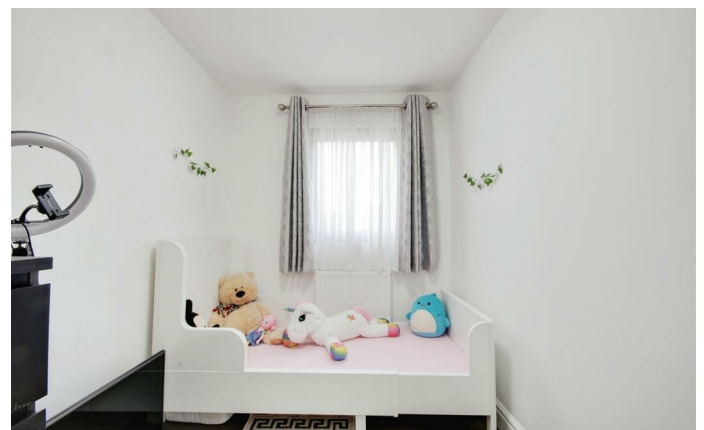

WATFORD LETTINGS | 12 MARKET STREET, WATFORD, HERTFORDSHIRE, WD18 0PD

GROUND FLOOR  
560 sq.ft. (52.0 sq.m.) approx.

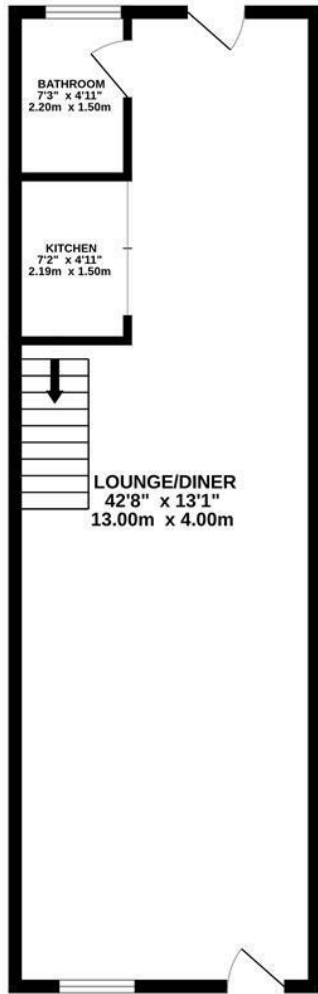

1ST FLOOR  
381 sq.ft. (35.4 sq.m.) approx.

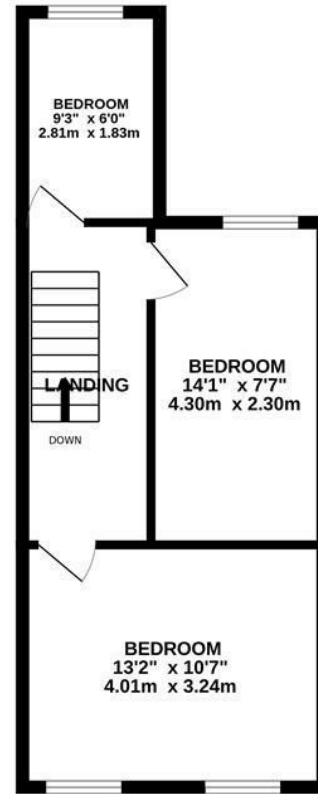

TOTAL FLOOR AREA: 941 sq.ft. (87.4 sq.m.) approx.

Whilst every attempt has been made to ensure the accuracy of the floorplans contained here, measurements of doors, windows, rooms and any other items are approximate and no responsibility is taken for any error, omission or mis-statement. This plan is for illustrative purposes only and should be used as such by any prospective purchaser. The services, systems and appliances shown have not been tested and no guarantee as to their operability or efficiency can be given.  
Made with Metropix ©2024

Council Tax Band

Energy Performance Graph

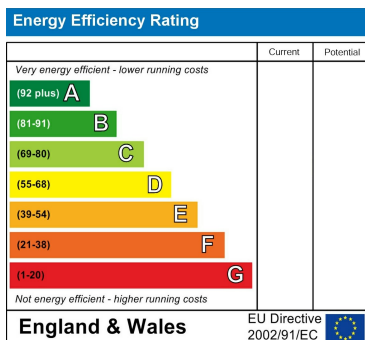

Call us on

**01923 220 012**

**enquiries@warrenanthony.co.uk**

**www.warrenanthony.co.uk**

Agents Note: Whilst every care has been taken to prepare these particulars, they are for guidance purposes only. All measurements are approximate and are for general guidance purposes only and whilst every care has been taken to ensure their accuracy, they should not be relied upon and potential buyers are advised to recheck the

