



Apartment (EPC Rating: D)

**LEWIS HOUSE, EXPLORER DRIVE,
WATFORD, WD18 6GX**

Per Month

£1,300 Per

1 Bedroom Apartment located in Watford

MODERN ONE BEDROOM GROUND FLOOR FLAT - 0.7 MILES TO WATFORD GENERAL HOSPITAL - 0.8 MILES TO WATFORD MET STATION - 0.1 MILE TO WESTFIELD ACADEMY - AVAILABLE MID SEPTEMBER 2024 - THE PROPERTY HAS HAD LIGHT REFURBISHMENT SINCE THESE PHOTOS.

Located on the ground floor, this flat offers easy access and convenience. With allocated parking for one vehicle, you won't have to worry about finding a spot after a long day.

Lewis House is part of a popular development close to Watford General Hospital, making it an excellent choice for healthcare professionals or those who value easy access to medical facilities. Additionally, being near Watford Town Centre means you'll have a plethora of shops, restaurants, and amenities right at your doorstep.

The property comprises of an entrance hallway, double bedroom, living room/dining room, kitchen and bathroom.

Don't miss out on this fantastic opportunity to own or rent a property in such a desirable location. Contact us today to arrange a viewing and envision the possibilities that this lovely apartment has to offer.



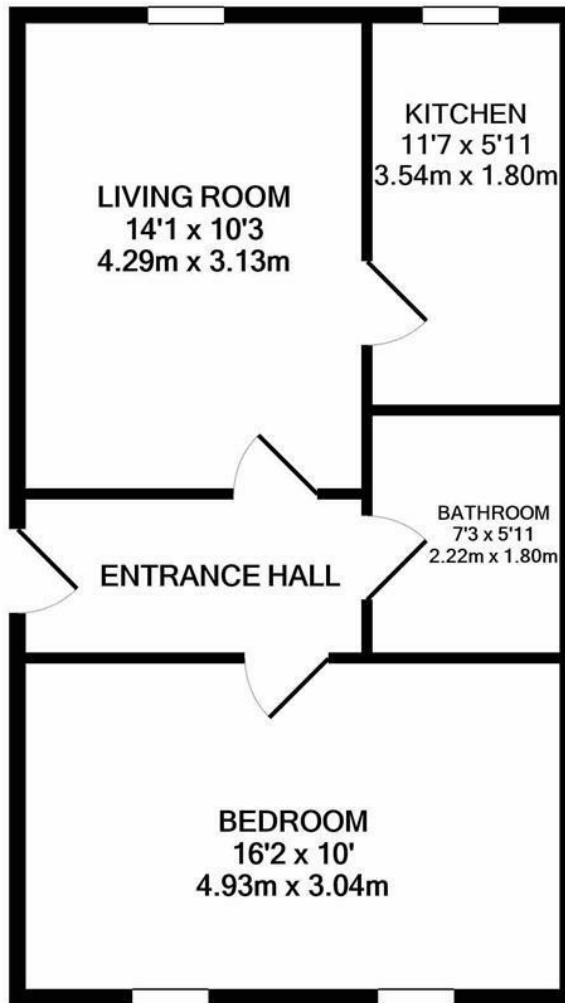

TOTAL APPROX. FLOOR AREA 467 SQ.FT. (43.4 SQ.M.)

Whilst every attempt has been made to ensure the accuracy of the floor plan contained here, measurements of doors, windows, rooms and any other items are approximate and no responsibility is taken for any error, omission, or mis-statement. This plan is for illustrative purposes only and should be used as such by any prospective purchaser. The services, systems and appliances shown have not been tested and no guarantee as to their operability or efficiency can be given
 Made with Metropix ©2020

Council Tax Band

D

Energy Performance Graph

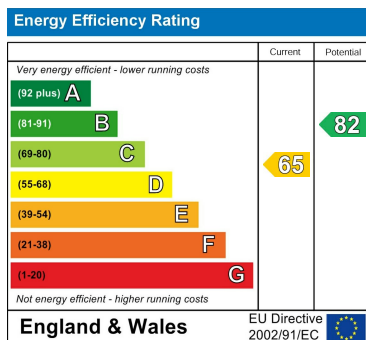

Call us on

01923 220 012

enquiries@warrenanthony.co.uk

www.warrenanthony.co.uk

Agents Note: Whilst every care has been taken to prepare these particulars, they are for guidance purposes only. All measurements are approximate and are for general guidance purposes only and whilst every care has been taken to ensure their accuracy, they should not be relied upon and potential buyers are advised to recheck the