



Apartment (EPC Rating: E)

**FARRIERS COURT, HORSESHOE LANE,
GARSTON, WD25 7JB**

PCM

£1,200 PCM

1 Bedroom Apartment located in Garston

RECENTLY REFURBISHED - SPACIOUS ONE DOUBLE BEDROOM APARTMENT - GREAT ACCESS TO THE M1, M25 & A41

This lovely second floor apartment is offered to a high standard and provides a bright and fresh living space for the next occupant. The apartment consists of a hall, good size lounge diner, a great size bedroom with mirror fronted fitted wardrobes, bathroom (with shower) and a modern fitted kitchen. There is double glazing, allocated parking, small communal gardens and the property is offered unfurnished.. The property has excellent bus routes to Watford & St Albans and is just a minutes drive from the M1. NO PETS - AVAILABLE SEPTEMBER 2024



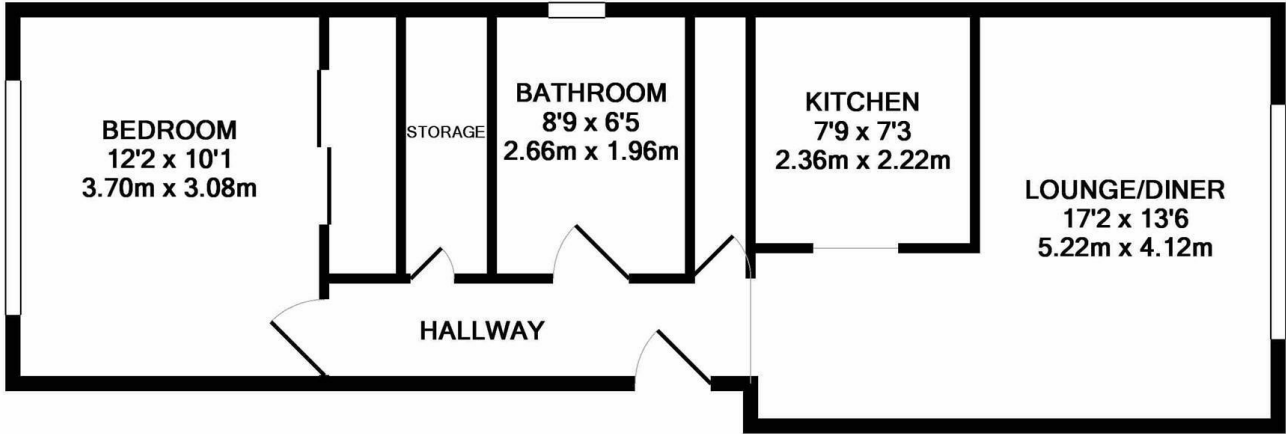

TOTAL APPROX. FLOOR AREA 522 SQ.FT. (48.5 SQ.M.)

Whilst every attempt has been made to ensure the accuracy of the floor plan contained here, measurements of doors, windows, rooms and any other items are approximate and no responsibility is taken for any error, omission, or mis-statement. This plan is for illustrative purposes only and should be used as such by any prospective purchaser. The services, systems and appliances shown have not been tested and no guarantee as to their operability or efficiency can be given
 Made with Metropix ©2018

Council Tax Band

E

Energy Performance Graph

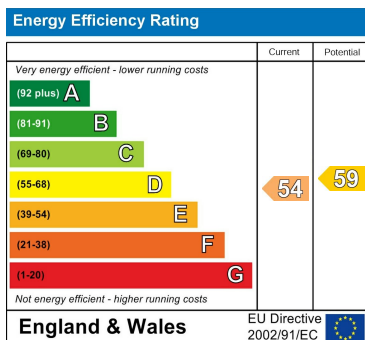

Call us on

01923 220 012

enquiries@warrenanthony.co.uk

www.warrenanthony.co.uk

Agents Note: Whilst every care has been taken to prepare these particulars, they are for guidance purposes only. All measurements are approximate and are for general guidance purposes only and whilst every care has been taken to ensure their accuracy, they should not be relied upon and potential buyers are advised to recheck the

