



Apartment (EPC Rating: C)

**11 KING STREET, WATFORD,
HERTFORDSHIRE, WD18 0BW**
PCM

£1,500 PCM

2 Bedroom Apartment located in Hertfordshire

LANDLORD IS KEEN TO LET QUICKLY SO GET YOUR OFFERS IN ON THIS VERY SPACIOUS TWO DOUBLE BEDROOM GROUND FLOOR APARTMENT LOCATED IN WATFORD TOWN CENTRE CLOSE TO ALL STATIONS & SHOPS.

A modern and desirable two double bedroom apartment located in Watford town centre close to all stations with direct links to London. The property is located very close to the vibrant town centre and is just a short walk from Watford Hospital. There is a hall, two double bedrooms, a bathroom and a large open plan living area with modern kitchen. The property is double glazed, has gas central heating, part furnished & is AVAILABLE LATE JUNE 2024. NO PARKING OR PERMITS ARE AVAILABLE FOR THIS PROPERTY.



WATFORD LETTINGS | 12 MARKET STREET, WATFORD, HERTFORDSHIRE, WD18 0PD

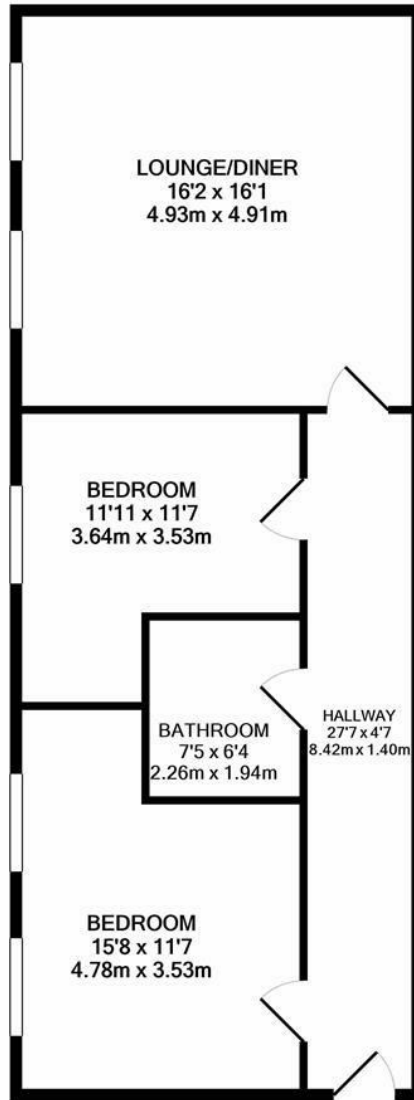

TOTAL APPROX. FLOOR AREA 707 SQ.FT. (65.7 SQ.M.)

Whilst every attempt has been made to ensure the accuracy of the floor plan contained here, measurements of doors, windows, rooms and any other items are approximate and no responsibility is taken for any error, omission, or mis-statement. This plan is for illustrative purposes only and should be used as such by any prospective purchaser. The services, systems and appliances shown have not been tested and no guarantee as to their operability or efficiency can be given
 Made with Metropix ©2020

Council Tax Band

C

Energy Performance Graph

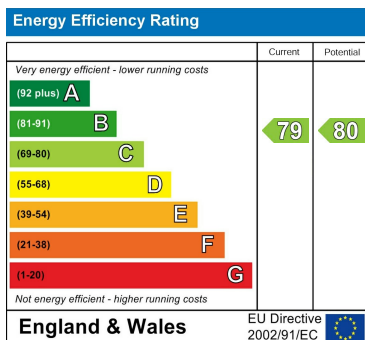

Call us on

01923 220 012

enquiries@warrenanthony.co.uk

www.warrenanthony.co.uk

Agents Note: Whilst every care has been taken to prepare these particulars, they are for guidance purposes only. All measurements are approximate and are for general guidance purposes only and whilst every care has been taken to ensure their accuracy, they should not be relied upon and potential buyers are advised to recheck the