



Apartment (EPC Rating: )

**HORSESHOE LANE, WATFORD, WD25  
7JB**

Per Calendar Month

**£1,250 Per**



# 1 Bedroom Apartment located in Watford

Warren Anthony is pleased to present a one-bedroom ground floor apartment nestled within a serene private development on Horseshoe Lane. This property is perfect for single and working professionals!

Upon entry, a hallway leading to various sections of the apartment. To the left, you'll find the cozy bedroom, while straight ahead lies the modern and well-maintained bathroom. The heart of the home, the spacious lounge/kitchen diner, awaits to the right. There is 614 sq ft of living space.

Conveniently, there is parking available for one vehicle at the rear of the apartment block.

The property will be available Mid-May 2024.

0.4 MILES TO WATFORD LEISURE CENTRE WOODSIDE.  
1.6 MILES TO GARSTON RAILWAY LINE.  
1.9 MILES AT ASDA WATFORD SUPERCENTRE.  
2 MILES TO SAINBURYS.  
4.5 MILES TO ATRIA.



WATFORD LETTINGS | 12 MARKET STREET, WATFORD, HERTFORDSHIRE, WD18 0PD

**GROUND FLOOR**  
522 sq.ft. (48.5 sq.m.) approx.

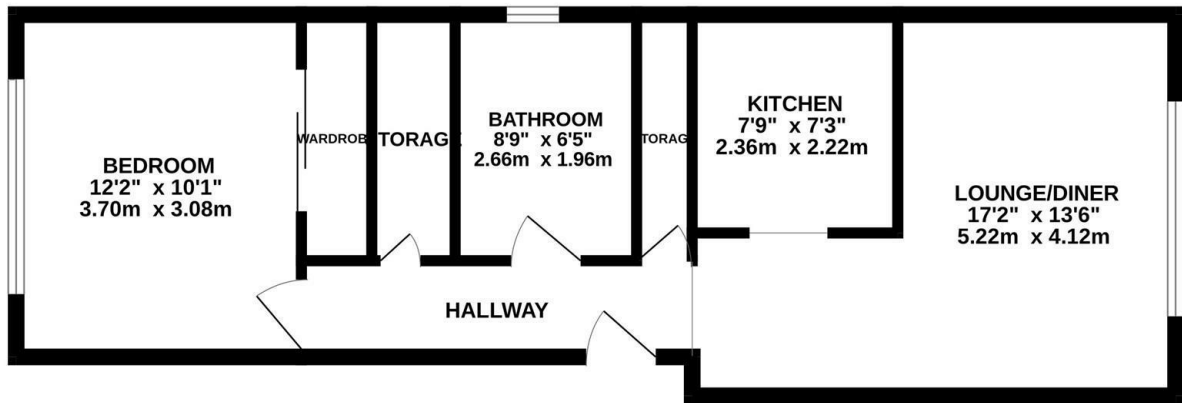

TOTAL FLOOR AREA : 522 sq.ft. (48.5 sq.m.) approx.  
Whilst every attempt has been made to ensure the accuracy of the floorplan contained here, measurements of doors, windows, rooms and any other items are approximate and no responsibility is taken for any error, omission or mis-statement. This plan is for illustrative purposes only and should be used as such by any prospective purchaser. The services, systems and appliances shown have not been tested and no guarantee as to their operability or efficiency can be given.  
 Made with Metropix ©2024

Council Tax Band

Energy Performance Graph

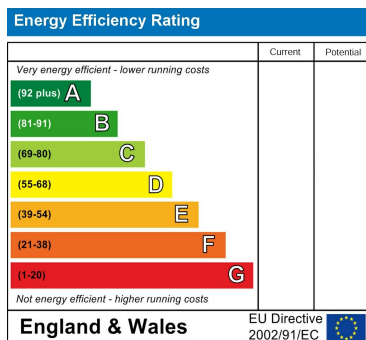

Call us on

**01923 220 012**

**enquiries@warrenanthony.co.uk**

**www.warrenanthony.co.uk**

Agents Note: Whilst every care has been taken to prepare these particulars, they are for guidance purposes only. All measurements are approximate and are for general guidance purposes only and whilst every care has been taken to ensure their accuracy, they should not be relied upon and potential buyers are advised to recheck the