

LEASEHOLD



Apartment (EPC Rating: C)

**DRAYTON COURT, 7 TOLPITS LANE,
WATFORD, WD18 7QG**

Asking Price

£199,950



1 Bedroom Apartment located in Watford

Beautifully presented top floor one bedroom apartment close to Watford Met Station and Watford General Hospital. Chain Free.

Full Description

A modern top floor one bedroom apartment with a large balcony 0.8 miles to Watford Met Station and 0.6 miles to Watford General Hospital.

This top floor one bedroom apartment is in excellent order and comprises of a spacious open plan lounge/kitchen area with doors opening onto a balcony, one double bedroom and a good sized bathroom. The property has modern underfloor heating, double glazing and a communal garden area shared with 5 other flats. The property is offered chain free.

Lease 115 Years Unexpired
Service Charge £868.00 per annum
Ground Rent £200 per annum

NO PARKING OR PERMITS AVAILABLE!

Information for investors, we anticipate this property to achieve £1,150 to £1,200pcm if placed on the rental market today



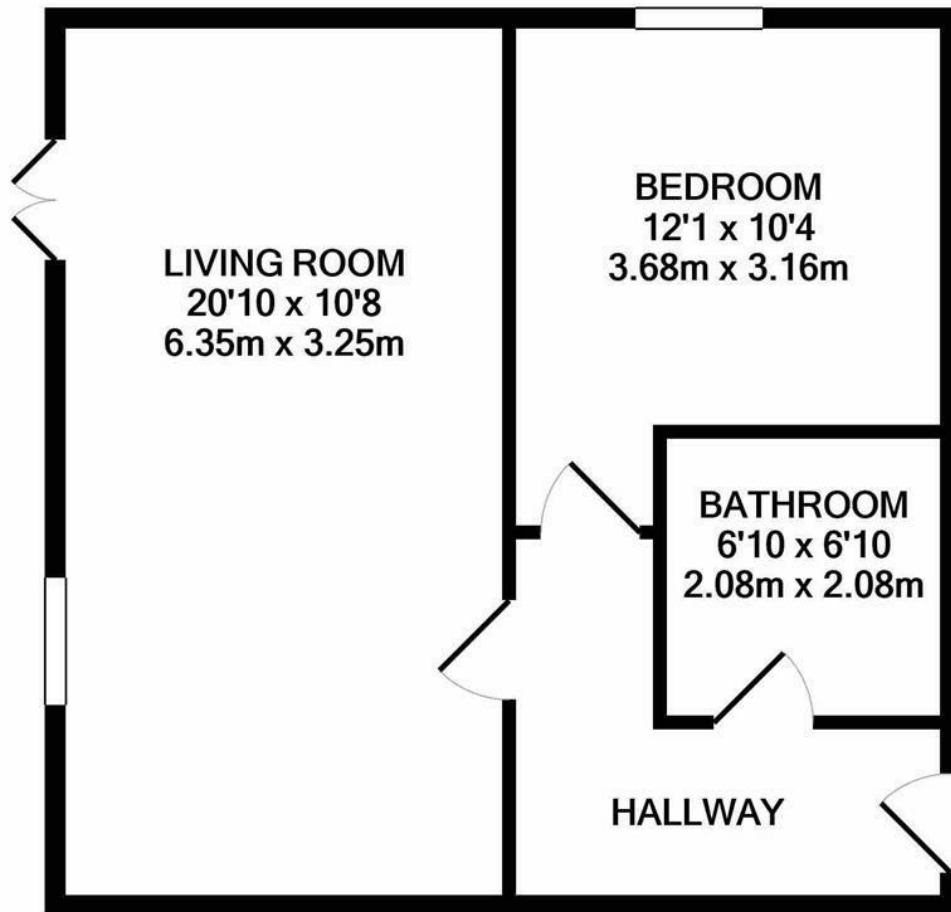

TOTAL APPROX. FLOOR AREA 438 SQ.FT. (40.7 SQ.M.)

Whilst every attempt has been made to ensure the accuracy of the floor plan contained here, measurements of doors, windows, rooms and any other items are approximate and no responsibility is taken for any error, omission, or mis-statement. This plan is for illustrative purposes only and should be used as such by any prospective purchaser. The services, systems and appliances shown have not been tested and no guarantee as to their operability or efficiency can be given
 Made with Metropix ©2019

Council Tax Band

C

Energy Performance Graph

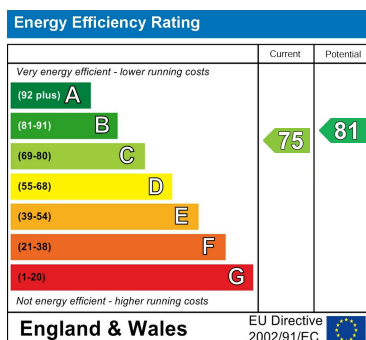

Call us on

01923 220012

sales@warrenanthony.co.uk

<https://www.warrenanthony.co.uk>

Agents Note: Whilst every care has been taken to prepare these particulars, they are for guidance purposes only. All measurements are approximate and are for general guidance purposes only and whilst every care has been taken to ensure their accuracy, they should not be relied upon and potential buyers are advised to recheck the