



£400,000

44 Sommerville Road, St Andrews, Bristol, BS7 9AB

2 The Promenade, Bristol, BS7 8AL

Tel: 0117 3700556

Email: [info@elephantlovesbristol.co.uk](mailto:info@elephantlovesbristol.co.uk)

Web: [www.elephantlovesbristol.co.uk](http://www.elephantlovesbristol.co.uk)

## 44 Sommerville Road St Andrews, Bristol, BS7 9AB

A spacious first-floor apartment with its own private south-facing garden close to St Andrew's Park.

The accommodation comprises a sitting room with bay windows, original sashes, cornice, picture rail, and a cast iron feature fireplace with a wooden mantle. At the rear is a kitchen/dining room with a range of fitted units with integrated appliances, solid wood worktops, and a window overlooking the rear garden. This well-proportioned room also has space for a dining table.

The apartment also has two double bedrooms, both with period fireplaces and sash windows. A hallway connects all rooms, including the centrally positioned bathroom, which has two large windows and a white bathroom suite. The loft space provides additional and useful storage.

Externally, the property has private use of a southerly-facing rear garden, which is laid out with a lawn, planted borders, a brick-built store, and a seating area.

The local independent shops, cafes, and restaurants along Gloucester Road and St



Andrews Park are only a short walk away. Montpelier Station and Ashley Down Station (due to open in 2024) are a 10-minute walk away and offer a direct route into Templemeads or up to Clifton Downs. Nearby bus stops also provide access to arterial bus routes.





### 44 Sommerville Road, Bristol, BS7 9AB

Approximate Gross Internal Area = 75.5 sq m / 813 sq ft  
 Store = 4.3 sq m / 46 sq ft  
 Total = 79.8 sq m / 859 sq ft

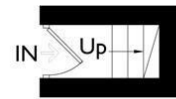

Ground Floor

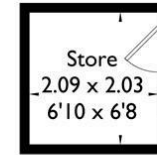
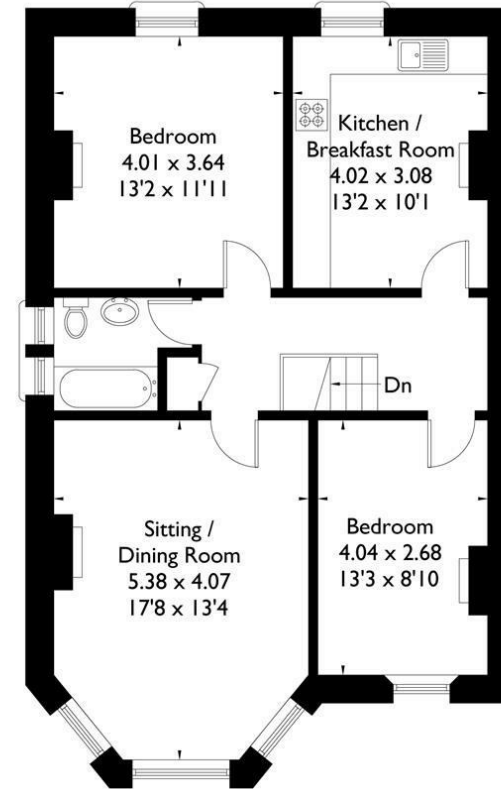

(Not Shown In Actual Location / Orientation)

First Floor

FLOORPLANZ © 2018 0203 9056099 Ref: 212607

This plan is for layout guidance only. Drawn in accordance with RICS guidelines. Not drawn to scale unless stated. Windows & door openings are approximate. Whilst every care is taken in the preparation of this plan, please check all dimensions, shapes & compass bearings before making any decisions reliant upon them.

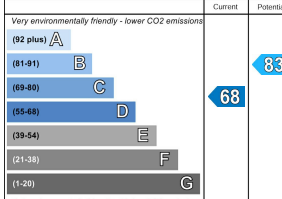
Energy Efficiency Rating		Environmental Impact (CO <sub>2</sub> ) Rating	
Current	Potential	Current	Potential
	69 → 80		68 → 83
England & Wales	EU Directive 2002/91/EC	England & Wales	EU Directive 2002/91/EC

Disclaimer: You may download, store and use the material for your own personal use and research. You may not republish, retransmit, redistribute or otherwise make the material available to any party or make the same available on any website, online service or bulletin board of your own or of any other party or make the same available in hard copy or in any other media without the website owner's express prior written consent. The website owner's copyright must remain on all reproductions of material taken from this website.