



1 Battery Green Road, Lowestoft, Suffolk, NR32 1DE

Very spacious and well located office in fantastic condition available to rent on Battery Green Road in Lowestoft.

£20,000 Per Annum

GROUND FLOOR
2857 sq.ft. (265.4 sq.m.) approx.

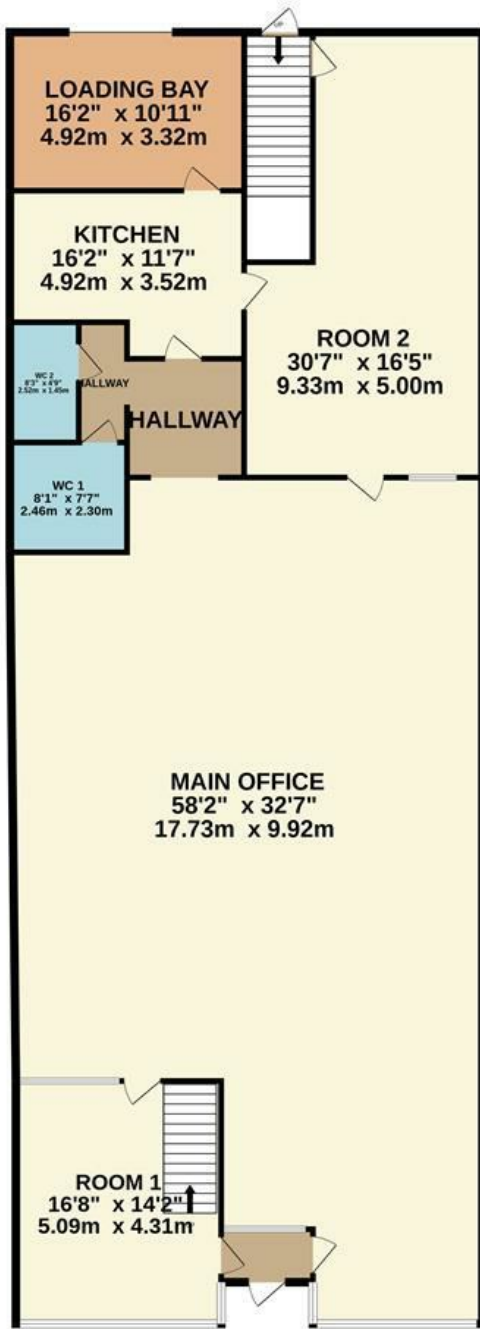

1ST FLOOR
2277 sq.ft. (211.5 sq.m.) approx.

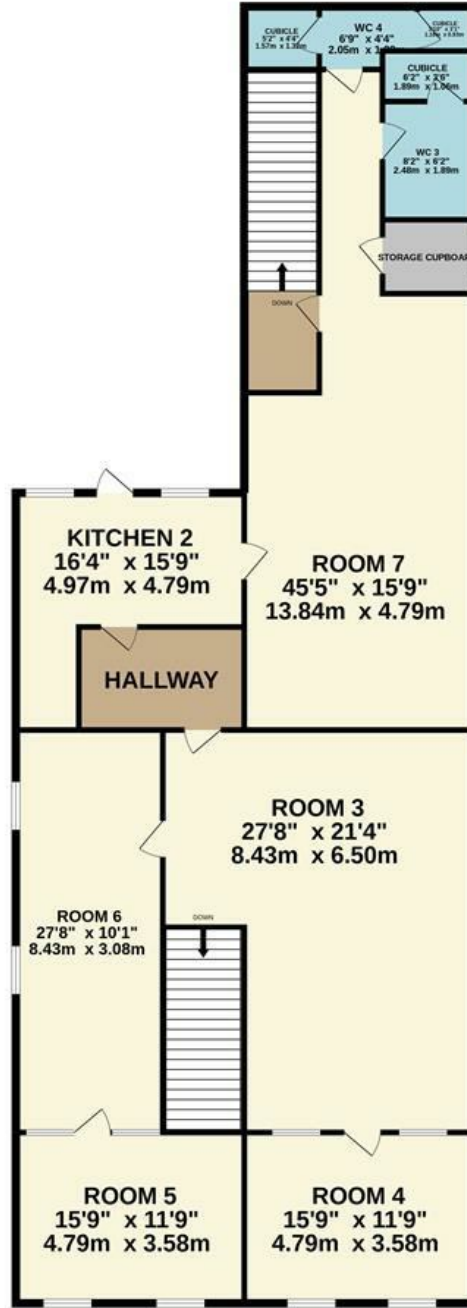

TOTAL FLOOR AREA : 5133 sq.ft. (476.9 sq.m.) approx.

Whilst every attempt has been made to ensure the accuracy of the floorplan contained here, measurements of doors, windows, rooms and any other items are approximate and no responsibility is taken for any error, omission or mis-statement. This plan is for illustrative purposes only and should be used as such by any prospective purchaser. The services, systems and appliances shown have not been tested and no guarantee as to their operability or efficiency can be given.

Made with Metropix ©2022

Energy Efficiency Rating		
	Current	Potential
Very energy efficient - lower running costs		
(92 plus) A		
(81-91) B		
(69-80) C		
(55-68) D		
(39-54) E		
(21-38) F		
(1-20) G		
Not energy efficient - higher running costs		
England & Wales	EU Directive 2002/91/EC	