



Matthew Pierce
www.matthewpierce.co.uk

5 & 6 High Street,
Claygate,
Surrey,
KT10 0JG

01372 463100
claygate@matthewpierce.co.uk

9 GLEBELANDS, CLAYGATE, SURREY KT10 0LF

A three-bedroom detached family home in good decorative order, set on a wide plot and benefitting from a single storey rear extension behind the garage creating an additional reception room. The house offer scope for updating both the bathroom and kitchen. The property is located within easy reach of local amenities including Claygate Common and the Recreation Ground as well as being just 1 mile from the Station.

(Please note no building or extensions are allowed to the left of the property - for more information please contact us).



PRICE GUIDE £500,000 FREEHOLD EPC: Band E. Council Tax: Band E.

Matthew Pierce give notice that these particulars whilst believed to be accurate, are set out as a general guidance only. Intending purchasers or tenants should not rely on them as statements or representations of fact, but must satisfy themselves by inspection or otherwise as to their accuracy. As such, it does not constitute or form part of a contract. No person in the employment of Matthew Pierce has the authority to make or give representation or warranty in relation to the property.



9 Glebelands, Claygate, Surrey. KT10 0LF
Approximate Gross Internal Floor Area: 99m sq (1,073sq ft)

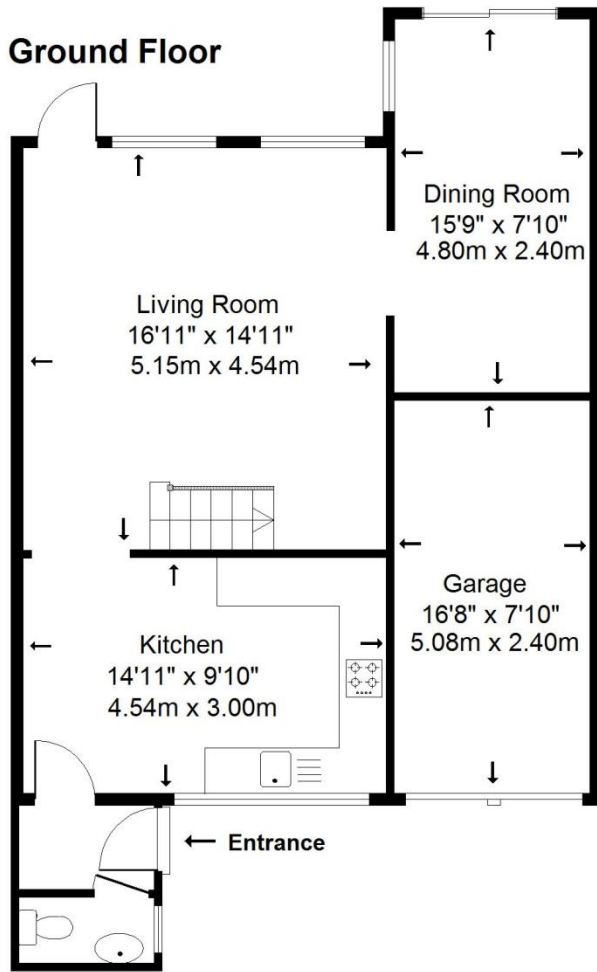
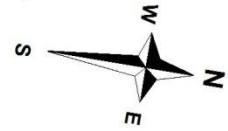

First Floor

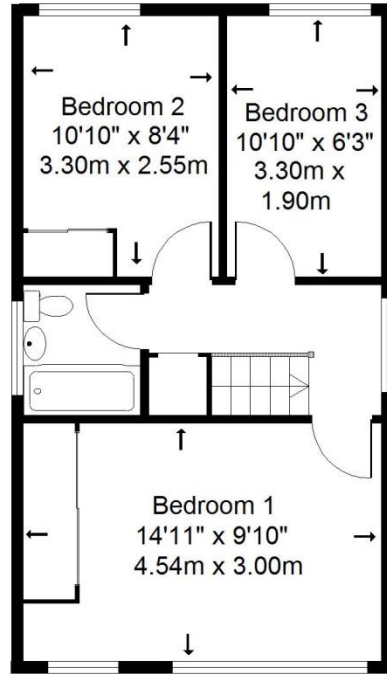

Not to scale

This plan is for illustrative purposes only and is not drawn to scale unless stated. Whilst every care has been taken to ensure the accuracy of this plan, dimensions and compass bearings should be checked before making any decisions reliant upon them. Dimensions shown are to the nearest 3" and are to where indicated by arrow heads. Appliances and utilities eg. baths, cookers etc are visuals only, style and shape may differ.

© Drawing Rooms 2016 - Reproduced for Matthew Pierce

**THIS PLAN HAS BEEN COMMISSIONED BY MATTHEW PIERCE AND
MUST NOT BE REPRODUCED WITHOUT PRIOR PERMISSION**

