

Prominent commercial office extending to approximately 237 sq ft

Highly visible frontage with large display window

In the heart of Anniesland, minutes from train station

Herschell Street, Anniesland, Glasgow, G13 1HR

Commercial Office – To Let

2A Herschell Street is prominently situated in the heart of Anniesland, just a few minutes' walk from Anniesland Train Station and positioned immediately off Great Western Road, providing excellent transport links and local amenities.

£14,500 pa



Property Description

Commercial Office – To Let

2A Herschell Street is prominently situated in the heart of Anniesland, just a few minutes' walk from Anniesland Train Station and positioned immediately off Great Western Road, providing excellent transport links and local amenities.

The property extends to approximately 22 sq m (237 sq ft) and is currently configured as an estate agency office. It benefits from a highly visible office frontage with a large display window. Internally, the accommodation comprises a main office, a separate rear office, along with a kitchen/utility area and WC facilities to the rear.

The property is available to let, subject to landlord approval.

Initial enquiries to be directed to EVE Property.



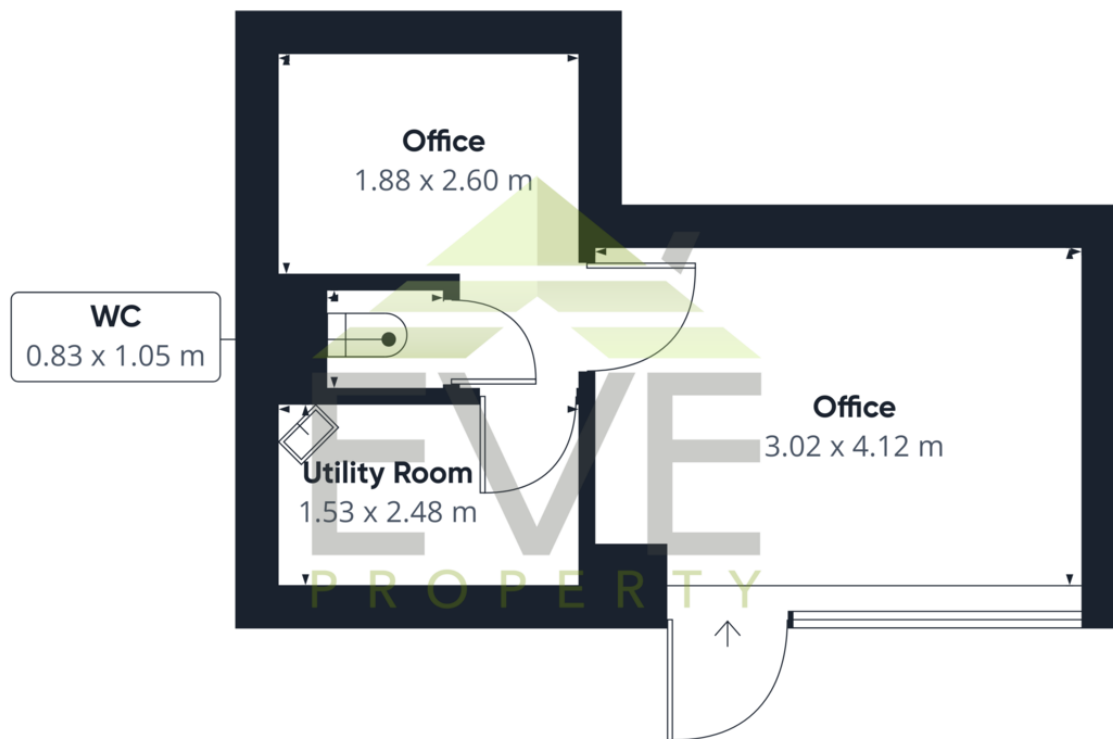

1 Herschell Street, Anniesland,
Glasgow, Lanarkshire, G13 1HR

www.eve-property.co.uk
0141 255 0020
hello@eve-property.co.uk

Agents Note: Whilst every care has been taken to prepare these particulars, they are for guidance purposes only. All measurements are approximate are for general guidance purposes only and whilst every care has been taken to ensure their accuracy, they should not be relied upon and potential buyers/tenants are advised to recheck the measurements