

HUNTERS®

HERE TO GET *you* THERE

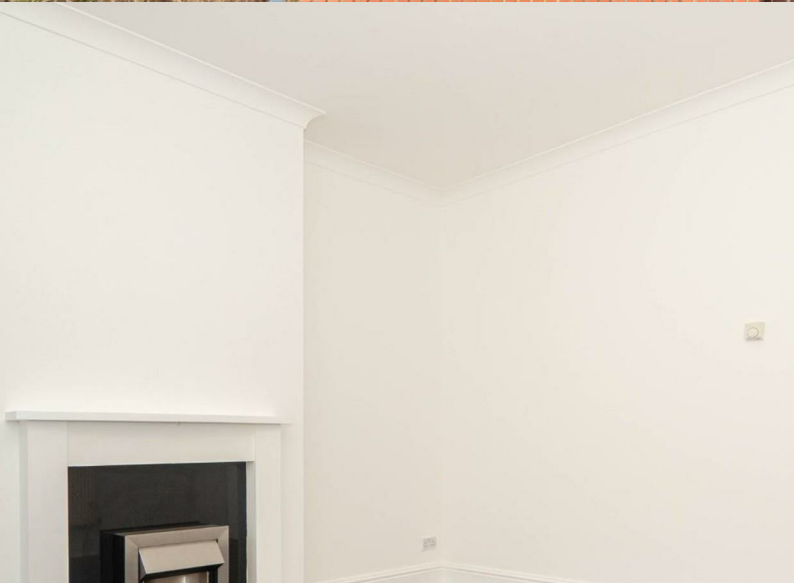

Landseer Terrace

, Bramley, LS13 2RQ

£1,200 Per Month



Council Tax:

Floor Plan

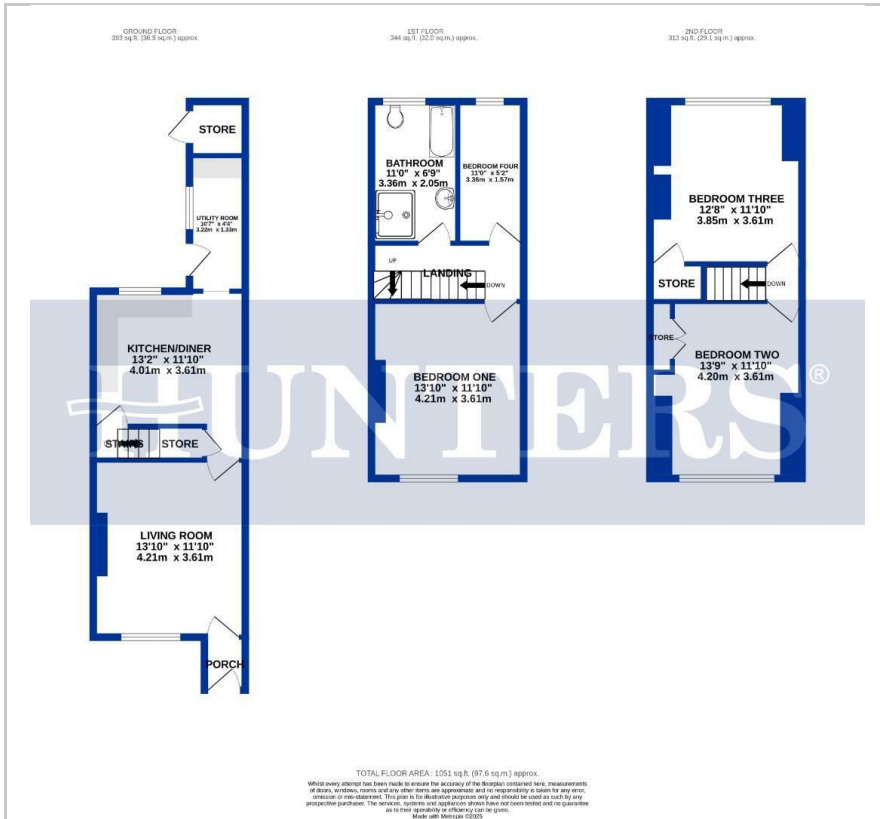

Area Map



Energy Efficiency Graph

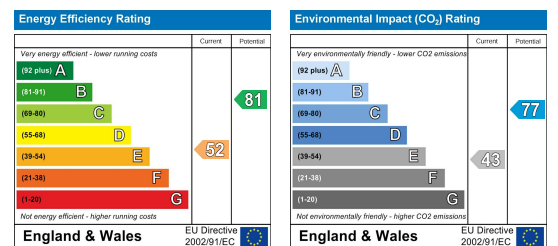

Viewing

Please contact our Hunters Pudsey Lettings Office on 01132576198 if you wish to arrange a viewing appointment for this property or require further information.

- FOUR BEDROOMS
- AVAILABLE NOW
- FRONT AND BACK YARD
- EPC RATING: D
- UNFURNISHED
- LARGE KITCHEN DINER
- CELLAR



HUNTERS are pleased to offer FOR RENT this FOUR BEDROOM END TERRACED PROPERTY situated between KIRKSTALL & ARMLEY. The property on offer comprises; LOUNGE, newly fitted KITCHEN and separate UTILITY ROOM. On the FIRST FLOOR there are TWO BEDROOMS, ONE SINGLE AND ONE DOUBLE, as well as the four piece HOUSE BATHROOM. The SECOND FLOOR has a further TWO DOUBLE ATTIC BEDROOMS making this property a great FAMILY HOME.

MATERIAL INFORMATION

Tenure:
Lease Years Remaining:
Annual Ground Rent:
Review Period:
Review Increase:
Service Charge:
Shared Ownership:
Ownership Share:

These particulars are intended to give a fair and reliable description of the property but no responsibility for any inaccuracy or error can be accepted and do not constitute an offer or contract. We have not tested any services or appliances (including central heating if fitted) referred to in these particulars and the purchasers are advised to satisfy themselves as to the working order and condition. If a property is unoccupied at any time there may be reconnection charges for any switched off/disconnected or drained services or appliances - All measurements are approximate. **THINKING OF SELLING?** If you are thinking of selling your home or just curious to discover the value of your property, Hunters would be pleased to provide free, no obligation sales and marketing advice. Even if your home is outside the area covered by our local offices we can arrange a Market Appraisal through our national network of Hunters estate agents.