

HUNTERS®

HERE TO GET *you* THERE



Lowtown

, Pudsey, LS28 7BQ

£850 Per Month



Council Tax: **B**

Floor Plan

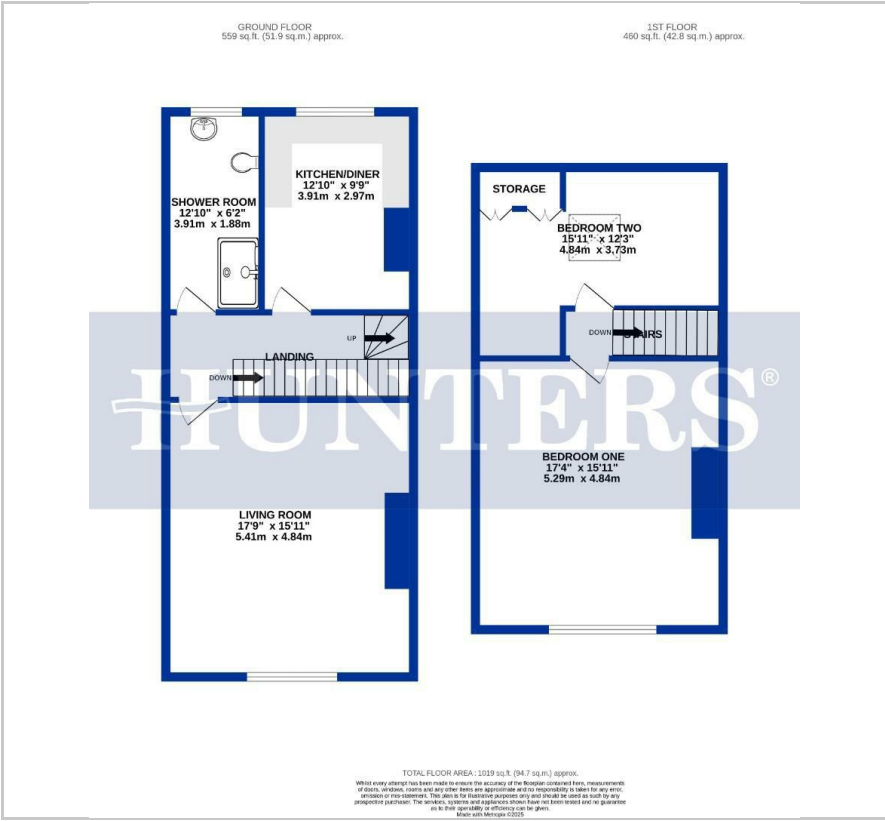

Area Map

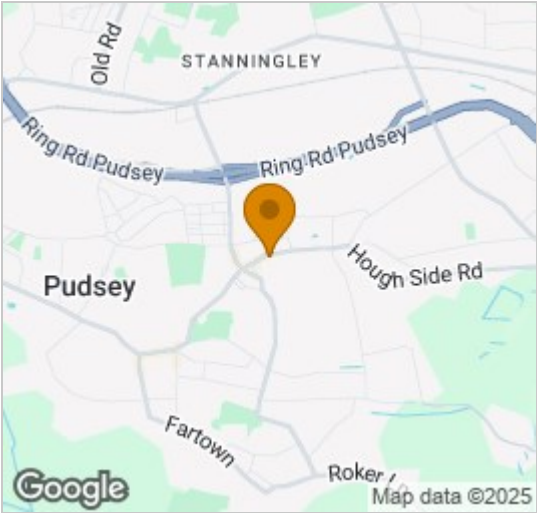

Energy Efficiency Graph

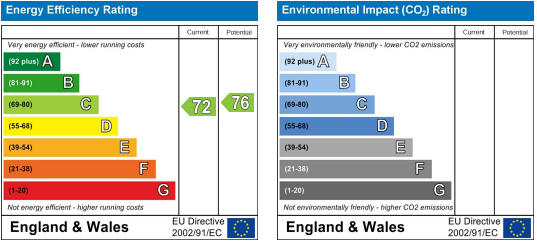

Viewing

Please contact our Hunters Pudsey Lettings Office on 01132576198 if you wish to arrange a viewing appointment for this property or require further information.

- DUPLEX FLAT
- CENTRAL LOCATION
- IDEAL FOR SHARERS
- SPACIOUS ACCOMMODATION
- COUNCIL TAX B
- TWO BEDROOMS
- GREAT TRANSPORT LINKS
- AVAILABLE NOW
- EPC E

Available to rent immediately is this spacious three-bedroom duplex flat, situated in the heart of Pudsey town centre. Offering generous living accommodation across two floors, the property is perfectly suited to professional sharers or a family looking for a home with excellent local amenities on the doorstep.



MATERIAL INFORMATION

- Tenure:
- Lease Years Remaining:
- Annual Ground Rent:
- Review Period:
- Review Increase:
- Service Charge:
- Shared Ownership:
- Ownership Share:

These particulars are intended to give a fair and reliable description of the property but no responsibility for any inaccuracy or error can be accepted and do not constitute an offer or contract. We have not tested any services or appliances (including central heating if fitted) referred to in these particulars and the purchasers are advised to satisfy themselves as to the working order and condition. If a property is unoccupied at any time there may be reconnection charges for any switched off/disconnected or drained services or appliances - All measurements are approximate. **THINKING OF SELLING?** If you are thinking of selling your home or just curious to discover the value of your property, Hunters would be pleased to provide free, no obligation sales and marketing advice. Even if your home is outside the area covered by our local offices we can arrange a Market Appraisal through our national network of Hunters estate agents.