

Mike
Dobson



Orchard View Main Street

Hillam, Leeds, LS25 5HG

£550,000

Orchard View Main Street

*** NO ONWARD CHAIN *** BEAUTIFUL COTTAGE IN THIS CHARMING VILLAGE ***

Welcome to Orchard View on Main Street, Hillam! This charming detached cottage boasts an entrance porch with fitted storage cupboards, 3 reception rooms, one which has been used as a home office, perfect for entertaining guests or simply relaxing with your family. With 4 good size bedrooms and 2 bathrooms, there's plenty of space for everyone to enjoy.

The property features PVCu double glazing and gas central heating, ensuring a warm and energy-efficient home all year round. You'll find fitted furniture in 2 bedrooms, offering both style and functionality. The main bedroom even has the luxury of an en-suite, providing a private sanctuary for relaxation.

One of the highlights of this cottage is the wood-burning stove in the spacious lounge. Imagine cozy evenings by the fire, creating a warm and inviting atmosphere for you and your loved ones.

The property has a gravelled driveway leading to a detached carport and garage with an enclosed lawned garden and decked seating area ideal for entertaining guests with barbecue and pizza oven.

Don't miss the opportunity to make Orchard View your new home. With its characterful features and comfortable living spaces, this property is sure to capture your heart.





Floor Plan

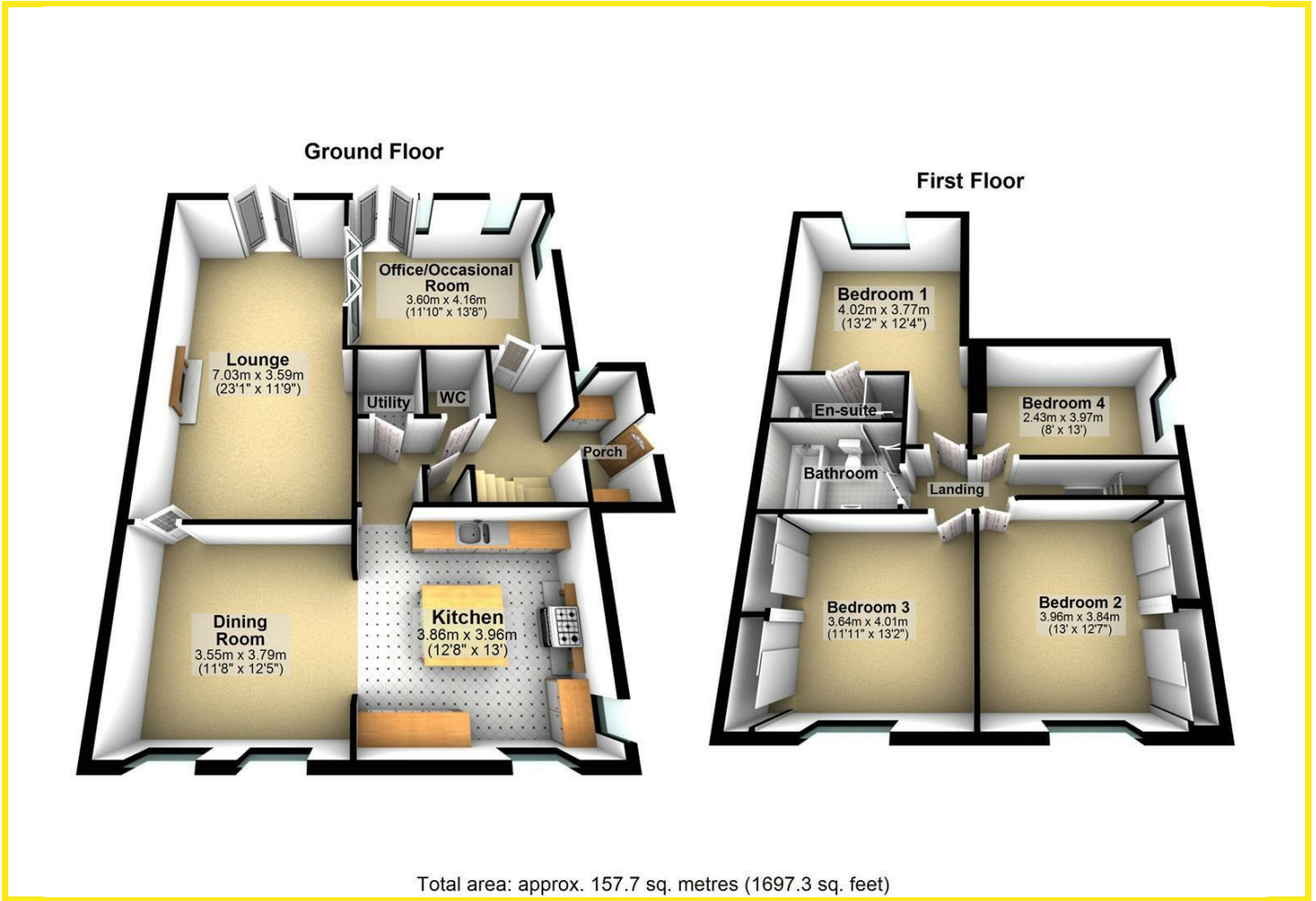

Area Map



Energy Efficiency Graph

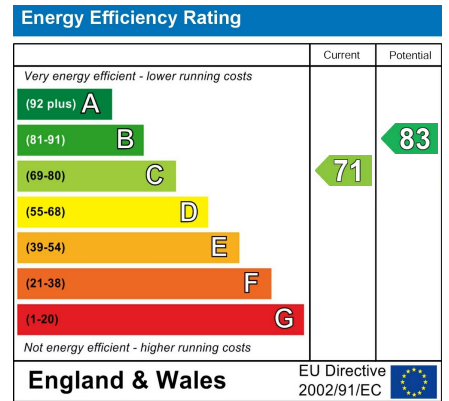

Directions

From our Sherburn In Elmet office turn left onto Low Street proceed out of the village and through the village of South Milford. Pass the Petrol Station and proceed to the roundabout. Take the second exit and proceed towards Monk Fryston. Proceed over the Railway Bridge and turn left at the junction passing The Crown Public House on the righthand side. Turn right on the bend onto Water Lane with inturn becomes Lumbly Hill and then Main Street Hillam. The property can be found on the right hand side opposite Bedfords Fold as indicated by our Agents Board.

These particulars, whilst believed to be accurate are set out as a general outline only for guidance and do not constitute any part of an offer or contract. Intending purchasers should not rely on them as statements of representation of fact, but must satisfy themselves by inspection or otherwise as to their accuracy. No person in this firms employment has the authority to make or give any representation or warranty in respect of the property.

98 Wolsey Croft, Sherburn in Elmet, LS25 6DP

Tel: 01977 684258 Email: sherburn@mdboson.co.uk <https://www.mdboson.co.uk>