



Room

**HOLFORD WAY,
ROEHAMPTON,
LONDON SW15 5EY**

PCM

£2,350 PCM

FEATURES

- Two double bedrooms
- Custom made kitchen
- Allocated parking
- Balcony
- Large reception room



2 Bedroom Room located in London

Saxon Kings are delighted to bring to the market this Larger than usual...executive apartment in the ever popular Queen Marys development.

Benefiting from allocated parking, lift service, secure entryphone, private balcony and a fantastic custom made kitchen.

Accommodation comprises two double bedrooms (en-suite to master), main bathroom, spacious lounge/diner.

Council tax band - E
Security deposit £2711
Holding fee -£542

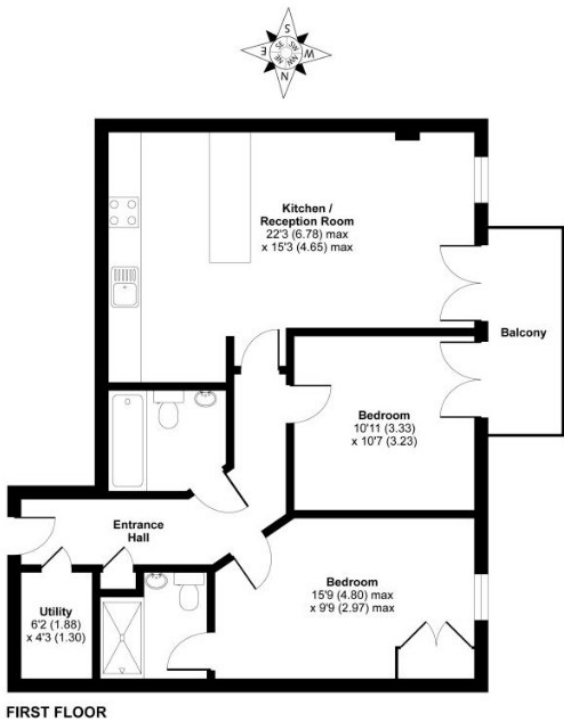

Holford Way, London, SW15

APPROX. GROSS INTERNAL FLOOR AREA 805 SQ FT 74.8 SQ METRES

Whilst every attempt has been made to ensure the accuracy of the floor plan contained here, measurements of doors, windows and rooms are approximate and no responsibility is taken for any error, omission or misstatement. These plans are for representation purposes only as defined by RICS Code of Measuring Practice and should be used as such by any prospective purchaser. Specifically no guarantee is given on the total square footage of the property if quoted on this plan. Any figure given is for initial guidance only and should not be relied on as a basis of valuation.

Copyright nichecom.co.uk 2015 Produced for Haart REF : 51694

Call us on
020 8546 7771

info@saxonkings.co.uk
www.saxonkings.co.uk

Council Tax Band
E

Energy Efficiency Rating		
	Current	Potential
Very energy efficient - lower running costs		
(92 plus) A		
(81-91) B		
(69-80) C		
(55-68) D		
(39-54) E		
(21-38) F		
(1-20) G		
Not energy efficient - higher running costs		
England & Wales		
EU Directive 2002/91/EC		

Agents Note: Whilst every care has been taken to prepare these particulars, they are for guidance purposes only. All measurements are approximate and are for general guidance purposes only and whilst every care has been taken to ensure their accuracy, they should not be relied upon and potential buyers are advised to recheck the measurements.

