

LEASEHOLD



Apartment (EPC Rating: C)

LONDON ROAD KINGSTON KT2 6QJ

Asking Price

£350,000



2 Bedroom Apartment located in Kingston

Saxon Kings are delighted to bring to the market this 2 bedroom apartment centrally located within Kingston town centre and walking distance from Kingston/Norbiton train stations & Richmond Park

This chain free property is an ideal first time purchase.

The accommodation comprises TWO bedrooms, large open plan lounge with a modern fitted kitchen.

Bathroom with shower over bath. Additional benefits include a communal rear garden.

Leasehold, 90 years remaining, service charge £1500P/A, ground rent £400.

Approximate Area = 573 sq ft / 53.2 sq m
For identification only - Not to scale

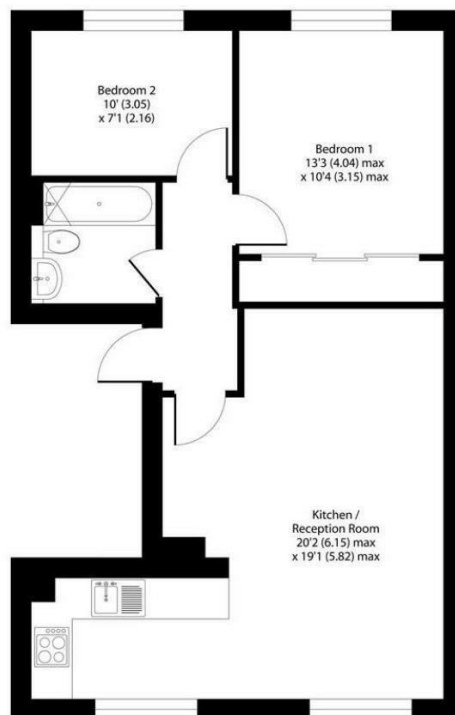

Council Tax Band

C

Energy Performance Graph

Call us on

020 8546 7771

info@saxonkings.co.uk

www.saxonkings.co.uk

Energy Efficiency Rating		Current	Potential
Very energy efficient - lower running costs			
(92 plus) A			
(81-91) B			
(69-80) C		71	81
(55-68) D			
(39-54) E			
(21-38) F			
(1-20) G			
Not energy efficient - higher running costs			
England & Wales	EU Directive 2002/91/EC		

Agents Note: Whilst every care has been taken to prepare these particulars, they are for guidance purposes only. All measurements are approximate and are for general guidance purposes only and whilst every care has been taken to ensure their accuracy, they should not be relied upon and potential buyers are advised to recheck the measurements.

