

## Lime Tree Avenue, Long Stratton

Guide Price £280,000

3 2 1



The property comprises of a three bedroom semi-detached Chalet extended to the first floor to create spacious master suite. To the ground floor the accommodation comprises of a modern kitchen, lounge, shower room, and two further bedrooms. The bungalow is built of traditional brick and block cavity wall construction under an interlocking tiled roof, being heated by an oil fired central heating system via radiators and benefits from replacement sealed unit upvc double glazed windows and doors.

## Key Features

- South facing patio
- First floor master suite
- Walking distance to amenities
- EPC Rating D
- Oil heating
- Redecorated throughout
- Parking for three cars
- Freehold
- Council Tax Band C
- Mains drainage

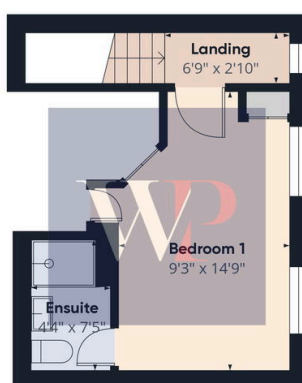

Approximate total area<sup>(1)</sup>  
748.31 ft<sup>2</sup>  
Reduced headroom  
3 ft<sup>2</sup>

(1) Excluding balconies and terraces

Reduced headroom  
..... Below 5 ft

While every attempt has been made to ensure accuracy, all measurements are approximate, not to scale. This floor plan is for illustrative purposes only.

Calculations are based on RICS IPMS 3C standard.

GIRAFFE360