

Wash Lane, Wacton, Norwich, NR15 2UJ

Guide Price £400,000-£425,000

4 bedrooms 2 bathrooms 1 garage



This detached bungalow has been SIGNIFICANTLY ENHANCED and now provides STYLISH accommodation totalling approx. 1155 sq ft. Occupying a PROMINENT and pleasing ELEVATED POSITION within the heart of the village the GENEROUS PLOT is in the regions of a quarter of an acre .

Key Features

- GUIDE PRICE £400,000-£425,000
- 4 bedrooms
- Heating- Oil
- Corner plot approx. 1/4 acre
- Parking for 6-8 cars
- Single Garage
- 2 bathrooms
- Replacement windows
- Rural views
- Drainage- mains

GROUND FLOOR
1155 sq.ft. (107.3 sq.m.) approx.

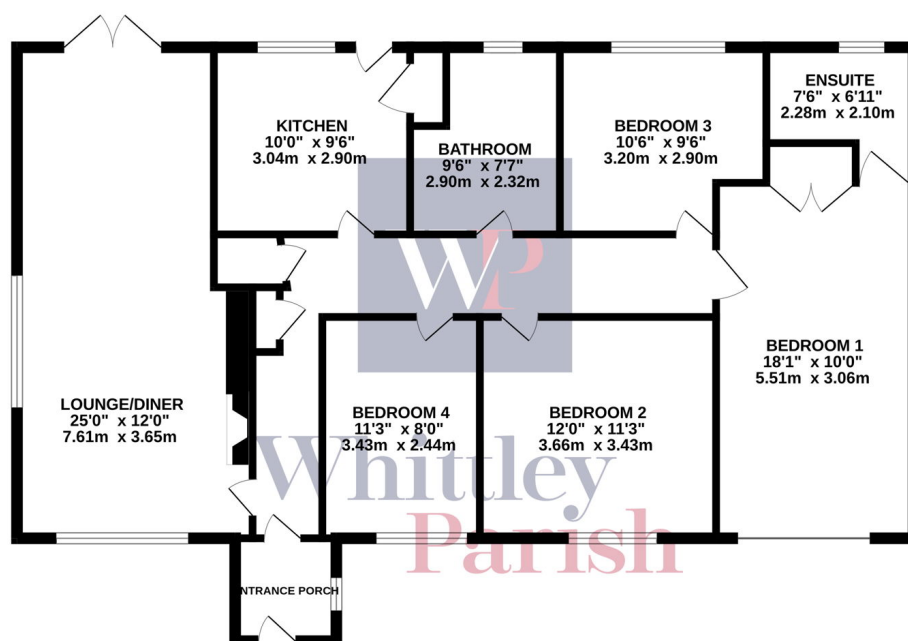

TOTAL FLOOR AREA: 1155 sq.ft. (107.3 sq.m.) approx.

Whilst every attempt has been made to ensure the accuracy of the floorplan contained here, measurements of doors, windows, rooms and any other items are approximate and no responsibility is taken for any error, omission or mis-statement. This plan is for illustrative purposes only and should be used as such by any prospective purchaser. The services, systems and appliances shown have not been tested and no guarantee as to their operability or efficiency can be given.
Made with Metropix ©2023