



See More Online

KFB: Key Facts For Buyers

A Guide to This Property & the Local Area

Thursday 11th July 2024



BUNGAY ROAD, HEMPNALL, NORWICH, NR15

Whittley Parish | Long Stratton

Beatrix Potter Cottage, The Street Long Stratton NR15 2XJ

01508 531331

liam@whittleyparish.com

www.whittleyparish.com



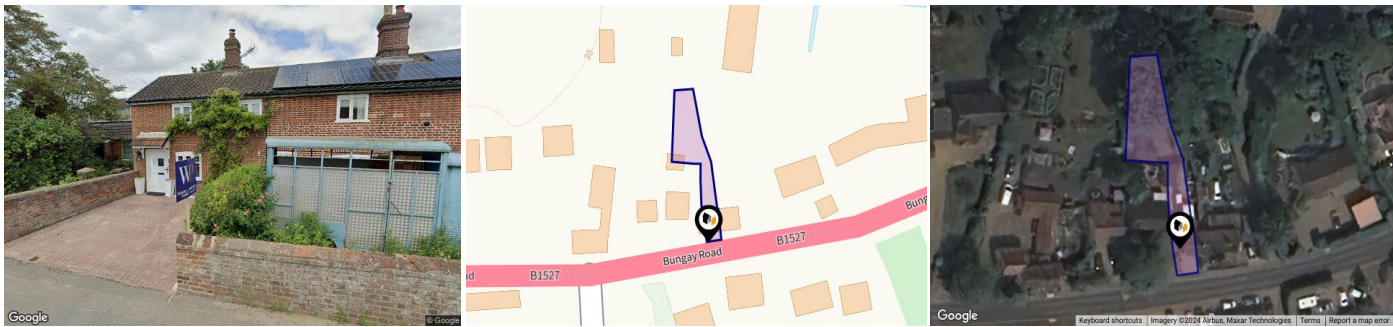

Property

Type:	Semi-Detached	Tenure:	Freehold
Bedrooms:	2		
Floor Area:	699 ft ² / 65 m ²		
Plot Area:	0.1 acres		
Year Built :	Before 1900		
Council Tax :	Band C		
Annual Estimate:	£2,007		
Title Number:	NK99067		

Local Area

Local Authority:	Norfolk
Conservation Area:	Hempnall
Flood Risk:	
• Rivers & Seas	No Risk
• Surface Water	High

Estimated Broadband Speeds (Standard - Superfast - Ultrafast)

17 mb/s	80 mb/s	1000 mb/s

Mobile Coverage: (based on calls indoors)



Satellite/Fibre TV Availability:









BUNGAY ROAD, HEMPSTALL, NORWICH, NR15

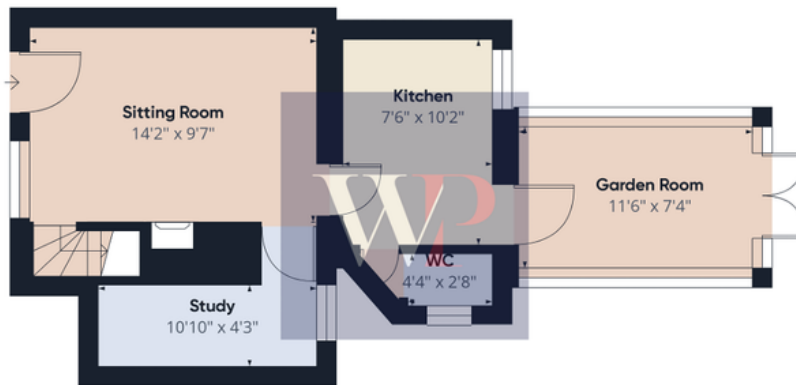

Floor 0

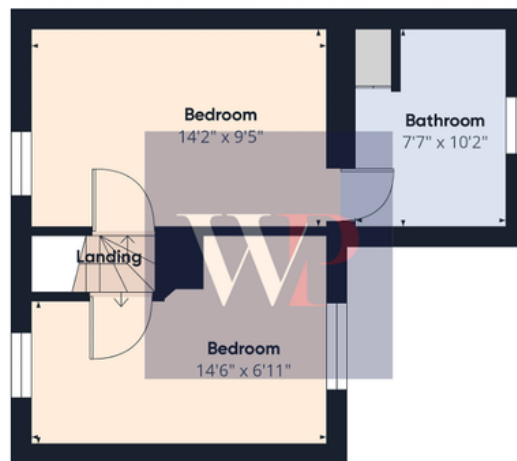

Floor 1



Approximate total area⁽¹⁾
739.1 ft²

(1) Excluding balconies and terrace

While every attempt has been made to ensure accuracy, all measurements are approximate, not to scale. This floor plan is for illustrative purposes only.

GIRAFFE360



BUNGAY ROAD, HEMPALL, NR15

Energy rating

D

Valid until 22.05.2034

Score	Energy rating	Current	Potential
92+	A		
81-91	B		88 B
69-80	C		
55-68	D	56 D	
39-54	E		
21-38	F		
1-20	G		



Additional EPC Data





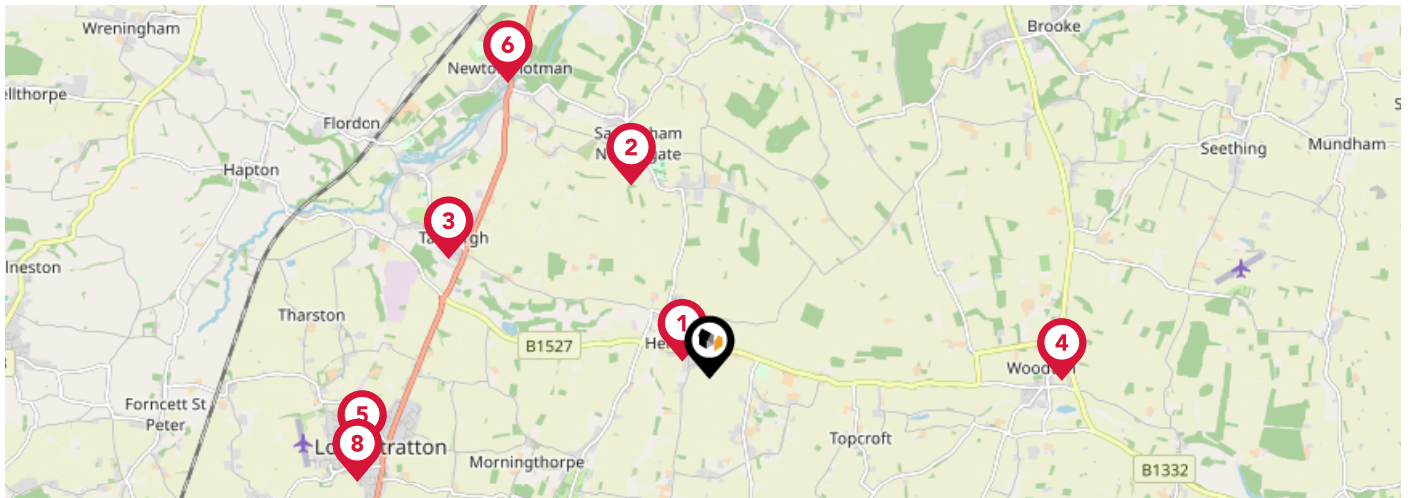

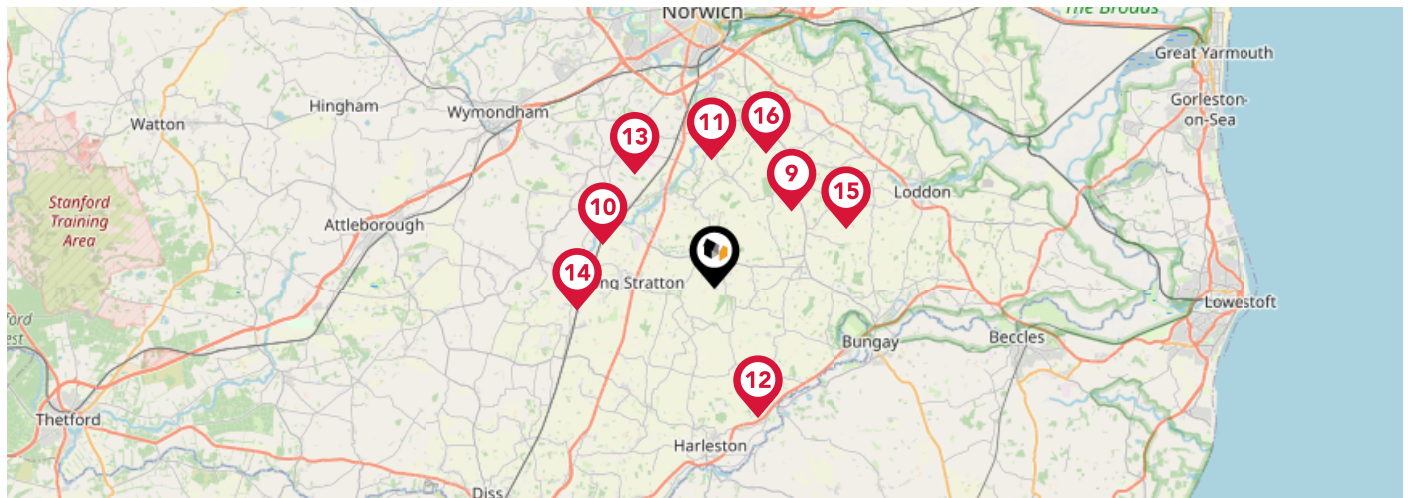

Property Type:	Semi-detached house
Walls:	Solid brick, as built, no insulation (assumed)
Walls Energy:	Very poor
Roof:	Pitched, 250 mm loft insulation
Roof Energy:	Good
Window:	Fully double glazed
Window Energy:	Average
Main Heating:	Boiler and radiators, mains gas
Main Heating Energy:	Good
Main Heating Controls:	Programmer, TRVs and bypass
Main Heating Controls Energy:	Average
Hot Water System:	From main system
Hot Water Energy Efficiency:	Good
Lighting:	Low energy lighting in 64% of fixed outlets
Lighting Energy:	Good
Floors:	Solid, no insulation (assumed)
Secondary Heating:	Room heaters, dual fuel (mineral and wood)
Total Floor Area:	65 m ²

Area Schools



	Nursery	Primary	Secondary	College	Private
1 Hempnall Primary School Ofsted Rating: Good Pupils: 137 Distance:0.3	<input type="checkbox"/>	<input checked="" type="checkbox"/>	<input type="checkbox"/>	<input type="checkbox"/>	<input type="checkbox"/>
2 Saxlingham Nethergate CofE VC Primary School Ofsted Rating: Good Pupils: 64 Distance:1.89	<input type="checkbox"/>	<input checked="" type="checkbox"/>	<input type="checkbox"/>	<input type="checkbox"/>	<input type="checkbox"/>
3 Preston Church of England Voluntary Controlled Primary School Ofsted Rating: Good Pupils: 123 Distance:2.59	<input type="checkbox"/>	<input checked="" type="checkbox"/>	<input type="checkbox"/>	<input type="checkbox"/>	<input type="checkbox"/>
4 Woodton Primary School Ofsted Rating: Good Pupils: 50 Distance:3.19	<input type="checkbox"/>	<input checked="" type="checkbox"/>	<input type="checkbox"/>	<input type="checkbox"/>	<input type="checkbox"/>
5 St Mary's Church of England Junior School Ofsted Rating: Good Pupils: 212 Distance:3.2	<input type="checkbox"/>	<input checked="" type="checkbox"/>	<input type="checkbox"/>	<input type="checkbox"/>	<input type="checkbox"/>
6 Newton Flotman Church of England Primary Academy Ofsted Rating: Inadequate Pupils:0 Distance:3.24	<input type="checkbox"/>	<input checked="" type="checkbox"/>	<input type="checkbox"/>	<input type="checkbox"/>	<input type="checkbox"/>
7 Manor Field Infant and Nursery School Ofsted Rating: Good Pupils: 182 Distance:3.31	<input type="checkbox"/>	<input checked="" type="checkbox"/>	<input type="checkbox"/>	<input type="checkbox"/>	<input type="checkbox"/>
8 Long Stratton High School Ofsted Rating: Good Pupils: 586 Distance:3.31	<input type="checkbox"/>	<input type="checkbox"/>	<input checked="" type="checkbox"/>	<input type="checkbox"/>	<input type="checkbox"/>



	Nursery	Primary	Secondary	College	Private
 Brooke Voluntary Controlled Church of England Primary School Ofsted Rating: Good Pupils: 104 Distance:3.9	<input type="checkbox"/>	<input checked="" type="checkbox"/>	<input type="checkbox"/>	<input type="checkbox"/>	<input type="checkbox"/>
 Hapton Church of England Voluntary Aided Primary School Ofsted Rating: Good Pupils: 37 Distance:4.31	<input type="checkbox"/>	<input checked="" type="checkbox"/>	<input type="checkbox"/>	<input type="checkbox"/>	<input type="checkbox"/>
 Stoke Holy Cross Primary School Ofsted Rating: Good Pupils: 211 Distance:4.63	<input type="checkbox"/>	<input checked="" type="checkbox"/>	<input type="checkbox"/>	<input type="checkbox"/>	<input type="checkbox"/>
 Alburgh with Denton Church of England Primary School Ofsted Rating: Good Pupils: 101 Distance:4.94	<input type="checkbox"/>	<input checked="" type="checkbox"/>	<input type="checkbox"/>	<input type="checkbox"/>	<input type="checkbox"/>
 Mulbarton Primary School Ofsted Rating: Good Pupils: 435 Distance:4.98	<input type="checkbox"/>	<input checked="" type="checkbox"/>	<input type="checkbox"/>	<input type="checkbox"/>	<input type="checkbox"/>
 Fornsett St Peter Church of England Voluntary Aided Primary School Ofsted Rating: Outstanding Pupils: 104 Distance:5.04	<input type="checkbox"/>	<input checked="" type="checkbox"/>	<input type="checkbox"/>	<input type="checkbox"/>	<input type="checkbox"/>
 Seething and Mundham Primary School Ofsted Rating: Requires Improvement Pupils: 91 Distance:5.18	<input type="checkbox"/>	<input checked="" type="checkbox"/>	<input type="checkbox"/>	<input type="checkbox"/>	<input type="checkbox"/>
 Poringland Primary School Ofsted Rating: Good Pupils: 457 Distance:5.19	<input type="checkbox"/>	<input checked="" type="checkbox"/>	<input type="checkbox"/>	<input type="checkbox"/>	<input type="checkbox"/>

Area

Transport (National)

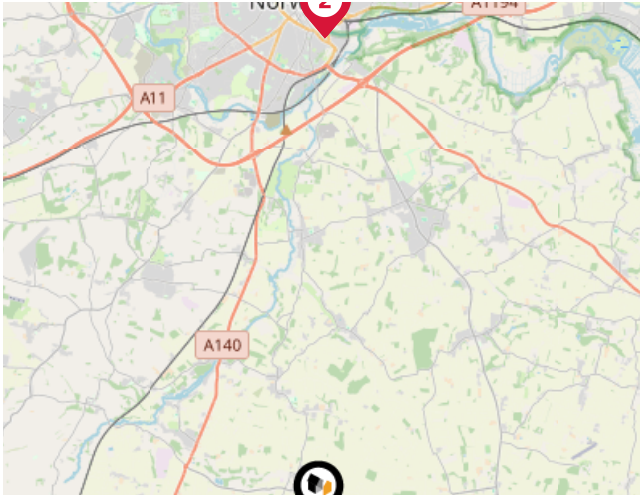

National Rail Stations

Pin	Name	Distance
1	Norwich Rail Station	8.74 miles
2	Norwich Rail Station	8.74 miles
3	Norwich Rail Station	8.76 miles

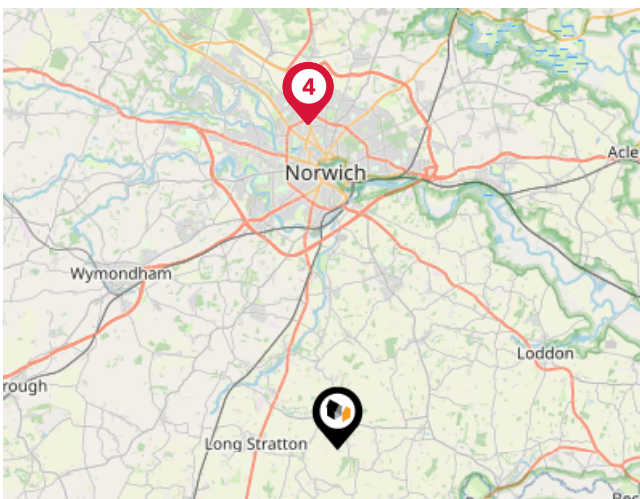

Airports/Helipads

Pin	Name	Distance
1	International Airport	11.74 miles
2	Norwich International Airport	11.74 miles
3	Airport Passenger Terminal	11.76 miles
4	Norwich International Airport	11.76 miles

Area

Transport (Local)

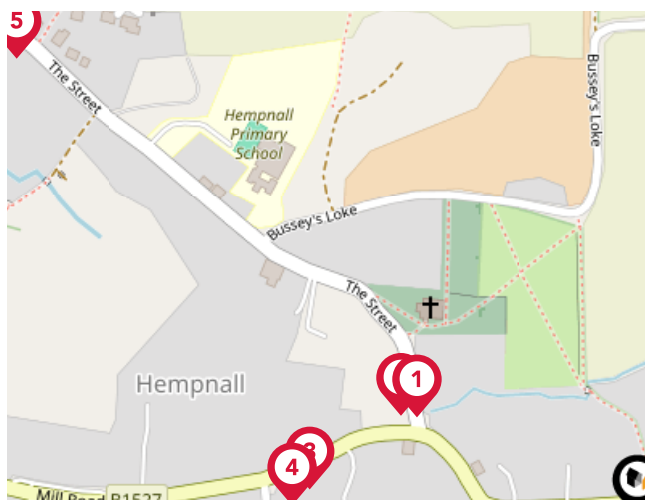

Bus Stops/Stations

Pin	Name	Distance
1	Bus Shelter	0.14 miles
2	Bus Shelter	0.15 miles
3	Mill Road	0.19 miles
4	Mill Road	0.2 miles
5	War Memorial	0.44 miles



Whittleby Parish | Long Stratton

At Whittleby Parish, we strive to offer the best experience for all of our valued clients. We employ an experienced team and support our people with the best processes, cutting edge technology, marketing and training. We continue to improve and learn from feedback to strive to be the best at what we do and achieve.

Our proactive approach combined with advertising across four major property portals (Rightmove, Zoopla, onthemarket.com and Primelocation) as well as on social media platforms; coupled with our large database of registered applicants allows us to promote our properties to the widest target market.

With family roots still at the heart of all operations, Alex Parish ensures the original ethos and vision continues to run throughout the company's core, never comprising the personal service its reputation has been built upon.



Testimonial 1



It was a pleasure doing business with the Attleborough branch. Kept to every promise made and acted really fast. Made a stressful time far less stressful.

Testimonial 2



We asked Whittley Parish Diss to carry out a house valuation for us. Alex Parish came to do the job - he was kind, considerate and professional. The process was thorough but yet quick and easy for us. We couldn't ask for more - many thanks.

Testimonial 3



The whole team at Whittley Parish were first class from first introduction to final sale. With lots of estate agents in the Long Stratton area, this is the only one you need to know. Excellent would highly recommend.



[/whittleyparishmanagementltd](#)



[/whittleyparish](#)



[/whittleyparish/?hl=en](#)

Whittleby Parish | Long Stratton

Data Quality

We are committed to comprehensive property data being made available upfront to make the home buying and selling process quicker, easier and cheaper. This is why we have partnered with Sprift, the UK's leading supplier of property-specific data.



Contains public sector information licensed under the Open Government License v3.0

The information contained within this report is for general information purposes only and to act as a guide to the best way to market your property for the asking price.

Sprift Technologies Ltd aggregate this data from a wide variety of sources and while we endeavour to keep the information up to date and correct, we make no representations or warranties of any kind, express or implied, about the completeness, accuracy, reliability, of the information or related graphics contained within this report for any purpose.

Any reliance you place on such information is therefore strictly at your own risk. In no event will we be liable for any loss or damage including without limitation, indirect or consequential loss or damage, or any loss or damage whatsoever arising from loss of data or profits arising out of, or in connection with, the use of this report.



Whittleby Parish | Long Stratton

Beatrix Potter Cottage, The Street Long
Stratton NR15 2XJ
01508 531331
liam@whittlebyparish.com
www.whittlebyparish.com

