



# Alexander Hudson Estates

---

Sales Particulars

# Alexander Hudson Estates

Meadway Drive, Forest Hall, NE12



# The Property

Alexander Hudson Estates is delighted to present this charming three-bedroom detached bungalow, ideally located in the highly sought-after area of Forest Hall, NE12.

This bright and spacious home is filled with natural light and features a well-balanced layout ideal for families, downsizers, or those looking for single-level living. The accommodation briefly comprises a generously sized living room, modern kitchen, family bathroom, and three well-proportioned bedrooms offering flexible living arrangements.

Occupying a generous plot, the property benefits from a large driveway providing off-street parking for multiple vehicles, along with a detached single garage. The rear garden is well-sized, low-maintenance, and offers an ideal space for outdoor entertaining or peaceful relaxation.

Forest Hall is a well-established suburb named after the Victorian mansion that once stood in the area. This leafy neighbourhood offers a mix of properties, local shops, cafés such as Sands of Tyne Coffee Shop & Bar, and supermarkets, complemented by nearby green spaces. Benton Metro Station and road links via the A19 and A1 provide straightforward commuting. Families are well served by schools including Forest Hall Primary and Ivy Road Primary, alongside nearby secondary schools. With its combination of character, amenities, and green surroundings, Forest Hall remains a highly desirable area for residents of all ages.

Freehold  
Council Tax: C  
EPC Rating: 62

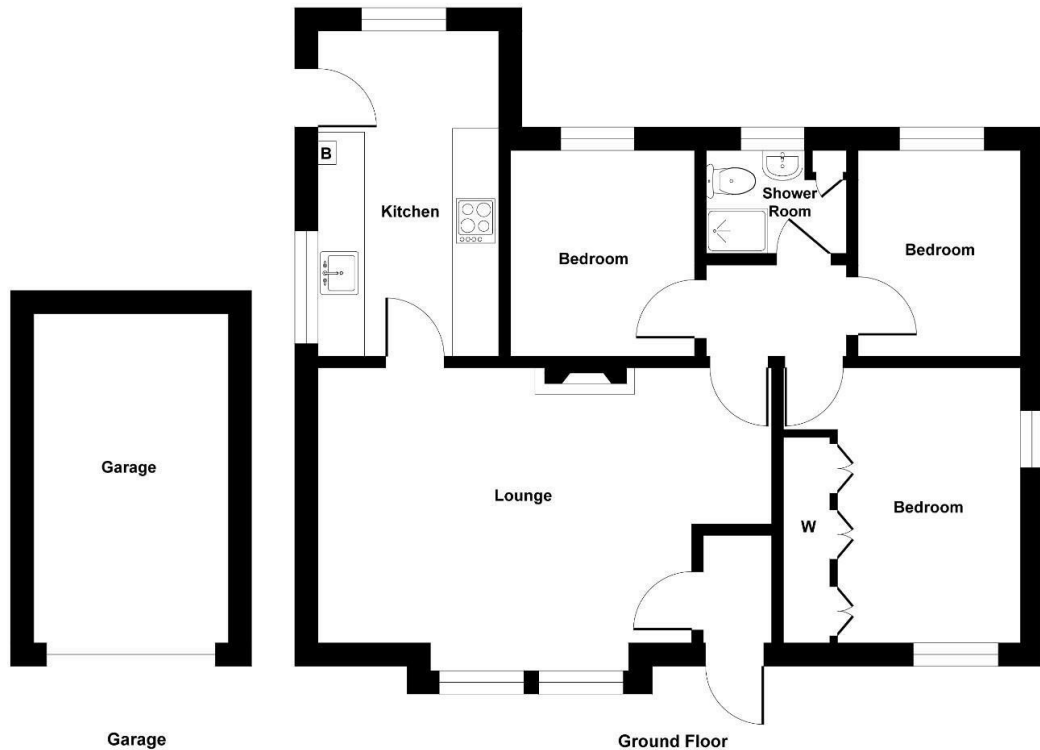
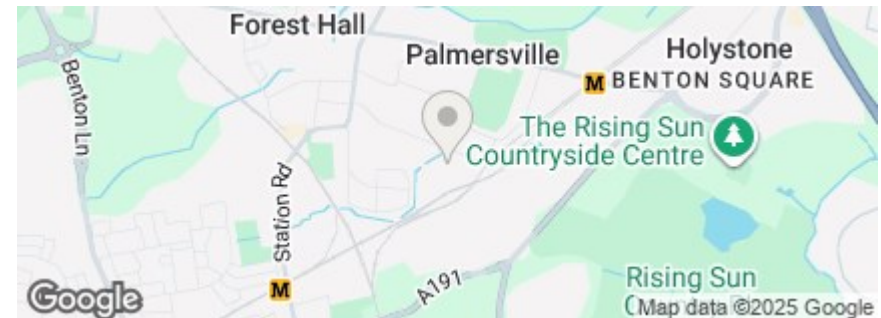

Illustration for identification purpose only, measurements approximate and not to scale, unauthorized reproduction is prohibited. All rights reserved for Alexander Hudson Estates





---

Alexander Hudson Estates  
The Printworks  
20 Arrow Close  
NE12 6QN

0191 268 7433  
[sales@alexanderhudson.co.uk](mailto:sales@alexanderhudson.co.uk)