



Alexander Hudson Estates

Sales Particulars

Alexander Hudson Estates

Church View, Wallsend, NE28

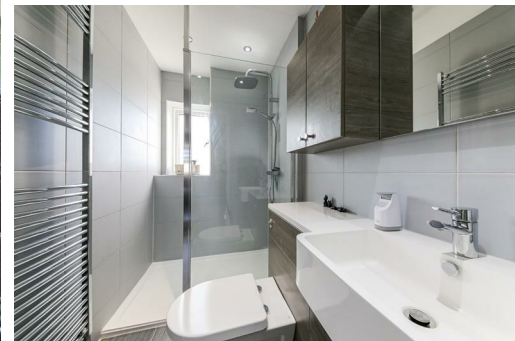

The Property

Alexander Hudson Estates are pleased to welcome to the market this well presented, two-bedroom, semi-detached family home, located in the sought-after residential area of Wallsend, NE28.

Spacious and well maintained throughout, the property briefly comprises a bright and airy living room, a fitted kitchen, and two well-proportioned bedrooms upstairs, along with a contemporary family bathroom.

Externally, the property boasts a private driveway, an attached garage, and well-kept front and rear gardens. A real highlight of this home is the purpose-built garden studio situated at the rear of the property. Fully equipped with power, lighting, insulation, and its own shower room, this versatile space is ideal for use as a home office, gym, creative studio, or guest accommodation.

Located in a highly convenient area, the home is just a short walk from Hadrian Road Metro Station, offering excellent transport links into Newcastle and the coast. The nearby Silverlink Retail Park provides a great selection of shops, restaurants, and leisure facilities, including a cinema. Everyday essentials are also within easy reach, with Asda, B&M, The Range, and JD Gyms all nearby. The property also benefits from easy access to the A19 and A1, making it ideal for commuters. Well-regarded local schools and a variety of green spaces further enhance its appeal.

Freehold
Council Tax: A
EPC Rating: 69

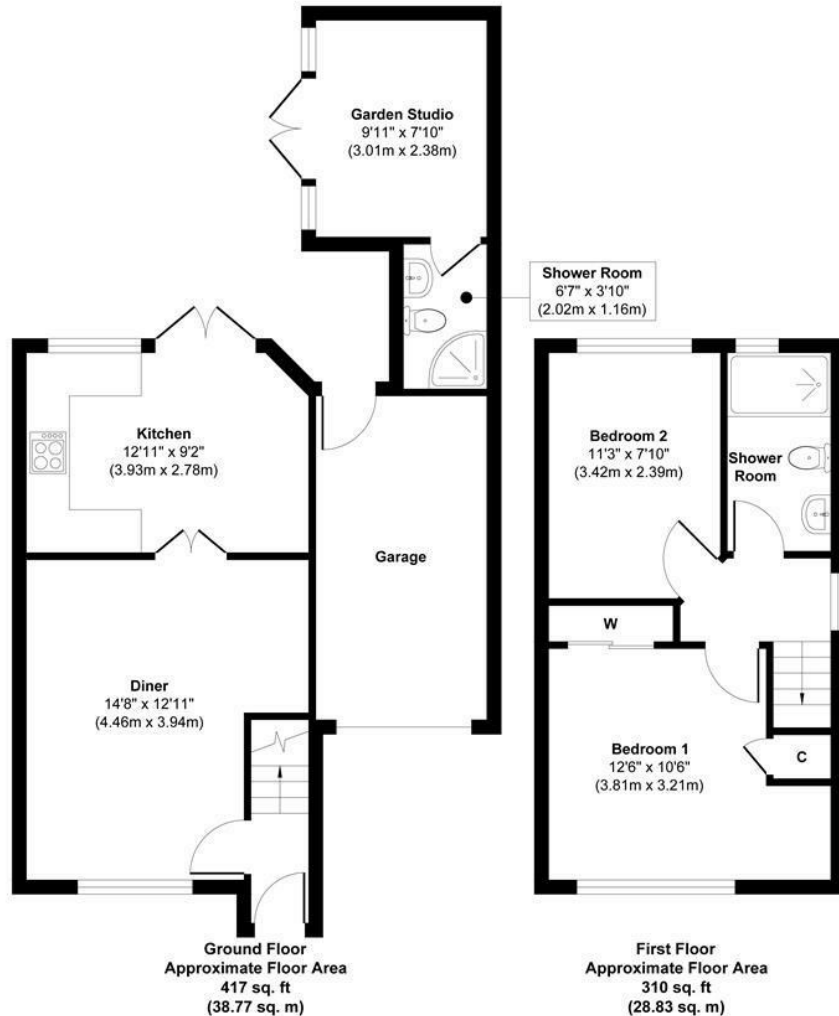

Approx. Gross Internal Floor Area 727 sq. ft / 67.60 sq. m (Excluding Garage)

Illustration for identification purpose only, measurements approximate and not to scale, unauthorized reproduction is prohibited. All rights reserved for Alexander Hudson Estates





Alexander Hudson Estates
The Printworks
20 Arrow Close
NE12 6QN

0191 268 7433
sales@alexanderhudson.co.uk